

Carbost Church, Carbostmore, Carbost, Isle of Skye, IV47 8ST
Offers Over £85,000

Carbost Church, Carbostmore, Carbost, Isle of Skye, IV47 8ST

This picturesque, white-washed stone church is situated overlooking Loch Harport in the crofting township of Carbostmore on the Minginish peninsula.

- Former Church
- Stunning Loch and Mountain Views
- Close to Village

Services

Mains Electric.

Tenure

Freehold

Council tax

Band Not Specified

Property Description

This picturesque, white-washed stone church is situated overlooking Loch Harport in the crofting township of Carbostmore, on the Minginish peninsula. The church building was built circa 1854 by the people of the Carbost community and lies on the seaward side of the Carbost/Drynoch public road (B8009) and is in close proximity to the iconic Cuillin Mountains and the beaches at Talisker and Glenbrittle. Carbost village, which has a primary school, the famous Talisker distillery, village shop, and a medical surgery, is under a mile away. Portree, the administrative and commercial centre of Skye, is 20 miles away, and is served by a regular bus service (Mon-Fri) from Carbost.

The subject property is a traditional whitewashed stone church building under a natural slate roof, situated within a land area of approximately 0.091 acres (0.037 hectares), or thereby (to be confirmed by title deed). It is enclosed by a boundary wall on the southeast and southwest sides, with the title undefined boundary extending 6 feet from the northeast gable. The western boundary is formed by the bank of Langal Burn. The former carpark adjacent to the church property is situated on the neighbouring croft and does not form part of the subjects of sale.

The accommodation features a small entrance porch and vestry within a side extension. The main sanctuary measures 12.0m x 5.70m (39ft 6" x 19ft) with a high-level coombed ceiling. The floor to ceiling height measures 4.80m (16ft). It has single glazed windows with secondary inner glazing and a timber floor with plasterboard lining on the walls and ceiling.

A wayleave, for taking a route for a new water supply from the public mains supply, situated on the south side of the public road, is pending approval by Scottish Ministers being landlords. It is the sole responsibility of any prospective purchaser to ensure that all rights will be granted by the local



Entrance Vestibule (5' 6.93" x 3' 9.28") or (1.70m x 1.15m)

Entry via timber door. Access provided to vestry and main sanctuary.

Office (8' 9.91" x 7' 5.76") or (2.69m x 2.28m)

Vestry / office accessed from entrance vestibule. Timber floor. Painted.

Main Hall (39' 4.44" x 18' 8.41") or (12.00m x 5.70m)

Main Sanctuary with single pane, arched windows to front and side. Door leading to/from entrance vestibule. Pulpit and pews still in place. Timber and carpeted floor. Painted.

Ground Floor

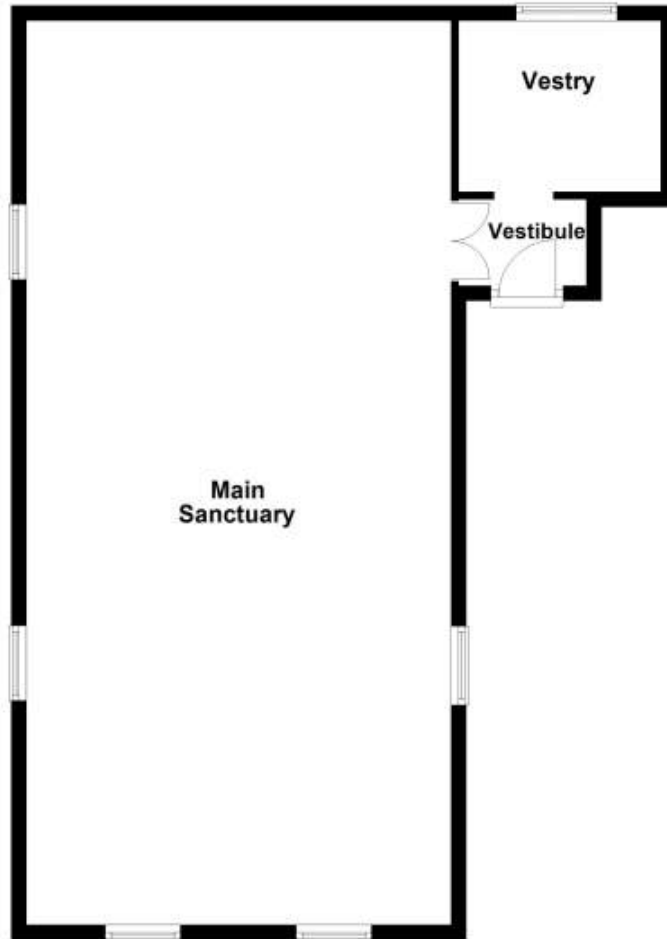

Energy Efficiency Rating		
	Current	Potential
Very energy efficient - lower running costs		
(92+) A		
(81-91) B		
(69-80) C		
(55-68) D		
(39-54) E		
(21-38) F		
(1-20) G		
Not energy efficient - higher running costs		
England, Scotland & Wales	EU Directive 2002/91/EC	

The energy efficiency rating is a measure of the overall efficiency of a home. The higher the rating the more energy efficient the home is and the lower the fuel bills will be.