



Pico House Pico House, London, SW11 8BG

£5,500 Per Month



A rare opportunity to rent in the iconic Pico House, a Grade II listed building that combines historic character with contemporary luxury. This spacious apartment offers over 1,000 sq ft of well-designed living space, including an integrated kitchen, a modern bathroom, and a private en-suite. The two generous double bedrooms feature fitted wardrobes for excellent built-in storage.

Residents of Pico House benefit from an outstanding range of five-star amenities, including a 24-hour concierge, swimming pool, cinema screening room, fully equipped gym, games room, and private dining room. These facilities make Pico House one of the area's most desirable rental addresses.

Perfectly positioned for commuting, the property is located a short distance from the nearest Underground station and the Thames Clipper, providing fast and convenient transport connections across London and the City. This sought-after location offers both lifestyle and accessibility in one.

- 24-Hour Concierge
- Modern Design
- Sauna & Steam Rooms
- Fully Equipped Gymnasium
- Shopping & Amenities
- 1000 Sq Ft Living Space
- Sky Lounge
- Cinema Screening Room
- Close to Tube & Thames Clipper
- Roof Garden





Pico House
 Approx. Total Internal Area 948 Sq Ft - 88.07 Sq M
 (including Winter Garden)
 Approx. Gross Internal Area Of Winter Garden 76 Sq Ft - 7.06 Sq M

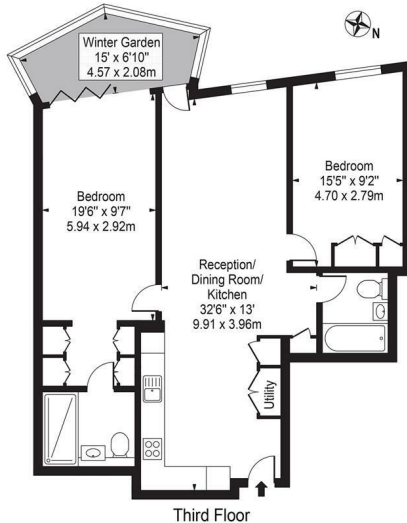

Third Floor
 For Illustration Purposes Only - Not To Scale
 This floor plan should be used as a general outline for guidance only and does not constitute in whole or in part an offer or contract.
 Any intending purchaser or lessee should satisfy themselves by inspection, searches, enquiries and full survey as to the correctness of each statement.
 Any areas, measurements or distances quoted are approximate and should not be used to value a property or be the basis of any sale or let.

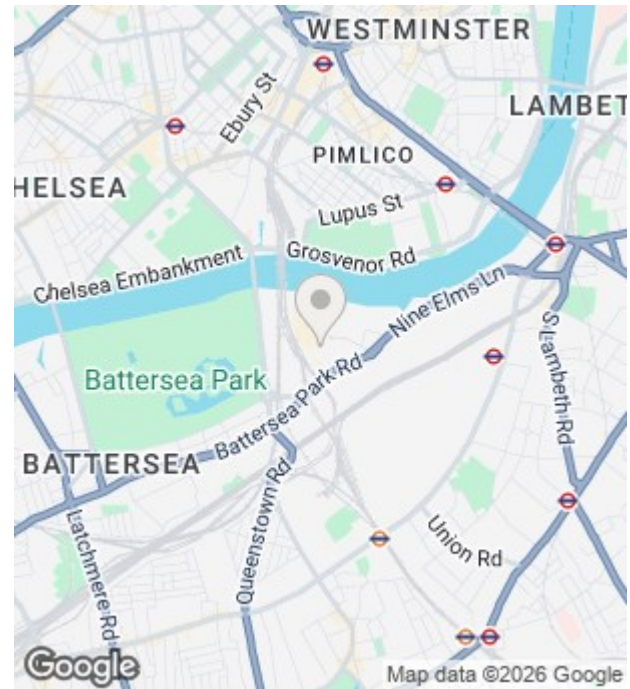

Energy Efficiency Rating		
	Current	Potential
Very energy efficient - lower running costs		
(92 plus) A		
(81-91) B		
(69-80) C		
(55-68) D		
(39-54) E		
(21-38) F		
(1-20) G		
Not energy efficient - higher running costs		
England & Wales	EU Directive 2002/91/EC	

Environmental Impact (CO ₂) Rating		
	Current	Potential
Very environmentally friendly - lower CO ₂ emissions		
(92 plus) A		
(81-91) B		
(69-80) C		
(55-68) D		
(39-54) E		
(21-38) F		
(1-20) G		
Not environmentally friendly - higher CO ₂ emissions		
England & Wales	EU Directive 2002/91/EC	

Unit 10 Paddington Works 8 Hermitage Street, London, W2 1BE
 Tel: +44(O)20 3019 6151 Email: lettings@grange.london