



**41 ROEBUCK ROAD  
CHESSINGTON  
KT9 1JY  
OFFERS IN EXCESS OF  
£425,000**

**EXTENDED END TERRACE HOUSE**

**TWO BEDROOMS**

**20'6 X 15'6 (MAX) LIVING ROOM**

**15'6 X 9'1 KITCHEN DINING ROOM**

**DOUBLE GLAZED WINDOWS**

**GAS CENTRAL HEATING**

**138' REAR GARDEN**

**OFF STREET PARKING AND GARAGE TO THE REAR**

**WELL PRESENTED**

**NO FORWARD CHAIN**

Ground Floor  
42.7 sq.m. (459 sq.ft.) approx.

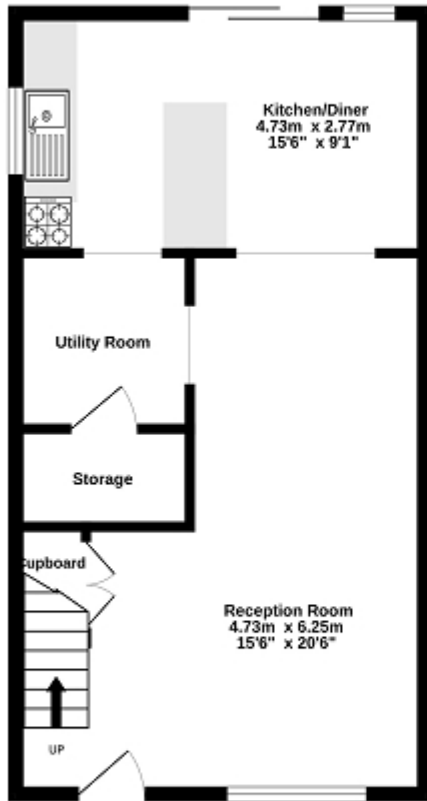

1st Floor  
29.6 sq.m. (318 sq.ft.) approx.

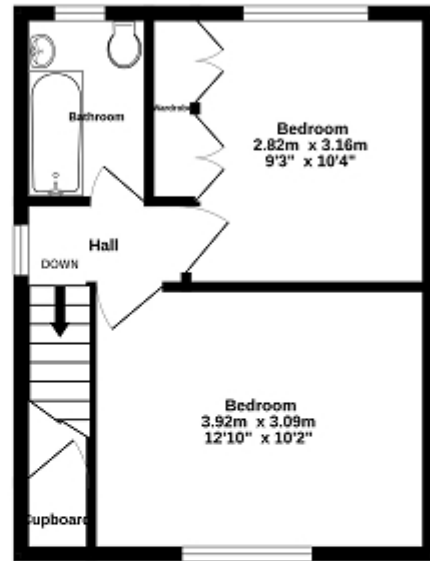

TOTAL FLOOR AREA: 72.2 sq.m. (777 sq.ft.) approx.

Whilst every attempt has been made to ensure the accuracy of the floorplan contained here, measurements of doors, windows, rooms and any other items are approximate and no responsibility is taken for any error, omission or mis-statement. This plan is for illustrative purposes only and should be used as such by any prospective purchaser. The services, systems and appliances shown have not been tested and no guarantee as to their operability or efficiency can be given.  
Made with Metropix ©2005

