



Connells

Honeysuckle Road
Emersons Green Bristol

Honeysuckle Road Emersons Green Bristol BS16 7LS

for sale
£375,000



Property Description

Located on Honeysuckle Road in Lyde Green, this four-bedroom mid-terrace townhouse offers well-proportioned living across three floors.

The ground floor includes a front-facing lounge, downstairs cloakroom, and a spacious kitchen/dining room with French doors opening onto the garden. The first floor features the main bedroom with en-suite and built-in storage, plus a third bedroom with Juliet balcony. The second floor provides two further bedrooms and a family bathroom. Outside, the property benefits from a low-maintenance rear garden and two allocated parking spaces.

Situated in the popular Lyde Green development, the home is close to local schools, shops, and commuter links, making it an excellent choice for families or professionals.

Call Connells today to arrange a viewing!

Entrance Hall

Door to front aspect, stairs to first floor, smooth ceiling, radiator.

Lounge

Double glazed window to front aspect, smooth ceiling, carpet flooring, radiator.

Kitchen/Dining Room

Double glazed French doors and window to rear aspect, wall and base units with worktops, induction hob with extractor over, stainless steel sink with mixer tap, space for washing machine, dishwasher and fridge/freezer, under stairs storage, radiator.

Downstairs Cloakroom

WC, Wash hand basin, smooth ceilings wood effect flooring and a radiator.

Landing

Smooth ceiling, storage cupboard and a radiator.

Bedroom One

14' 7" x 9' 4" (4.45m x 2.84m)

Two double glazed windows to rear aspect, built-in storage cupboard, partially wallpapered, smooth ceiling, carpet flooring, radiator.

En-Suite

4' 3" x 7' 4" (1.30m x 2.24m)

Shower cubicle with sliding glass door, WC, wash hand basin with mixer tap, vinyl flooring, radiator.

Bedroom Three

14' 7" x 9' 1" (4.45m x 2.77m)

Double glazed French doors with Juliet balcony and separate window to front aspect, smooth ceiling, carpet flooring, radiator.

Second Floor Landing

Smooth ceiling, partially wallpapered, storage cupboard and a radiator.

Bedroom Two

14' 7" x 10' 1" (4.45m x 3.07m)

Double glazed windows to front aspect, built-in wardrobe, smooth ceiling, carpet flooring, radiator.

Bedroom Four

14' 7" x 8' 3" max (4.45m x 2.51m max)

Double glazed windows to rear aspect, built-in wardrobe, smooth ceiling, partially wallpapered, carpet flooring, radiator.

Family Bathroom

5' 6" x 6' 2" (1.68m x 1.88m)

Panelled bath, WC, wash hand basin with mixer tap, vinyl flooring, part tiled walls, radiator.

Outside

Outside Front – Stone-fronted townhouse with pathway to entrance with shrubs.

Outside Rear – Enclosed Garden with patio, artificial lawn, planted borders, shed and gated rear access.

The property comes with two allocated parking spaces.







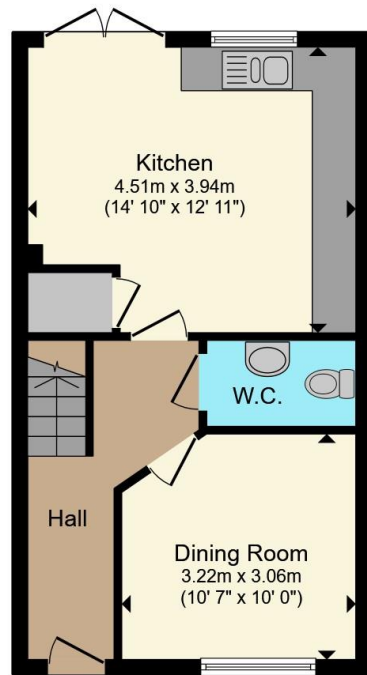

Ground Floor

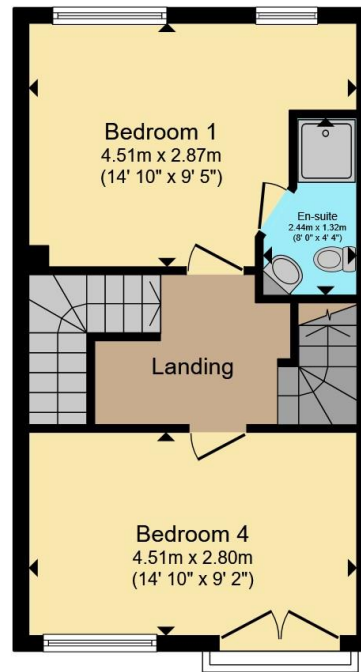

First Floor

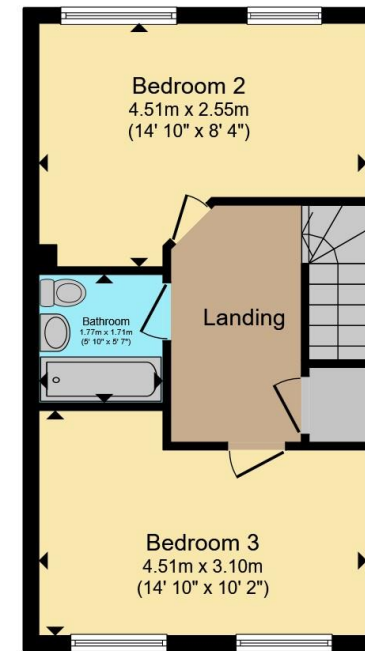

Second Floor

Total floor area 114.0 m² (1,227 sq.ft.) approx

This floor plan is for illustrative purposes only. It is not drawn to scale. Any measurements, floor areas (including any total floor area), openings and orientation are approximate. No details are guaranteed, they cannot be relied upon for any purpose and they do not form part of any agreement. No liability is taken for any error, omission or misstatement. A party must rely upon its own inspection(s). Powered by www.propertybox.io

Connells

To view this property please contact Connells on

T 0117 956 9555
E emersonsgreen@connells.co.uk

2 The Village Emerson Way Emersons Green
BRISTOL BS16 7AE

EPC Rating: B Council Tax
Band: D

Tenure: Freehold

view this property online connells.co.uk/Property/EME306905



1. MONEY LAUNDERING REGULATIONS Intending purchasers will be asked to produce identification documentation at a later stage and we would ask for your co-operation in order that there will be no delay in agreeing the sale. 2. These particulars do not constitute part or all of an offer or contract. 3. The measurements indicated are supplied for guidance only and as such must be considered incorrect. Potential buyers are advised to recheck measurements before committing to any expense. 4. We have not tested any apparatus, equipment, fixtures, fittings or services and it is in the buyers interest to check the working condition of any appliances.

Connells Residential is registered in England and Wales under company number 1489613, Registered Office is Cumbria House, 16-20 Hockliffe Street, Leighton Buzzard, Bedfordshire, LU7 1GN. VAT Registration Number is 500 2481 05.

See all our properties at www.connells.co.uk | www.rightmove.co.uk | www.zoopla.co.uk

Property Ref: EME306905 - 0004