



Hurdle Drove, Bury St. Edmunds, IP28 8RG
Rent - £1,150 PCM Deposit - £1,326

Detached Three Bedroom Bungalow located in a rural position. Only 10 minutes from RAF Mildenhall. Benefitting from spacious living space, three good size bedrooms, oil central heating, large garden and off road parking.

- DETACHED BUNGALOW
- THREE BEDROOMS
- SPACIOUS LIVING ROOM
- SHOWER ROOM
- OFF ROAD PARKING
- CLOSE TO RAF BASE
- OIL HEATING & ENERGY RATING E
- APPROXIMATE SIZE - 1024 SQFT
- COUNCIL TAX BAND - C
- AVAILABLE MID JULY



Council Tax Band: C - EPC Rating: E 44

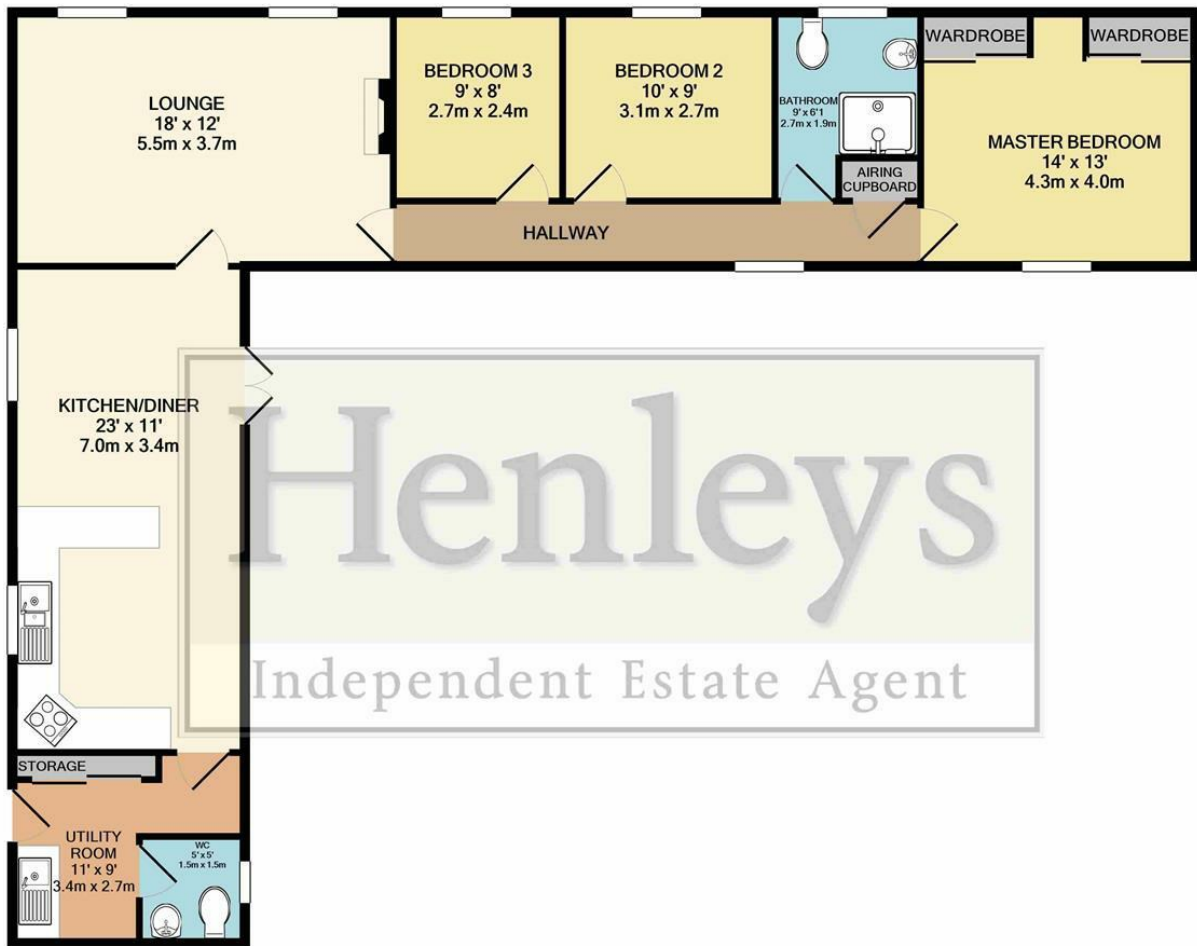

TOTAL APPROX. FLOOR AREA 1024 SQ.FT. (95.1 SQ.M.)

Whilst every attempt has been made to ensure the accuracy of the floor plan contained here, measurements of doors, windows, rooms and any other items are approximate and no responsibility is taken for any error, omission, or mis-statement. This plan is for illustrative purposes only and should be used as such by any prospective purchaser. The services, systems and appliances shown have not been tested and no guarantee as to their operability or efficiency can be given
 Made with Metropix ©2019

