



63 Rotherham Road | Dinnington | Sheffield | S25 3RG

Guide Price £110,000 to £115,000

Bell & Co Estates are pleased to present this modern two-bedroom mid terraced property in the popular area of Dinnington, offered with no vendor chain. Ideally suited to couples, small families or professional tenants, this lovely home provides spacious accommodation in a convenient location close to local amenities, schools and transport links. This property offers a bright and welcoming feel from the moment you step inside. To the ground floor is a modern fitted kitchen complete with integrated appliances, with ample cupboard and worktop space, alongside a separate spacious dining room perfect for family meals or entertaining guests. The front facing living room provides a comfortable and cosy space to relax, with modern laminate flooring flowing throughout the ground floor creating a clean and contemporary finish. To the first floor are two bedrooms comprising of a generous double bedroom and a further good sized double bedroom ideal for a child's room, guest space or home office. Completing the upstairs accommodation is the modern family bathroom fitted with a shower over bath, wash basin and WC. Fully fitted with storage cupboard. Externally, the property benefits from enclosed gardens to both the front and rear, offering low maintenance outdoor space, while off street parking is available directly to the rear with detached garage. Positioned within easy reach of shops, schools and commuter links, this beautifully refreshed home is ready to move straight into. Early viewing is highly recommended, call Bell & Co Estates now.



GROUND FLOOR
390 sq ft. (36.2 sq m.) approx.

1ST FLOOR
390 sq ft. (36.2 sq m.) approx.

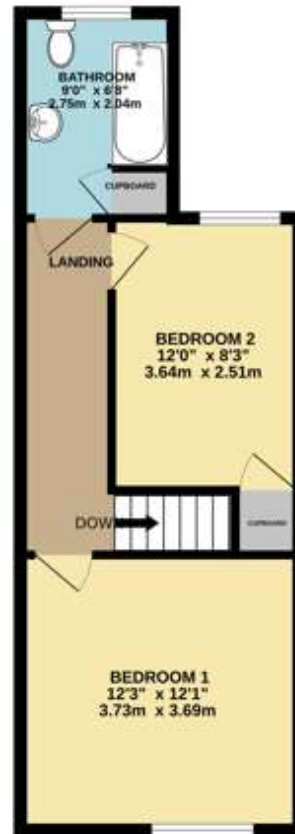
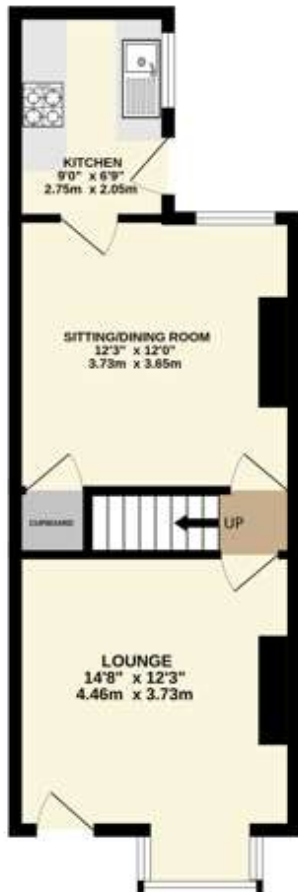

Contact Details

79 Wales Road
Kiveton Park
Sheffield
South Yorkshire
S26 6RA

www.bellcoestates.com
info@bellcoestates.com
03333 580590

63 Rotherham Road
Dinnington
SHEFFIELD
S25 3RG

Energy rating

D

Valid until

2 October 2032

Certificate number

7704-1005-1201-9602-2200

Property type

Mid-terrace house

Total floor area

77 square metres

Agents Note: Whilst every care has been taken to prepare these sales particulars, they are for guidance purposes only. All measurements are approximate and for general guidance purposes only and whilst every care has been taken to ensure their accuracy, they should not be relied upon and potential buyers are advised to recheck the measurements