



Flat 3, 40 Osborne Road, Portsmouth, PO5 3LT

£650 PCM Council Tax Band A Deposit £750



Tully's

Floor Plan

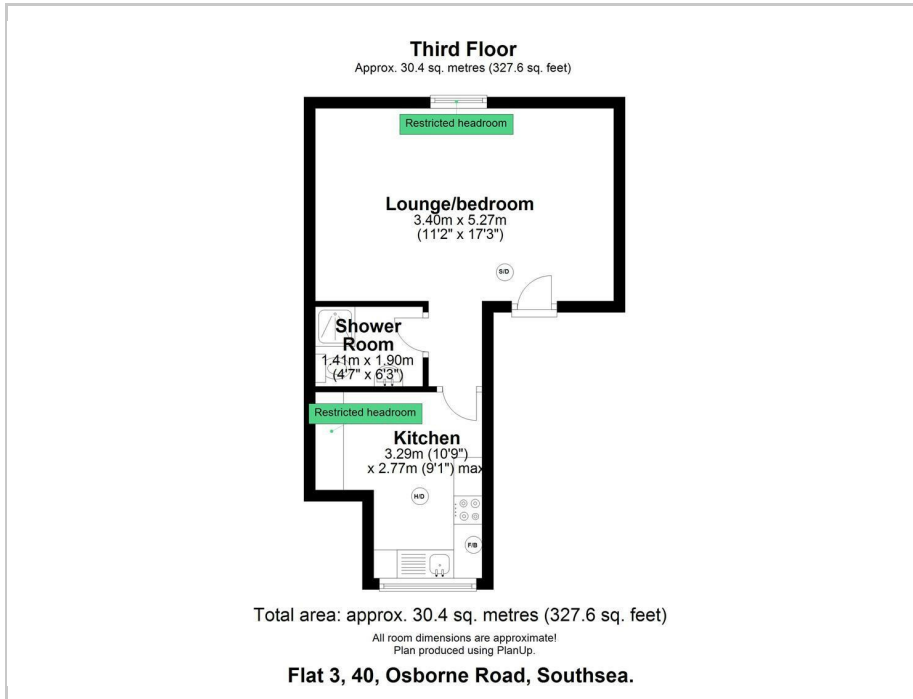

Area Map

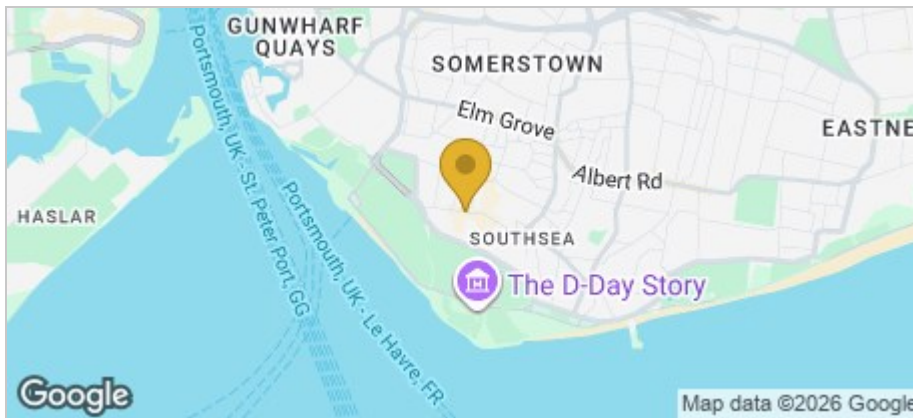

Accommodation

- H/Deposit - £150.00
- Deposit - £750.00
- Studio Apartment
- 1 Bathroom
- Close to the seafront
- Close to local shops, bars and restaurants
- Third floor
- Available to move into now

Viewing

Please contact our Southsea Office on 023 9273 2241 if you wish to arrange a viewing appointment for this property or require further information.

Energy Efficiency Graph

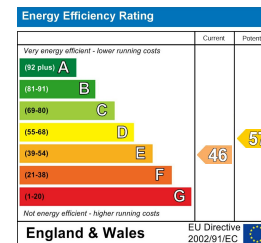

157-159 Albert Road, Southsea, Portsmouth, Hampshire, PO4 0JW
023 9273 2241 Email: tully@tullyand.co lettings@tullyand.co

Tully's