



GARDEN



100



EASTAIR SAVILLE
ESTATE AGENTS

Whitewood Park, Fazakerley

Fixed Price £350,000

 4  2  2

- Four Bedroom Detached Property
- Two Reception Rooms
- Four Generously Proportioned Bedrooms
- Low Maintenance Large Garden
- Freehold
- Immaculately Presented Throughout
- Contemporary Kitchen Diner
- Ensuite
- Driveway With Parking For Several Cars
- EPC Rating - C, Council Tax Band - D



A BEAUTIFULLY PRESENTED FOUR BEDROOM DETACHED PROPERTY, CONVENIENTLY LOCATED IN FAZAKERLEY, OFFERING MODERN LIVING SPACES, TWO RECEPTION ROOMS, A LARGE, EASY MAINTENANCE GARDEN, AND OFF ROAD PARKING FOR SEVERAL CARS. THIS HOME IS IDEAL FOR COMFORTABLE FAMILY LIFE, WITH EASY ACCESS TO LOCAL AMENITIES.



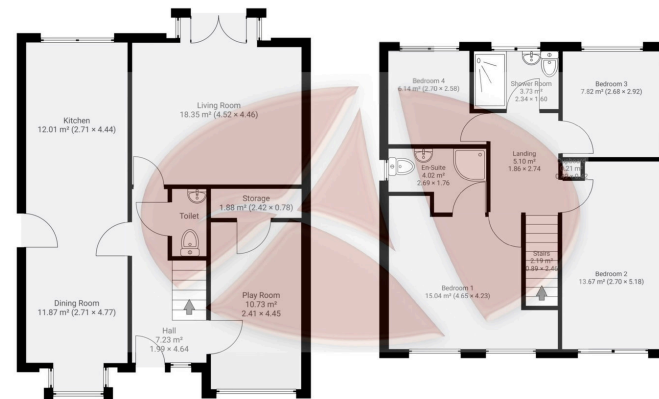

Ground Floor area 63.68m2

1st Floor area 57.86m2

99 Whitewood Park, L9 7LF

Whilst every effort is made to accurately reproduce these floor plans, measurements are approximate, not to scale and for illustrative purposes only. Measurements, floor-areas, openings and orientations are approximate. They should be used as a guide only and do not form any part of an agreement. No liability is taken for any error or mis-statement. All parties must rely on their own inspections.

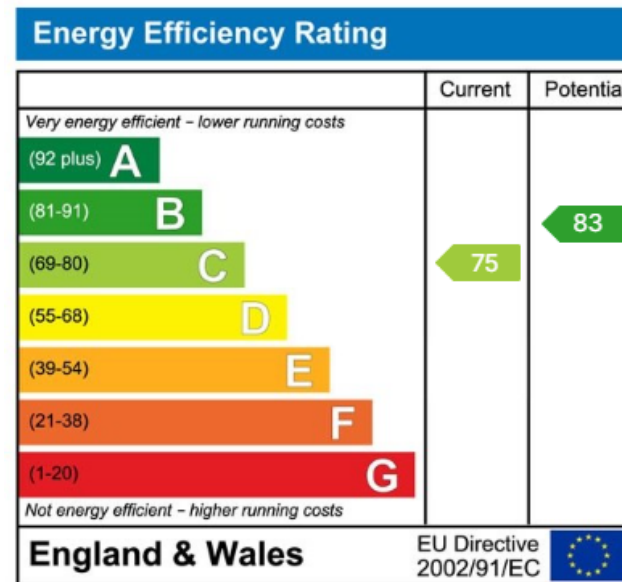

Alastair Saville Estate Agents
 25 Central Square • Maghull • Liverpool • L31 0AE
 138 Ormskirk Road • Old Roan • Liverpool • L10 3JG
 Tel: 0151 520 0001 • Website: www.alastairsaville.com
 Email: sales@alastairsaville.com • lettings@alastairsaville.com

