



Guide Price
£325,000

Freehold

4x  1x  2x 

**Victoria Road, Sandown,
Isle of Wight, PO36**

OVER 60?

Secure this property
for up to **59% less!**

Pittis 
Helping you move forwards

Ground Floor

Approx. 92.1 sq. metres (991.1 sq. feet)

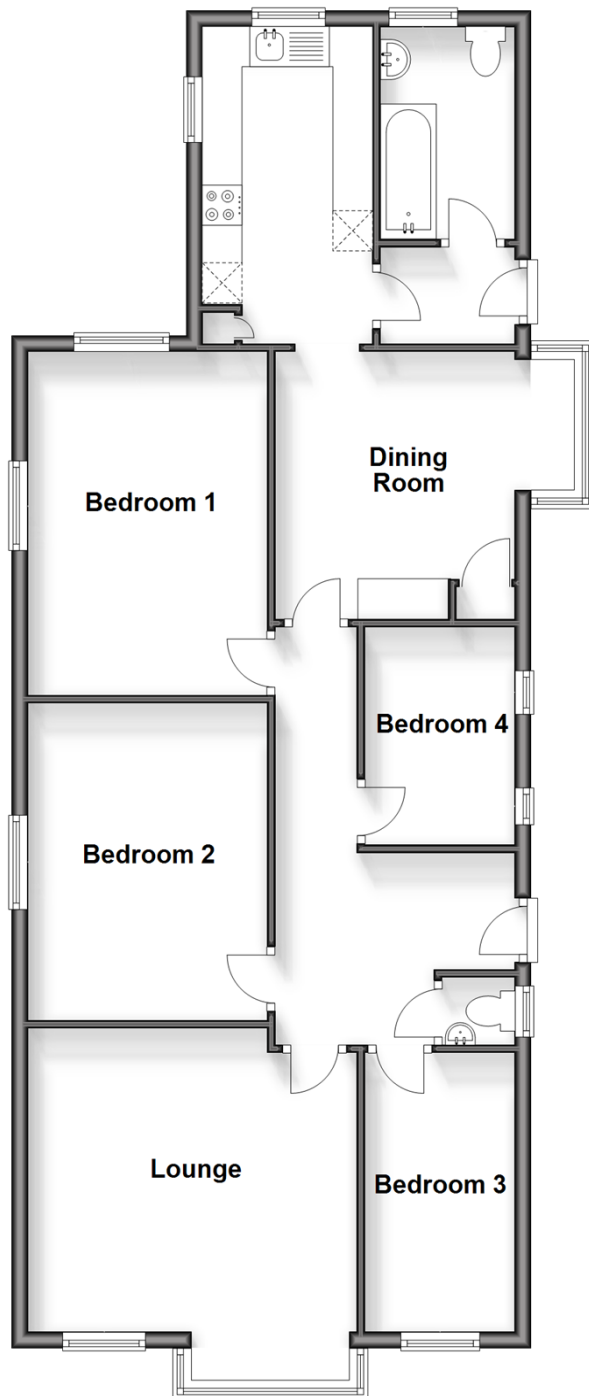

Accommodation

GROUND FLOOR

Hallway

Lounge: 13'7 x 12'5 up to bay (4.14m x 3.79m)

Cloakroom

Bedroom 1: 14'1 x 9'10 (4.30m x 3.00m)

Bedroom 2: 13'0 x 9'10 (3.97m x 3.00m)

Bedroom 3: 11'5 x 6'1 (3.48m x 1.86m)

Bedroom 4: 8'11 x 6'6 (2.72m x 1.98m)

Dining Room: 9'11 x 9'8 up to bay (3.02m x 2.95m)

Kitchen: 13'0 x 6'11 (3.97m x 2.11m)

OUTSIDE

Front & Rear Garden

Driveway Parking



Main features

- Substantial detached bungalow with lots of character
- Driveway with parking and large rear garden
- Presented beautifully throughout
- Plenty of rooms with various different options for living arrangements
- Located in a secluded spot however within close walking distance to Sandown Town Centre and the local beach



Nearest Schools

The Bay CE School
Shanklin C of E Primary Schools
Gatten & Lake Primary School
Shanklin Pre-School & Nursery
Brading CE Primary School



Transport Information

Local buses providing Island wide connections plus local train station with direct links to Ryde Pier Head.



Address

Victoria Road, Sandown, Isle of Wight, PO36



Directions

For directions to this property please contact us.



Pittis
Helping you move forwards

Call Sandown Branch 01983 407444 ■ pittis.co.uk



■ Through a Homewise Home For Life Plan people aged 60+ can secure this property for up to 59% less, by purchasing a Lifetime Lease



60521004/20260506/JW/NR