



HIVE



BROOK HOUSE
48 SANDFORD
RINGWOOD
BH24 3BU



HIVE

“
Agent's introduction

Exceptional semi-rural character home in Sandford, near Ringwood, featuring four bedrooms, two ensuite, four reception rooms, a self-contained annexe, stunning garden room with roof terrace, mature gardens and far-reaching countryside views. All offered with no onward chain. Viewings highly recommended.





HIVE





HIVE

Property highlights

- Exclusive semi-rural setting surrounded by open farmland and paddock views
- Private approach via a charming bridge over a brook and secure electric gates
- Luxurious principal suite with fitted wardrobes, en suite and Juliet balcony
- Breath-taking countryside views from multiple rooms and outdoor spaces
- Feature dual-sided fireplace with log burner serving the main living areas
- Character kitchen with central island, Butler sink and range-style cooker
- Exceptional entertaining garden room with bi-fold doors and indoor barbecue
- Spectacular roof terrace overlooking the established gardens and countryside
- Self-contained one-bedroom annexe ideal for guests or multi-generational living
- Extensive grounds and amenities, including a double car port, home gym and ample parking

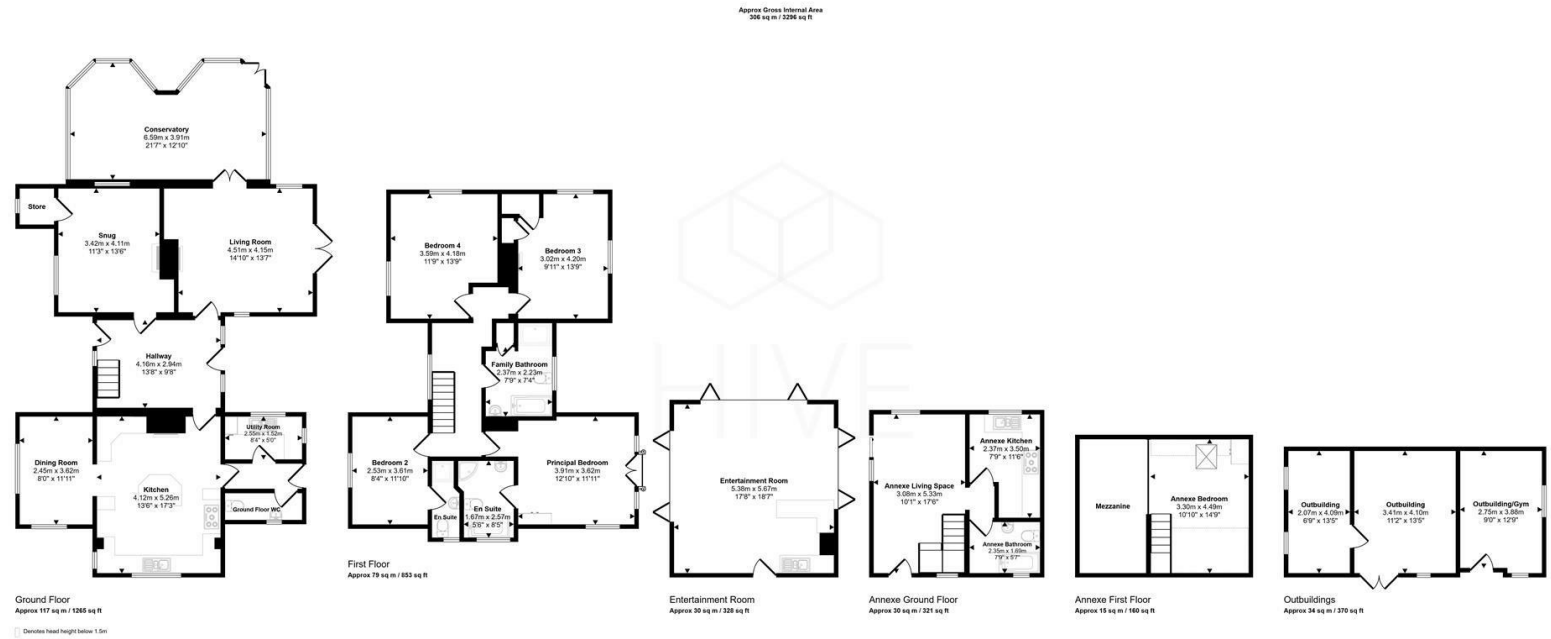

Floor plan and EPC



This floorplan is only for illustrative purposes and is not to scale. Measurements of rooms, doors, windows, and any items are approximate and no responsibility is taken for any error, omission or mis-statement. Items of items such as bathroom suites are representations only and may not look like the real items. Made with Mass Energy 360.

Energy Efficiency Rating

	Current	Potential
<i>Very energy efficient - lower running costs</i>		
(92 plus) A		
(81-91) B		
(69-80) C		
(55-68) D		
(39-54) E		
(21-38) F		
(1-20) G		
<i>Not energy efficient - higher running costs</i>		
England & Wales	EU Directive 2002/91/EC	



HIVE



HIVE & Partners Unit F1, Arena Business Centre 9 Nimrod Way, Ferndown, BH21 7UH
01202 122 002 | www.hiveandpartners.co.uk | sales@hiveandpartners.co.uk