



Our View “Offered with no onward chain”

A well presented and spacious detached coach house with open plan living, Two double bedrooms, enclosed private garden and garage with off road parking for two cars, located on the edge of a popular development in Dawlish

This accommodation begins with a welcoming entrance porch and staircase leading to the main living area. The spacious living room features a double-glazed window to the front, a convenient storage cupboard, and an open-plan layout flowing into the kitchen. Kitchen The kitchen is well-equipped with a range of matching base-level units, roll-top work surfaces, and a stainless steel sink with drainer. It includes a built-in fridge-freezer, oven with gas hob, and an extractor hood with integrated lighting. A double-glazed rear window offers a pleasant open

outlook, complemented by spotlights for a bright and modern feel. Bedrooms & Bathroom

From the living room, a door leads to an inner hallway providing access to two double bedrooms, both with double-glazed windows. The rear bedroom enjoys scenic views and the main bedroom features built-in wardrobes. Adjacent to the bedrooms is a modern fitted bathroom suite comprising a low-level flush WC, pedestal wash hand basin, and panel bath. The bathroom is finished with part-tiled walls, tiled flooring, spotlights, and an obscured double-glazed rear window. Exterior Externally, the property boasts an enclosed rear garden with gated side access. Additional benefits include two parking spaces at front of a garage, which features a metal up-and-over door and space / plumbing for washing machine and tumble dryer, a side door leading to the garden.

- Detached coach house
- Spacious living room
- Modern kitchen and bathroom
- Two double bedrooms
- Enclosed gardens
- Off road parking for two cars
- Garage
- NO CHAIN



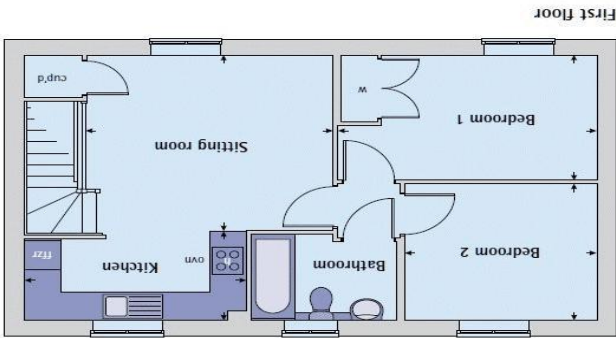
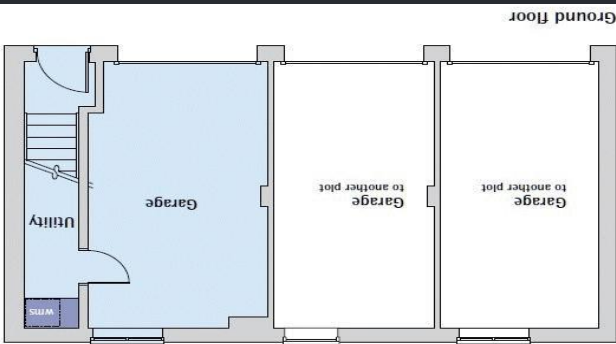

	metres	feet/inches
First floor		
Kitchen	3.66 x 1.85	12' 0" x 6' 1"
Sitting/dining room	4.07 x 3.67	13' 4" x 12' 0"
Bedroom 1	4.27 x 2.60	14' 0" x 8' 6"
Bedroom 2	3.17 x 2.84	10' 5" x 9' 4"

