



119, Club Garden Road, Sheffield, S11 8BW

119, Club Garden Road

Sheffield, S11 8BW

Description

A larger than average five double bedroom terraced property that offers accommodation over three floors. This property is let as a five bed HMO at present, Returning £24'440 per annum. The location is popular, close to excellent local amenities on London Road, good transport links and within an easy walk of the city centre.

- Five double bedrooms.
- Two bath/shower rooms.
- Modern offshot kitchen.
- Dining room/lounge area.
- No onward chain but let until June 2026.
- Perfect for both owner occupiers and investors/landlords.
- Gas central heating and UPVC double glazing combining to produce an EPC rating of D55.
- Popular location, close to excellent local shops, transport links etc...
- Freehold, Council Tax Band A.
- Currently let as a 5 bed HMO until June 2026, returning £24'440 per annum.





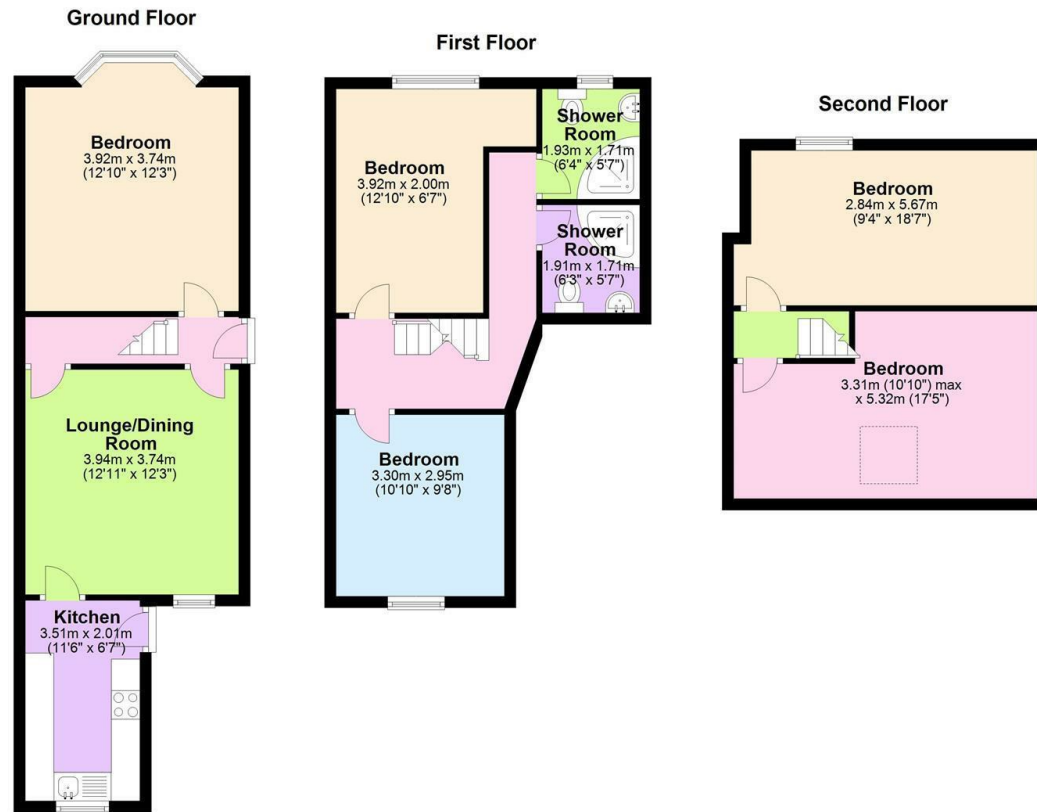

Bakewell
 3 Royal Oak Place
 Matlock Street
 Bakewell DE45 1HD
 T: 01629 700699
 E: bakewell@elr.co.uk

Banner Cross
 888 Ecclesall Road
 Banner Cross
 Sheffield S11 8TP
 T: 01142 683388
 E: bannercross@elr.co.uk

Dore
 33 Townhead Road
 Sheffield
 S17 3GD
 T: 0114 2362420
 E: dore@elr.co.uk

Hathersage
 Main Road, Hathersage
 Hope Valley
 Derbyshire S32 1BB
 T: 01433 651888
 E: peakdistrict@elr.co.uk

Rotherham
 149 Bawtry Road
 Wickersley
 Rotherham S66 2BW
 T: 01709 917676
 E: wickersley@elr.co.uk

