



## Blackburne Road, Birmingham, B28 0JD

Offers Over £300,000

 3  1  2



### Three Bedroom Renovation Opportunity in Popular Hall Green Location

**Shirley Office:**  
Black and Golds Estate Agents  
117 Stratford Road, Shirley, Solihull, B90 3ND

**Wythall Office:**  
Black and Golds Mortgages  
The Old Bakery House, Becketts Farm, Alcester Road, Wythall, B47 6AJ

Black and Golds Letting Agents Limited, Company Registration Number: 10398551. Black and Golds Estate Agents, Company Registration Number: 07939019. Registered Office: 117 Stratford Road, Solihull B90 3ND.  
© 2023 Black and Golds Letting Agents Limited, Company Registration Number: 10398551. Black and Golds Estate Agents Copyright. All rights reserved. No content can be reproduced without our prior written consent.  
While we as Estate Agents on behalf of the vendors endeavour to ensure the accuracy of property details produced and displayed, we have not tested any apparatus, equipment, fixtures and fittings or services and we cannot verify that they are connected, to working order or fit for the purpose. Neither have we had sight of the legal documents to verify the Freehold or Leasehold status of any property. A Buyer is advised to obtain verification from their Solicitor and/or Surveyor. A Buyer must check the availability of any property and make an appointment to view before embarking on any journey to see a property. The Vendors have checked and approved these particulars. These particulars are intended to give a fair description, but their accuracy cannot be guaranteed, and are not to be taken as forming any part of a resulting contract. They are issued on the basis the property is still available and on the understanding that all regulations are conducted through the agents.

## Key Features

- Renovation opportunity
- Two reception rooms
- Family bathroom
- Great potential to modernise
- Three bedrooms
- Separate kitchen
- Bay-fronted property
- Ideal for investors or project buyers

GROUND FLOOR  
567 sq.ft. (52.7 sq.m.) approx.

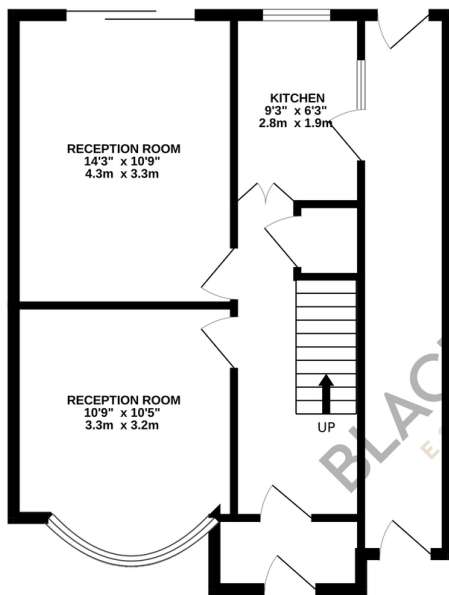

1ST FLOOR  
441 sq.ft. (41.0 sq.m.) approx.

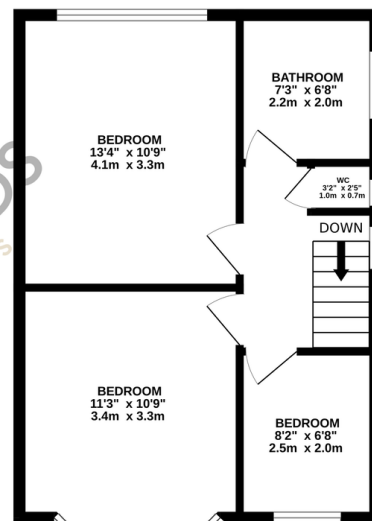

TOTAL FLOOR AREA : 1008 sq.ft. (93.7 sq.m.) approx.

Whilst every attempt has been made to ensure the accuracy of the floorplan contained here, measurements of doors, windows, rooms and any other items are approximate and no responsibility is taken for any error, omission or mis-statement. This plan is for illustrative purposes only and should be used as such by any prospective purchaser. The services, systems and appliances shown have not been tested and no guarantee as to their operability or efficiency can be given.  
Made with Metropix ©2026