



Flat 3, 111 Haslington Road
Ashway Park M22 5HT
£175,000



MAINANDMAIN.CO.UK



Flat 3, 111 Haslington Road Ashway Park M22 5HT

£175,000

Located to the first floor of a purpose-built development, this stylish apartment will appeal to a wide range of potential purchasers.

111 Haslington Road enjoys a corner position on the ever-popular Ashway Park development. The building stands behind a large area of parking space for the residents, with a gated communal garden to the rear.

A communal entrance and hallway have stairs rising to the first floor and on to the private entrance to the apartment.

An entrance hallway with deep built-in storage leads to the spacious open-plan living room which features a juliet-balcony and the room opens to a dining area. The kitchen is fitted with white coloured units.

There are two well-proportioned double bedrooms which overlook the rear of the development. The bathroom is fitted with a white suite with shower above the bath.

These properties always prove to be very popular - They are well-positioned for access to amenities and transport networks: The M56/M60 motorway network is close by, with a Metrolink tram station at the entrance to the development. Manchester International Airport is also nearby, with Wythenshawe Hospital also within easy reach.

An early internal inspection is strongly recommended.

Tenure: Leasehold
Council Tax: Manchester B

- Two Double Bedrooms
- Open-plan Living/Dining Room
- Fitted Kitchen
- Bathroom with White Suite
- First Floor Position
- Communal Gardens
- Parking
- Popular Development
- No Onward Chain
- Viewing Essential

Communal Entrance Hallway

With stairs leading to first floor and private entrance to the property.

Living/Dining Room

17'7 red to 9'5 x 13'10 red to 6'4
L-Shaped

Kitchen

7'11 x 7'3

Bedroom One

11'1 x 9'10

Bedroom Two

10'4 x 9'10 red to 8'4

Bathroom

7'10 x 5'8

Externally

Communal grounds with maintained gardens to the rear.
Parking to the front.

Leasehold Information

96 years remaining on a lease which ends on 01/01/2123.
Service Charge: £226.23 pcm (£2715.00 per annum)
Ground Rent: None





Haslington Road

Approximate Gross Internal Area
578 sq ft - 54 sq m

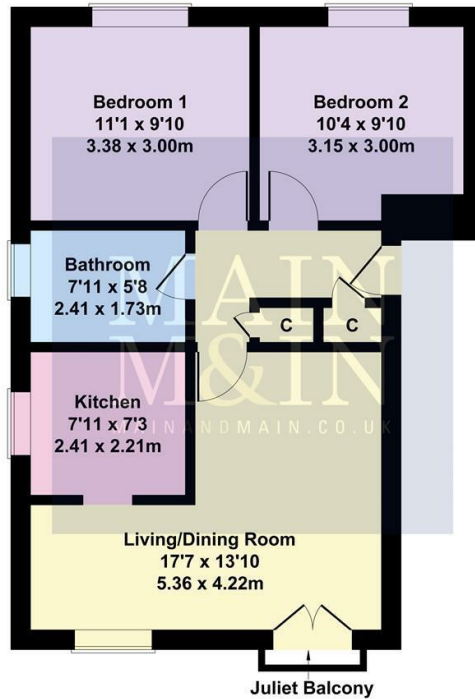

Not to Scale. Produced by The Plan Portal 2026
For Illustrative Purposes Only.



To view this property call Main & Main on 0161 437 1338

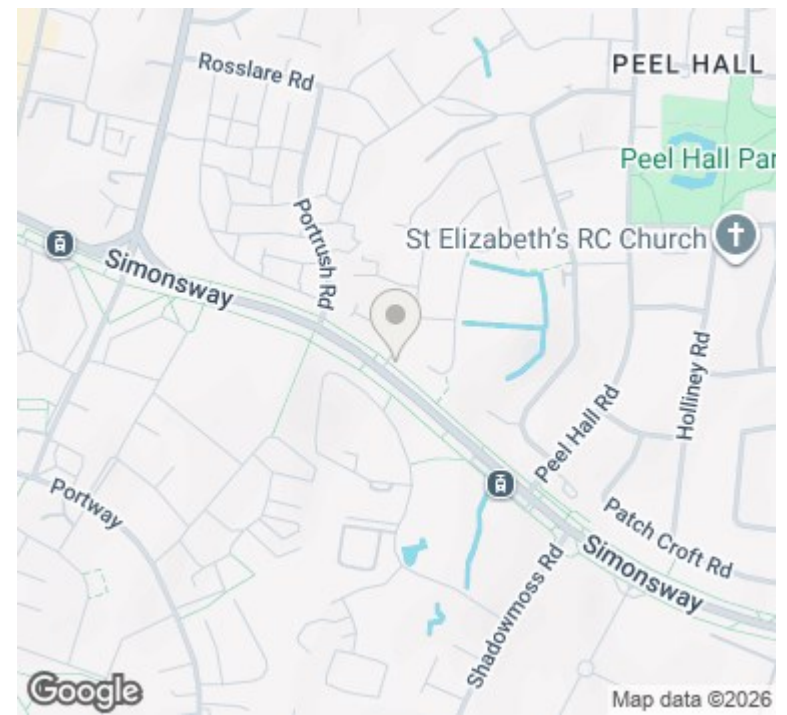

Special Note - The price is correct at the time of going to print, we advise customers to enquire the price of specific properties prior to viewing. We reserve the right to amend/improve the specification at any time. Any special offer relating is offered at the asking price stated and is subject to terms and conditions.

NB - The services, appliances and heating systems have not been tested and therefore no warranty can be given or implied as to their working order. They should therefore be verified on survey by any prospective purchaser. All measurements are approximate.

Tenure - To be confirmed with a solicitor at point of sale.

Call Monitoring System - Please note that all our calls are recorded for monitoring and training purposes.

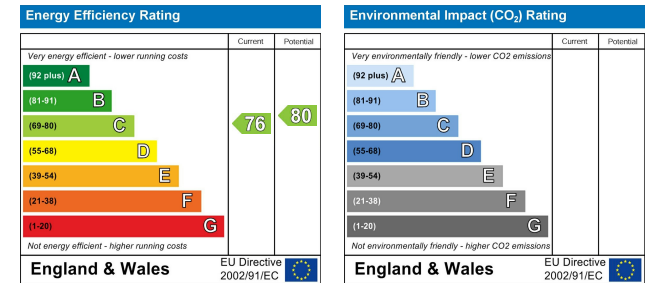

mainandmain.co.uk

Heald Green (Head Office) 198 Finney Lane ♦ Heald Green ♦ Stockport ♦ SK8 3QA ♦ Sales 0161 437 1338 ♦ Auctions ♦ 0161 437 5337

Lettings (1st Floor) 198 Finney Lane ♦ Heald Green ♦ Stockport ♦ SK8 3QA ♦ Lettings ♦ 0161 491 6666



Company Registration No. 5615498