



Sullivan Road, SW6

£1,250,000

A beautifully presented and spacious three bedroom mid-terraced family home, situated on one of Fulham's premier roads. The home benefits from approved planning permission to extend, allowing the total accommodation to exceed 2,250 sq ft.

Sullivan Road is surrounded by many local amenities within this desirable location and is nestled between the green open spaces of both South Park and Hurlingham Park. It is a short stroll to Parsons Green Tube station and close to all of the bars, shops, cafés and restaurants of both the Wandsworth Bridge Road and Parsons Green.

Features

- Three Bedrooms
- Large Private Garden
- Planning Permission In Place
- South Park
- Quiet Residential Street
- Immaculately Finished



Sullivan Road, SW6

Currently arranged over two floors and presented in immaculate condition throughout, this charming home features a substantial 45-foot private garden, making it the perfect entry-level home.

The ground floor comprises a spacious double reception room with ample space for both dining and living areas, along with a modern, fully integrated kitchen. Both rooms provide direct access to the private garden, ideal for entertaining or relaxing outdoors.

The first floor offers two well-proportioned double bedrooms, an additional study room perfect for home working and a family bathroom with a separate W.C.



Sullivan Road, London, SW6

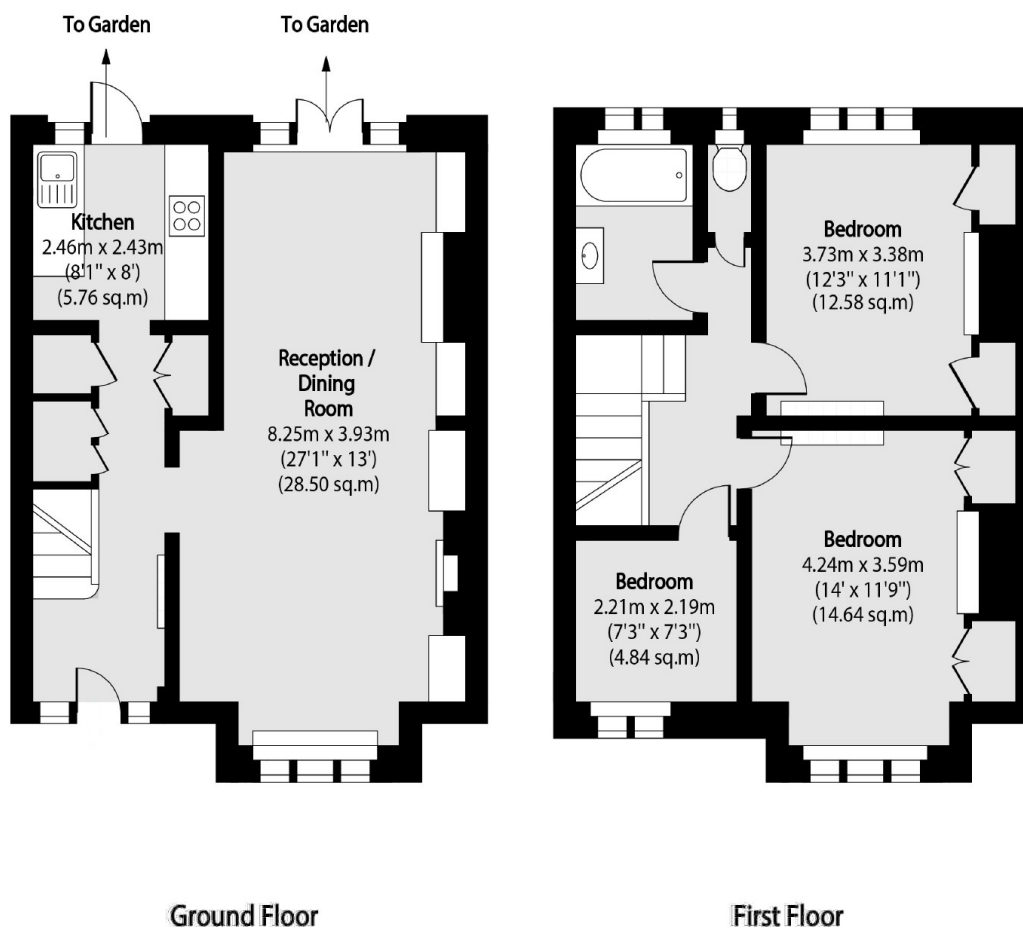

Total area (approx): 93.00 sq m (1001 sq. ft)