



St. Johns Wood Road, NW8

£875,000



• Lift access

• Secure Covered Parking Space

• Two bedrooms

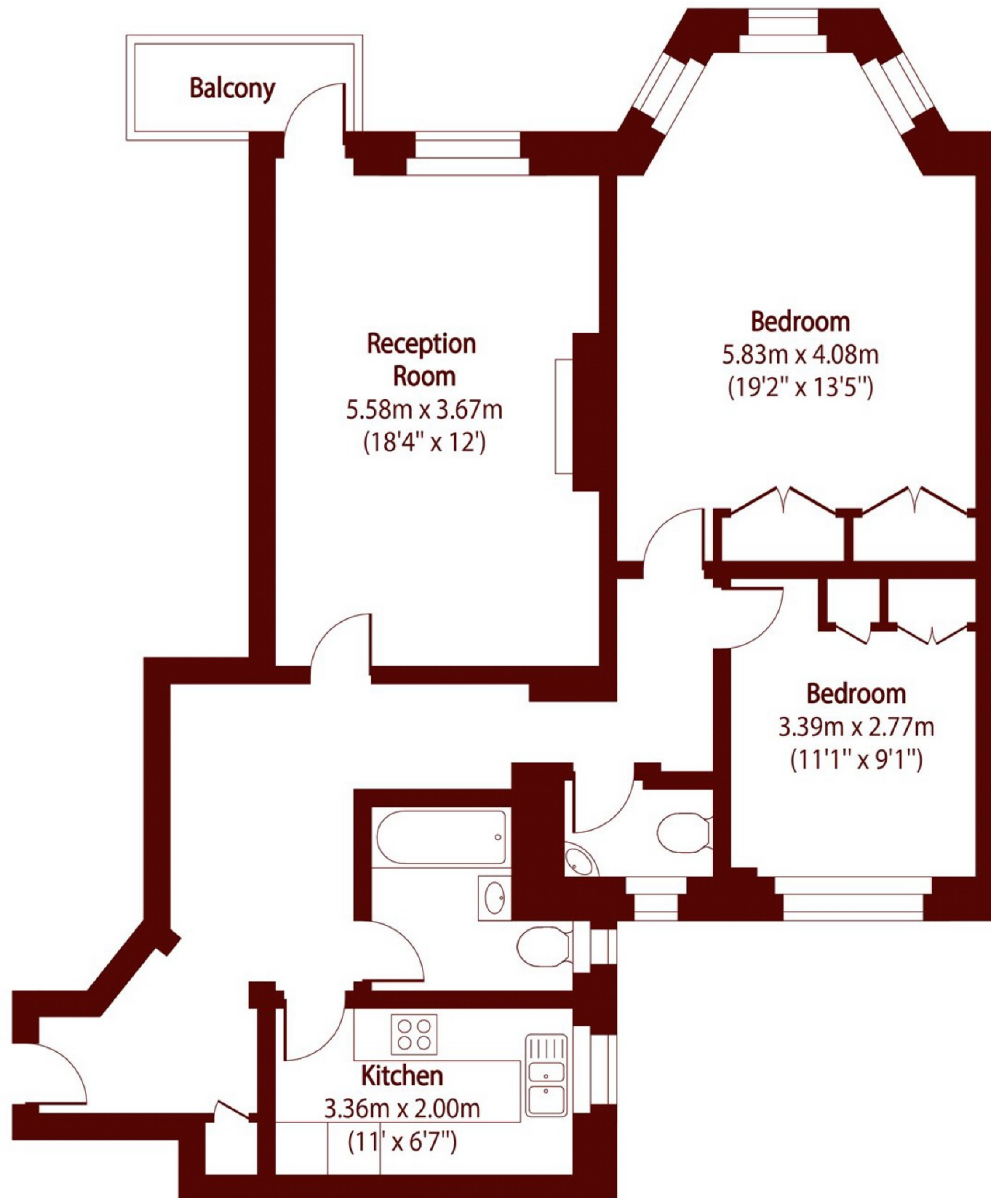

Total area (approx): 87.55 sq m (942 sq. ft)

Patio/Balcony/Terrace total area (approx): 2.50 sq m (27 sq. ft)

Marsh & Parsons Little Venice

35 Maida Vale, Maida Vale,
W9 1TP
020 7993 3050