



## Everton Drive Stanmore £1,685 Per month

Davidson Frost-Wellings are pleased to present this two-bedroom maisonette in great condition, located within a very short walk to Queensbury & Kingsbury Stations, local amenities, and shopping facilities.

The property comprises of an open reception room/dining room, fitted kitchen, a large master bedroom and good sized second bedroom. Completing the floor is a modern family bathroom. The property benefits from own garden and the right side of the ground floor and rear garden. This a perfect buy for first time buyers or a buy-to-let investment.

Everton Drive is situated only a short stroll from all local amenities, these great transport links via various bus routes and Queensbury Underground Station (Jubilee Line – 0.2M Radius). Local schools, parks and places of worship are also within easy reach.

Deposit of £1944.25 at the asking price  
Harrow Council Tax Band C.

### Viewing

Please contact our Davidson Frost-Wellings Office on 020 8954 8806 if you wish to arrange a viewing appointment for this property or require further information.

- Two Bedroom
- Chain Free
- Own Entrance
- Garden
- Maisonette
- Close to Transport Links



# Floor Plan

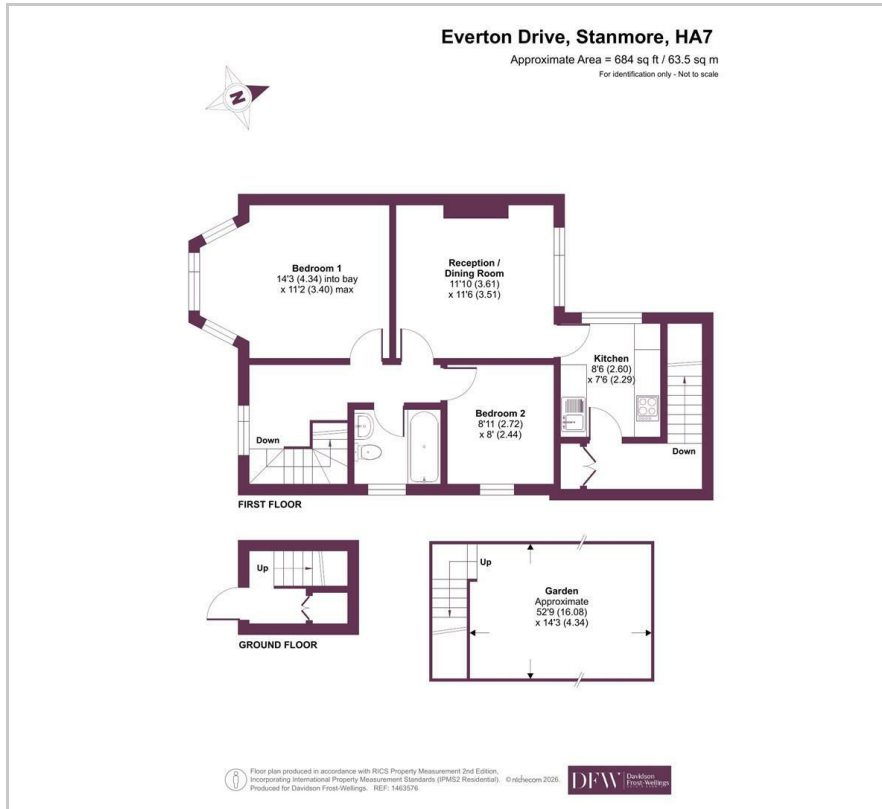

# Area Map

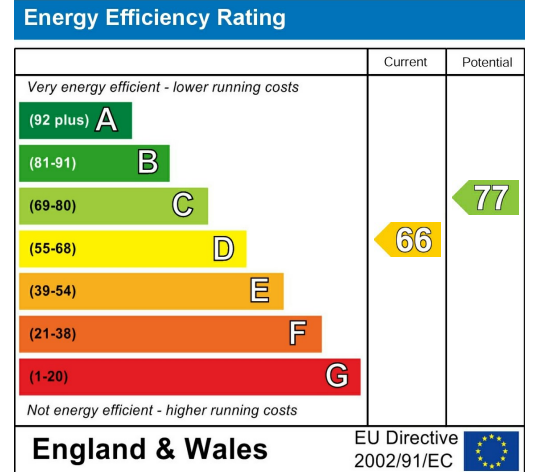
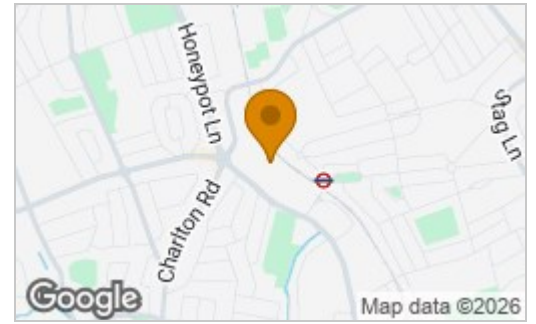

These particulars, whilst believed to be accurate are set out as a general outline only for guidance and do not constitute any part of an offer or contract. Intending purchasers should not rely on them as statements of representation of fact, but must satisfy themselves by inspection or otherwise as to their accuracy. No person in this firm's employment has the authority to make or give any representation or warranty in respect of the property.