



Yeoman Street, SE8

£2,450 Per calendar month

Located within a modern development, this well presented apartment offers two spacious double bedrooms and two bathrooms, ideal for professional sharers or a couple seeking extra space. The property features a bright open plan kitchen and living area, complete with tiled flooring throughout and access to a private balcony. The apartment also provides built-in storage and modern fixtures and fittings throughout.

Conveniently positioned in Surrey Quays, residents benefit from easy access to local shops, cafés, parks, and excellent transport links, offering quick connections to Canary Wharf and Central London.

Features

- Two Bedrooms
- Two Bathrooms
- Private balcony
- Residents Gym
- Concierge
- Parking



Yeoman Street, SE8

Located within a modern development, this well presented apartment offers two spacious double bedrooms and two bathrooms, ideal for professional sharers or a couple seeking extra space.

The property features a bright open plan kitchen and living area, complete with tiled flooring throughout and access to a private balcony. The apartment also provides built-in storage and modern fixtures and fittings throughout.



Yeoman Street, London, SE8

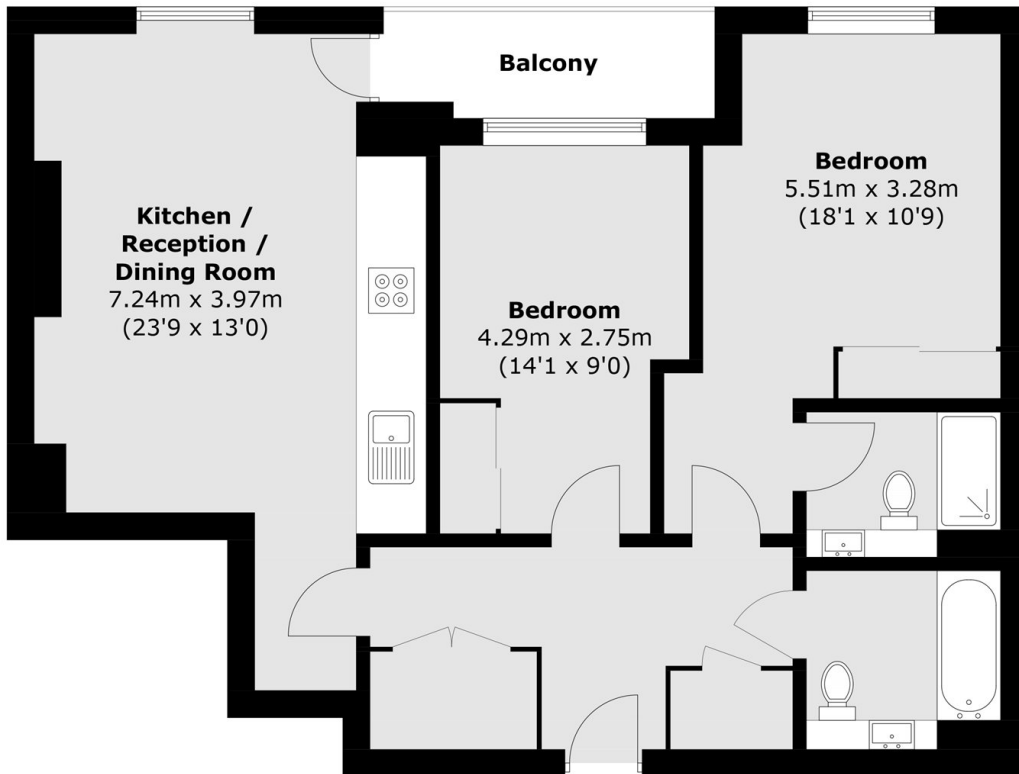

Total area (approx.): 72.1 sq. m (776.1 sq. ft)
Balcony : 4.2 sq. m (45.2 sq. ft)