

**Flat 14, Vicarage House, Cambridge Road,
 £375,000**

2 1

A spacious and well-presented two double bedroom apartment located in a highly convenient position in Kingston upon Thames. The property offers a bright reception room, separate kitchen, two genuine double bedrooms and a family bathroom with separate WC. Ideally situated within easy reach of Kingston town centre, mainline stations and excellent local amenities.

Floor Area
710 sq. ft.

Tenure
Share Of Freehold

Service Charge
£1140 per annum

Ground Rent
£0 per annum

- Two Genuine Double Bedrooms
- Bright and Spacious Reception Room
- Separate Kitchen with Good Storage and Worktop
- Bathroom with Separate WC
- Prime Kingston upon Thames location
- Easy Access to Kingston Station and Town Centre
- Off-street Parking
- Private Balcony providing Outdoor Space
- Multiple Storage Areas Throughout
- USE REFERENCE CODE - MC1212



Age	Energy Rating	Current	Desired
92+	A		
81-91	B		
69-80	C	75 C	80 C
55-68	D		
39-54	E		
21-38	F		
1-20	G		

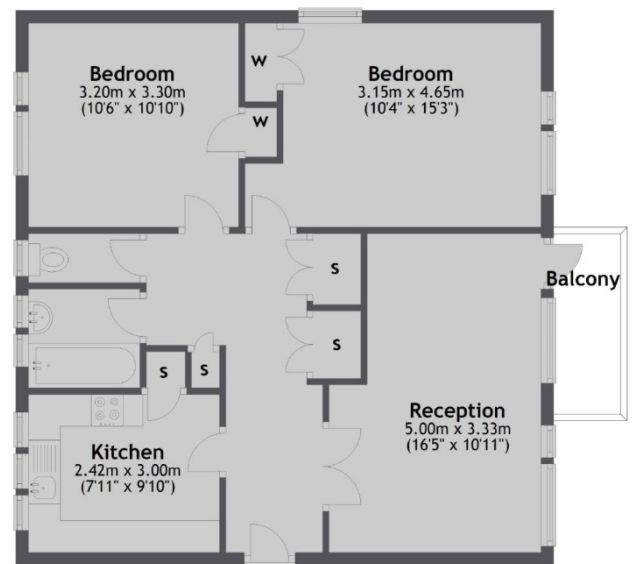

Total area: approx. 66.7 sq. metres (718.3 sq. feet)