



Coopers

Coopers

Ashington Grove, Whitley, Coventry CV3 4DB
Price: £239,950



Ashington Grove

Whitley, Coventry

Bay-fronted lounge diner with good natural light - well maintained with clear scope to update - rear garden leading to garage - set on a popular road with easy access to the city and main routes

Council Tax band: B

Tenure: Freehold

EPC Energy Efficiency Rating: D

EPC Environmental Impact Rating: E

- Three bedroom end of terrace home in a quieter part of Whitley
- Bay fronted lounge opening through to dining area
- Galley style kitchen with scope to update
- Downstairs WC
- Three bedrooms including a well proportioned main with bay window
- Bathroom with shower over bath
- Good sized rear garden with patio and lawn, leading to garage and shed to the rear
- Convenient access to Coventry city centre, A45 and A46
- Well maintained throughout with potential to add value





Ground Floor

Approx. 38.0 sq. metres (409.5 sq. feet)

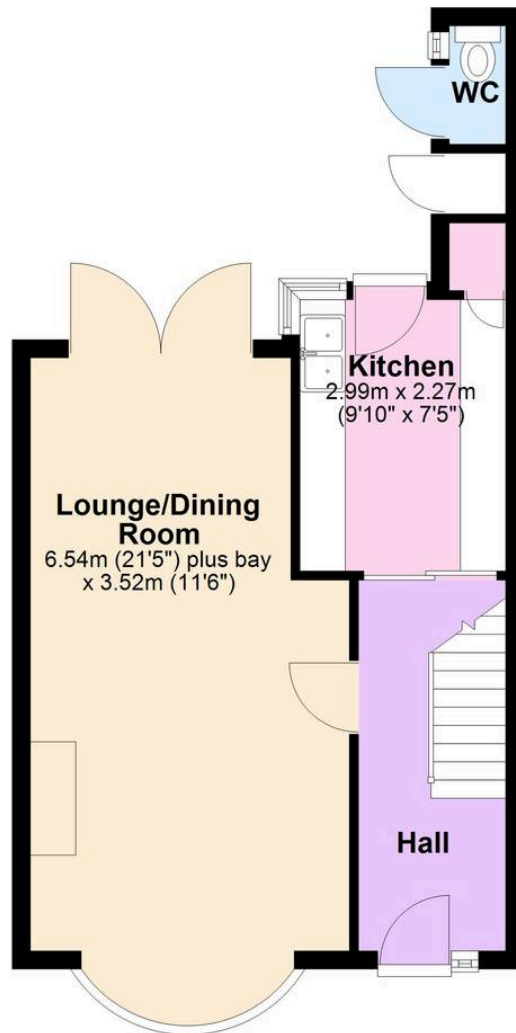

First Floor

Approx. 34.5 sq. metres (371.5 sq. feet)

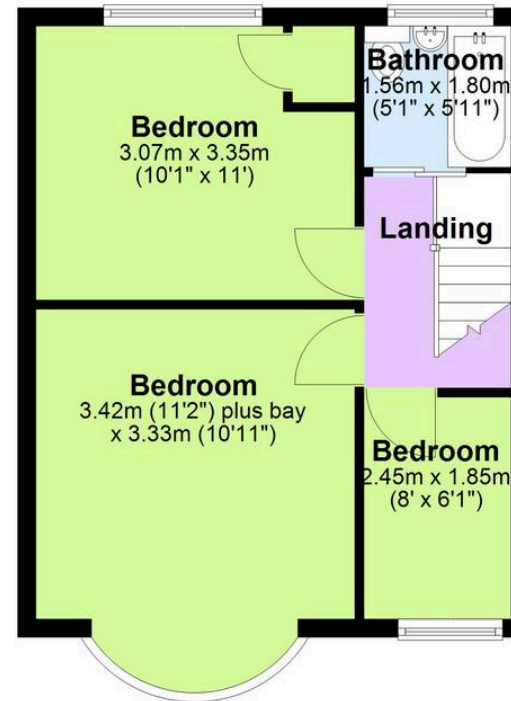

*Floor plan measurements are approximate and are for illustrative purposes only. While every effort is made to ensure accuracy, no responsibility is taken for any error, omission, or misstatement. Do not scale from this plan.
Plan produced using PlanUp.□□

Coopers Estate Agents

Coopers, 22 New Union Street - CV1 2HN

024 7655 2841 • sales@coopersestateagents.com • www.coopersestateagents.com/

Coopers

Coopers Chartered Surveyors Ltd, 22 New Union Street, Coventry, West Midlands

CV1 2HN, 024 7655 2841, sales@coopers-cov.com. Company Registration

Number: 6725089 / VAT number: 940 3555 34