



W
WHITES

22 Charter Court, Gigant Street, Salisbury, Wiltshire, SP1 2LH

£1,500 PCM

About The Property

Whites are proud to present this three-bedroom townhouse situated within Charter Court, offering spacious accommodation across three floors while being conveniently located close to the city centre.

Accommodation comprises:

Entrance into the ground floor hallway with stairs leading to the upper floors. The property benefits from a fitted kitchen complete with cupboards and drawers below, wall units, integrated fridge freezer, gas hob and gas oven.

To the rear of the property is a well-sized living room with access leading out into the enclosed rear garden, fitted with a storage shed.

The first floor comprises two bedrooms alongside a family bathroom fitted with a white suite comprising WC, wash hand basin, separate shower cubicle and bath.

Occupying the second floor is the masterbedroom benefitting from fitted cupboards and an ensuite bathroom fitted with a white suite comprising WC, wash hand basin and bath with overhead shower.

Further benefits include gas central heating throughout, allocated private parking separate to the property and an EPC rating of C.

Situated in the heart of Salisbury, the property is within easy reach of local amenities, transport links and the city centre.



- Central location
- Fitted kitchen with integrated fridge freezer
- Spacious living room
- Three bedrooms
- Two bathrooms
- Garden
- Gas central heating
- Double glazing
- Car barn
- EPC C

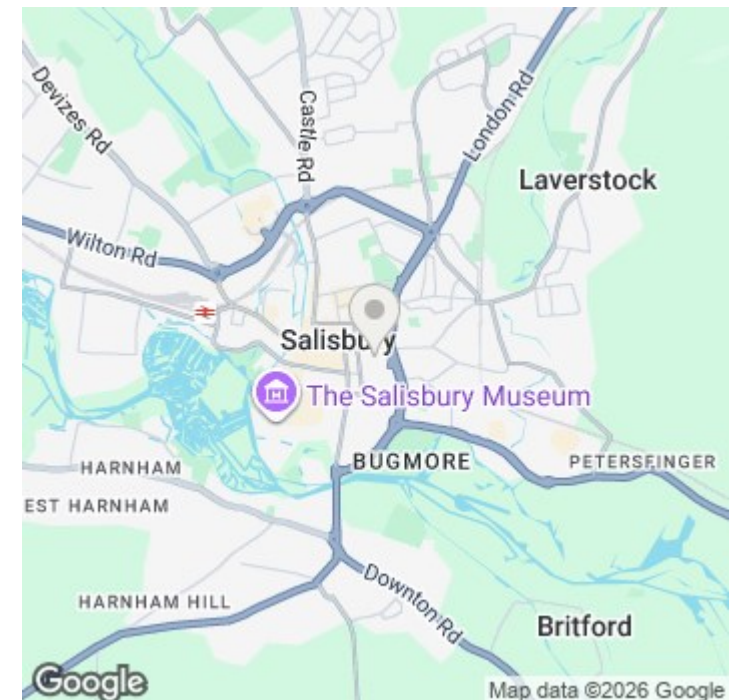



Further Information

Let available date: 8th June 2026
 NB: This date is provisional and will only be confirmed once referencing has been successfully completed.

Property type: House - Townhouse

Furnish type: Unfurnished

Deposit: £1,730

Local authority: Wiltshire Council

Council Tax: Band E

EPC: C(70)

Ground Floor

Approx. 38.8 sq. metres (417.2 sq. feet)

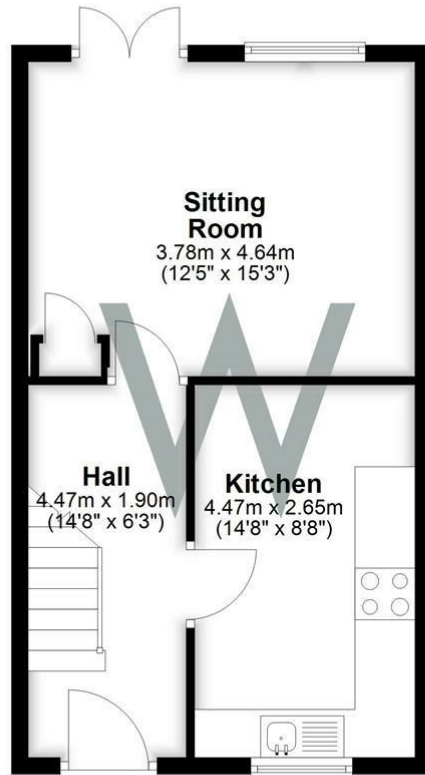

First Floor

Approx. 38.2 sq. metres (410.8 sq. feet)

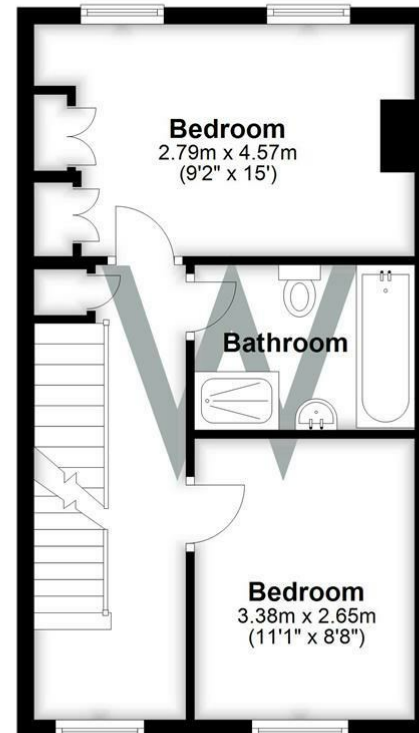

Second Floor

Approx. 38.2 sq. metres (410.8 sq. feet)

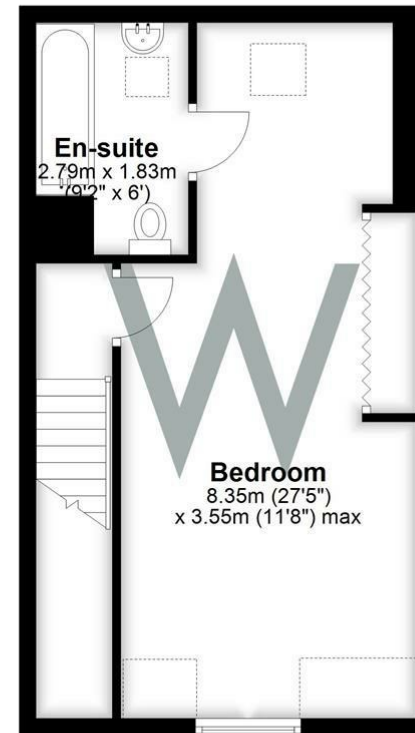

Total area: approx. 115.1 sq. metres (1238.9 sq. feet)

Energy Efficiency Rating

	Current	Potential
Very energy efficient - lower running costs		
(92 plus) A		
(81-91) B		
(69-80) C		
(55-68) D		
(39-54) E		
(21-38) F		
(1-20) G		
Not energy efficient - higher running costs		
	70	82
England & Wales	EU Directive 2002/91/EC 