



## 11 Denmark Road, King's Lynn PE30 4BD

£235,000

3 1 2



**PERECT FIRST HOME!** Tucked away in the popular Springwood High School catchment, this charming three-bedroom end-of-terrace home is full of warmth and character. From off-road parking to inviting living and dining spaces with feature fireplaces, it's a home made for everyday living and special moments. With three generous bedrooms, a garden accessed via double doors and a practical kitchen with utility area, this much-loved home is ready for its next chapter, could that chapter be yours.



## Key Features

- End-Terraced House
- Beautifully Presented
- Off-Road Parking
- Ideal First Home
- Generous Garden
- Three Bedrooms
- Sought After Location - Springwood High School Catchment
- Gas Central Heating
- Close to Local Shops and Amenities
- Two Reception Rooms

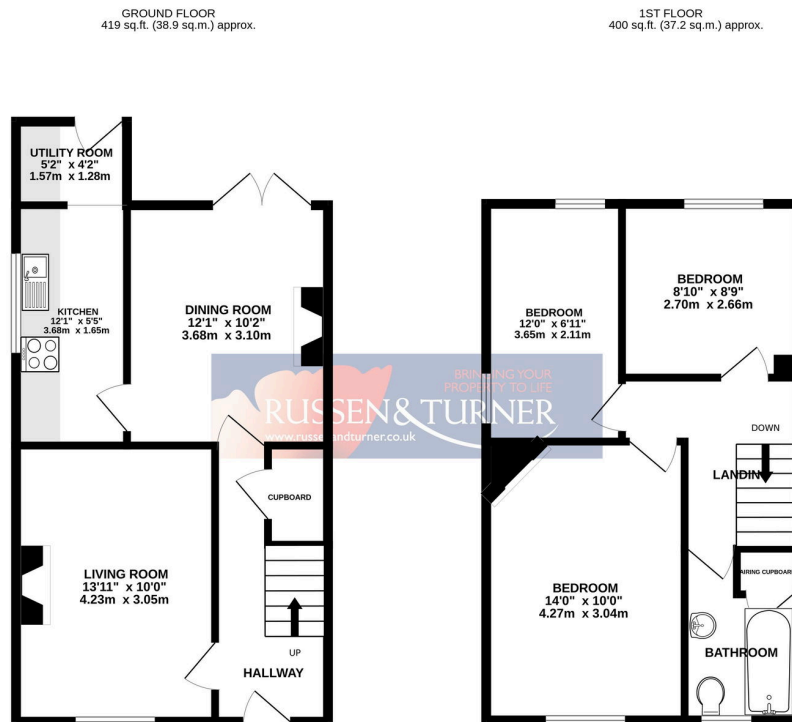

TOTAL FLOOR AREA: 819 sq.ft. (76.1 sq.m.) approx.

Whilst every attempt has been made to ensure the accuracy of the floorplan contained here, measurements of doors, windows, rooms and any other items are approximate and no responsibility is taken for any error, omission or mis-statement. This plan is for illustrative purposes only and should be used as such by any prospective purchaser. The services, systems and appliances shown have not been tested and no guarantee as to their operability or efficiency can be given.  
Made with Metropix ©2025

