



## Isaac Way, SE1 £450,000

A highly attractive second floor flat, set to the back of the building, with a bright, private balcony, an open plan living room & modern kitchen, a generous double bedroom, with built-in wardrobes & modern three piece bathroom, plus secure underground parking.

Isaac Way sits just behind Borough Station, quietly tucked off Marshalsea Road, at the foot of Borough High Street. Moments away, Borough Market brings a lively mix of street food, artisan coffee, and local culture. A short walk leads to London Bridge and the riverside buzz of the South Bank.

### Features

- One Double Bedroom
- Lift Access & Secure Entry
- Excellent Transport Links
- Secure Underground Parking
- Private Balcony
- Chain Free Sale

Isaac Way,  
London, SE1

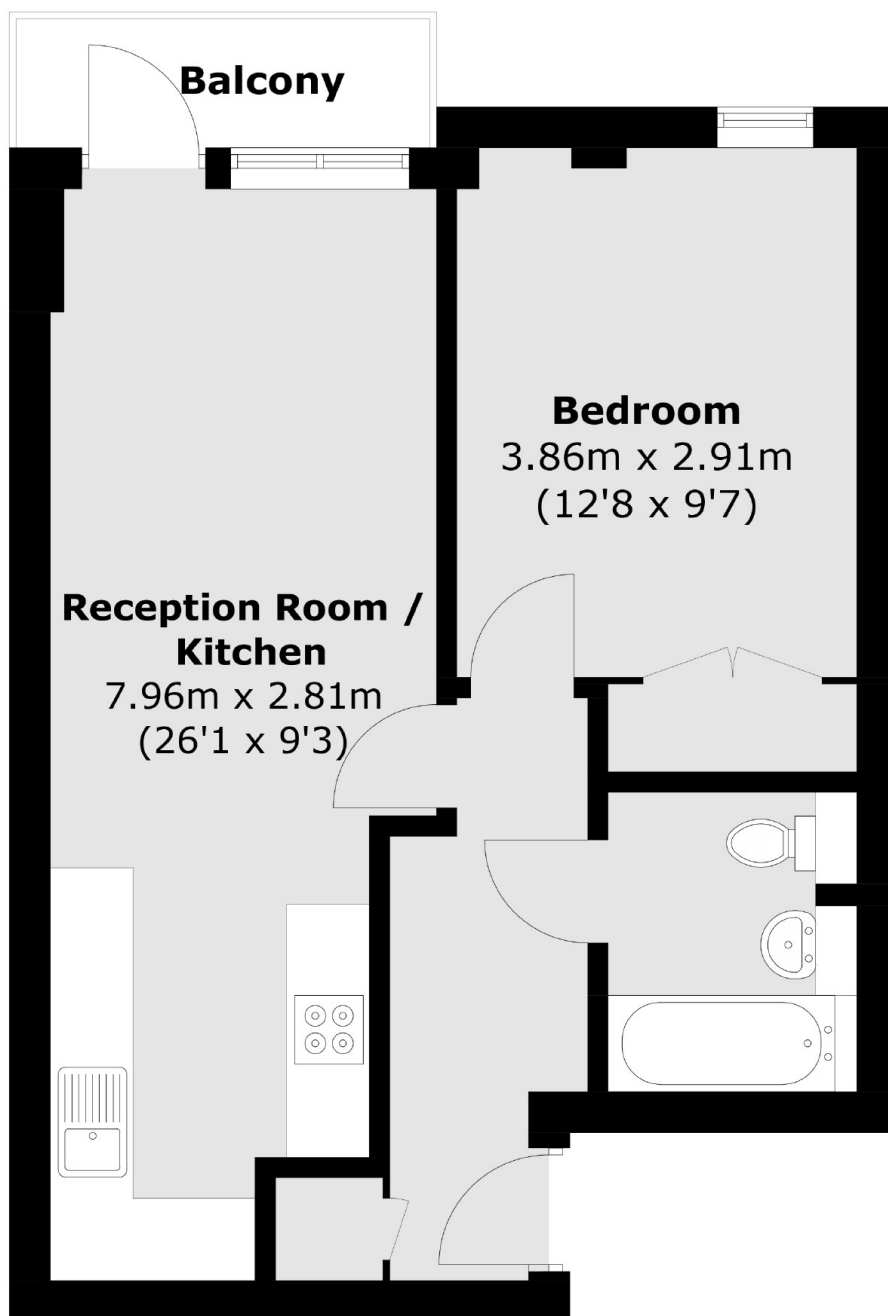

Total area (approx.): 44.5 sq. m (479.0 sq. ft)  
Balcony: 2.8 sq. m (30.1 sq. ft)

**Dexters**

London Bridge  
54 Borough High Street  
London  
SE1 1XL  
Sales  
020 7650 5 100

Energy Rating: C. We aim to make our particulars both accurate and reliable. However they are not guaranteed; nor do they form part of an offer or contract. If you require clarification on any points then please contact us, especially if you're traveling some distance to view. Please note that appliances and heating systems have not been tested and therefore no warranties can be given as to their good working order.

 **RICS** | Regulated  
Estate Agent  
and Letting Agent

dexters.co.uk