



CRICKETERS CLOSE ERITH KENT
DA8 1TU
OFFERS IN EXCESS OF: £180,000 | Leasehold



A well-presented one-bedroom apartment situated on the first floor of a contemporary development, just a short stroll from Erith town centre. The location offers convenient access to a variety of shops, restaurants, and bars, as well as Erith train station, providing direct links to Abbey Wood and the Elizabeth Line, alongside other key transport connections. Ideal for first-time buyers or investors alike, the property features an entrance hall, a modern fitted kitchen that opens into a bright living area, a stylish bathroom, and a comfortable double bedroom. Notable advantages include a newly extended lease of 996 years, electric heating, and allocated parking. Early viewing is highly recommended.

Lease: 996 years

Service Charge: £1,433.99 per annum

Local Authority: Bexley

Council Tax Band: B

Score	Energy rating	Current	Potential
92+	A		
81-91	B		
69-80	C	70 C	79 C
55-68	D		
39-54	E		
21-38	F		
1-20	G		



01322 553322

60-62 High Street, Bexley, Kent DA5 1AH

bexley@parkestates.co.uk

www.parkestates.co.uk

Cricketers Close

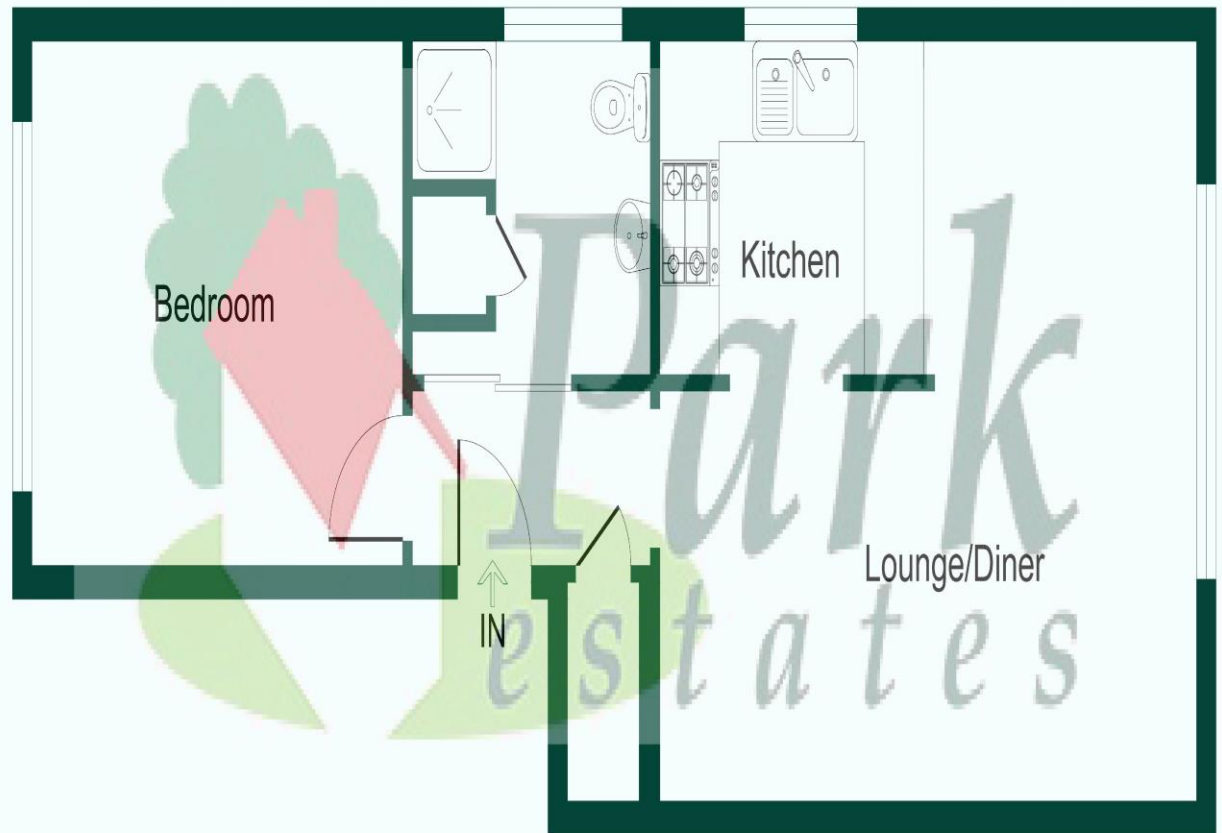

This plan is for layout guidance only. Not drawn to scale unless stated. Windows and door openings are approximate. Whilst every care is taken in the preparation of this plan, please check all dimensions, shapes and compass bearings before making any decisions reliant upon them.

Produced By Planpix

Every care has been taken with the preparation of details, but accuracy is in no way guaranteed. These particulars do not constitute a contract and are issued and accepted on the express understanding that all negotiations will be conducted through Park Estates. The seller does not make or give, nor do we or our employees have any authority to give a representation or warranty in relation to the property. Please contact this office before viewing the property. If there is any point which is of particular importance to you, we will be pleased to check the information for you and confirm that the property remains available. This is particularly important if you are contemplating travelling some distance to view the property. We would strongly recommend that all the information that we provide about the property is verified by yourself on inspection and also by your conveyancer, especially where statements have been made by us to the effect that the information provided by us has not been verified.