



Milward Road, Hastings TN34 3RS

£180,000



A stylish ONE BEDROOM APARTMENT with a COURTYARD GARDEN spanning the ground floor of this attractive residence. Situated in a central location, it is close to local shops at Priory Meadow, the beach, Alexandra Park and Hastings mainline railway station with its connections to London. The accommodation here is arranged as an OPEN-PLAN LIVING SPACE which measures an impressive 16'4 x 12'10 benefitting from a MODERN FITTED KITCHEN which offers ample storage and worktop space. At the rear of the property is the DOUBLE BEDROOM which enjoys access through double doors to the courtyard garden and the bathroom where there is a bath with shower over. The hallway spans the width of the kitchen and bedroom and offers storage through built in cupboards. Set in a CONVENIENT LOCATION and with a SHARE OF FREEHOLD this fantastic property would make the PERFECT FIRST TIME HOME or seaside retreat and is not to be missed.

GROUND FLOOR
413 sq.ft. (38.4 sq.m.) approx.

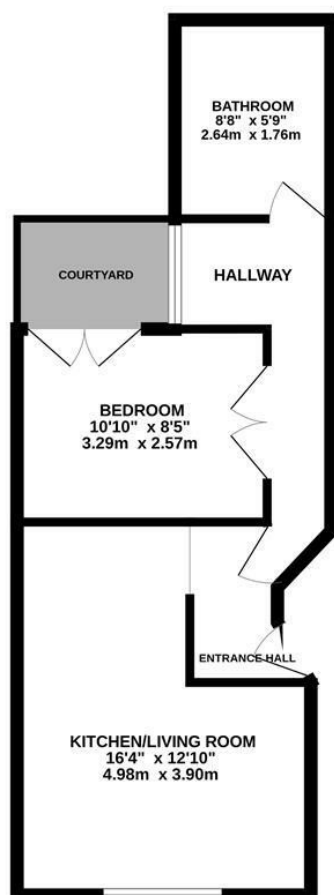

TOTAL FLOOR AREA : 413 sq.ft. (38.4 sq.m.) approx.

Whilst every attempt has been made to ensure the accuracy of the floorplan contained here, measurements of doors, windows, rooms and any other items are approximate and no responsibility is taken for any error, omission or mis-statement. This plan is for illustrative purposes only and should be used as such by any prospective purchaser. The services, systems and appliances shown have not been tested and no guarantee as to their operability or efficiency can be given.
Made with Metropix ©2025

