



Connells

Murphy Street
Fradley LICHFIELD



Property Description

Connells Lichfield are absolutely thrilled to offer for sale this stunning home in Fradley.

Approached via attractive kerb appeal with a driveway for two cars at the front, the first impressions of this modern home are delightful. Internally you are greeted with a welcoming entrance hallway with a modern fitted kitchen to the fore, plus ground floor W.C, leading into a spacious lounge/diner to the rear with ample social space and French doors out to the garden.

Upstairs are two large double bedrooms and a family sized bathroom. The main bedroom also features a private en-suite shower room.

Outside to the rear is a charming landscaped rear garden being fully enclosed and to the front we can offer a double driveway.

****GET ON THE PROPERTY LADDER IN FRADLEY, LICHFIELD, WITH THIS BEAUTIFUL AND MORE THAN CHARMING HOME ABSOLUTELY READY TO MOVE INTO****

****CALL CONNELLS LICHFIELD TODAY TO BOOK YOUR VIEWING SLOT TODAY****

****CONNELLS OFFERS FREE MORTGAGE ADVICE IF NEEDED, JUST LET US KNOW****

Entrance Hallway

Guest Wc

Kitchen

11' 3" x 6' 8" (3.43m x 2.03m)

Lounge/Diner

14' 3" x 6' 8" (4.34m x 2.03m)

First Floor Landing

Master Bedroom

11' x 9' 7" (3.35m x 2.92m)

En-Suite Shower Room

Bedroom Two

13' 10" x 7' 9" (4.22m x 2.36m)

Family Bathroom

Driveway

Landscaped Rear Garden







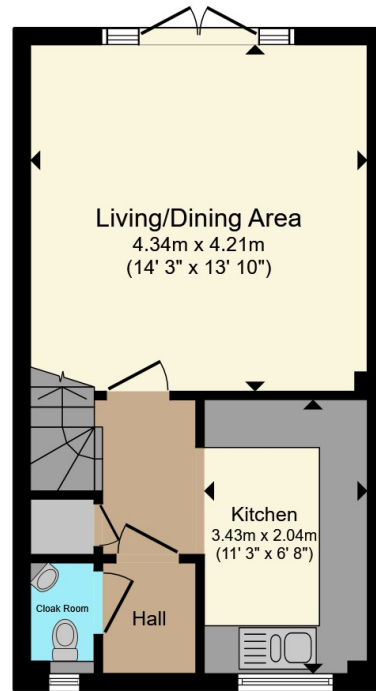

Ground Floor

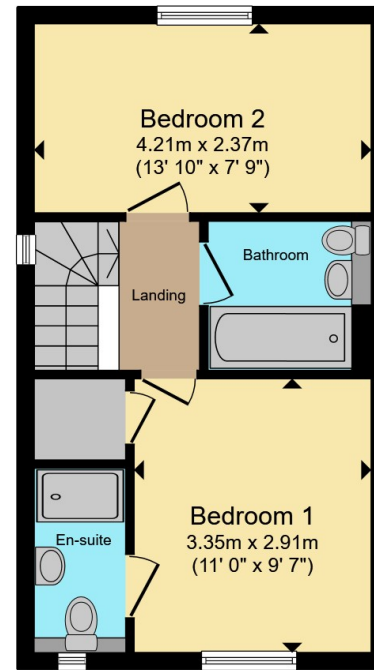

First Floor

Total floor area 66.3 m² (713 sq.ft.) approx

This floor plan is for illustrative purposes only. It is not drawn to scale. Any measurements, floor areas (including any total floor area), openings and orientation are approximate. No details are guaranteed, they cannot be relied upon for any purpose and they do not form part of any agreement. No liability is taken for any error, omission or misstatement. A party must rely upon its own inspection(s). Powered by www.propertybox.io



To view this property please contact Connells on

T 01543 262 376
E lichfield@connells.co.uk

11-13 Bore Street
LICHFIELD WS13 6LZ

EPC Rating: B Council Tax
Band: B

Tenure: Freehold

view this property online connells.co.uk/Property/LFD312076



1. MONEY LAUNDERING REGULATIONS Intending purchasers will be asked to produce identification documentation at a later stage and we would ask for your co-operation in order that there will be no delay in agreeing the sale. 2. These particulars do not constitute part or all of an offer or contract. 3. The measurements indicated are supplied for guidance only and as such must be considered incorrect. Potential buyers are advised to recheck measurements before committing to any expense. 4. We have not tested any apparatus, equipment, fixtures, fittings or services and it is in the buyers interest to check the working condition of any appliances.

Connells Residential is registered in England and Wales under company number 1489613, Registered Office is Cumbria House, 16-20 Hockliffe Street, Leighton Buzzard, Bedfordshire, LU7 1GN. VAT Registration Number is 500 2481 05.

See all our properties at www.connells.co.uk | www.rightmove.co.uk | www.zoopla.co.uk

Property Ref: LFD312076 - 0003