



**POOLE
TOWNSEND**

Leece Lane, Barrow-in-furness, LA13 0JH

£280,000

🛏️ 2 🚿 1 🚗 1



- 2 Bed detached bungalow
- Located In Popular Holbeck
- Open plan Lounge / dining room
- Kitchen With Access to Garden
- Two Excellent bedrooms
- A shower Room
- Garden At Front, Side And Rear
- A Driveway
- A Garage
- New Roof and Boiler Fitted in 2024



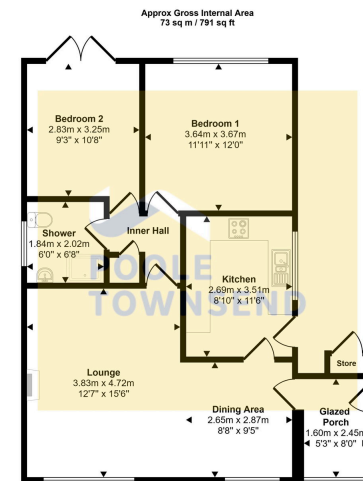

Floorplan

This floorplan is only for illustrative purposes and is not to scale. Measurements of rooms, doors, windows, and any items are approximate and no responsibility is taken for any error, omission or mis-statement. Icons of items such as bathroom suites are representations only and may not look like the real items. Made with Made Snappy 360.

This beautifully presented bungalow is located in the popular Holbeck area of town, sat in an elevated position above the pavement creating much improved privacy. The glazed porch provides a relaxing space to sit as well as access into the spacious, open plan lounge-dining room which enjoys a pleasant view across the road to the fields and allotments. The kitchen has access to the garden and a modern range of fitted units and appliances. An inner hall leads you into two excellent bedrooms and a shower room. There are gardens to the front, side and rear, a gated driveway and garage. New boiler fitted 2024, and new slate roof fitted 2024.

Parking at the rear of the property.

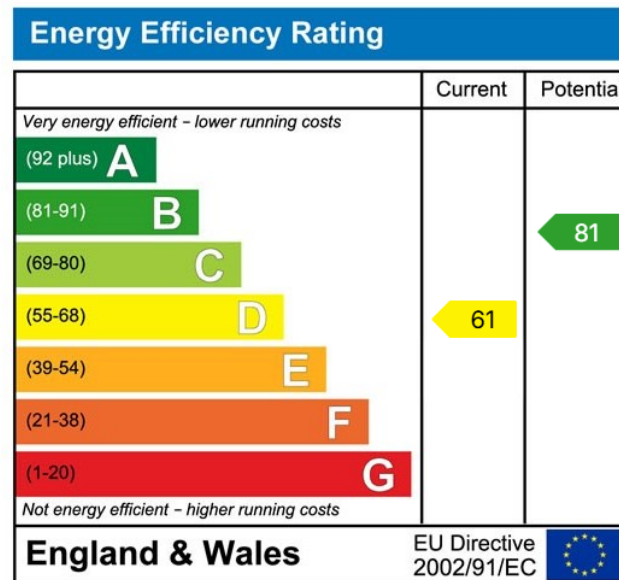

Visit us at
www.pooletownsend.co.uk
enquiries@pooletownsend.co.uk

We are open
 Monday – Friday 9.00 – 5.00
 Saturday 9.00 – 1.00

Barrow 01229 811811
 Ulverston 01229 588111
 Grange 015395 33316
 Kendal 01539 734455
 Milnthorpe 015395 62044