



## DAWES ROAD, SW6

£4,750 per week ( per month)

Four double bedrooms  
Bright living space  
South facing roof terrace  
Close to Fulham

# ABOUT THE PROPERTY

This fantastic apartment has retained many of its original features and is arranged over two floors boasting a huge amount of space throughout. Comprising a bright open plan kitchen/reception room, two brand new bathrooms, four evenly sized double bedrooms and a beautiful south facing roof terrace.

Dawes Road is conveniently located in the heart of Fulham and within easy reach of the transport links and amenities of Parsons Green Earls Court and Fulham Broadway.

Council Tax Band - E









# STEP INSIDE DAWES ROAD



**Ground Floor**

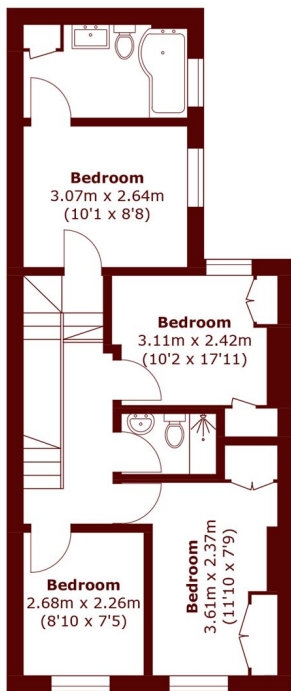

**First Floor**



**Second Floor**

Total area (approx.): 80.1 sq. m (862.2 sq. ft)

Terrace: 13.2 sq. m (142.1 sq. ft)

**Bishops Park**  
020 7368 2480

Energy Rating: We aim to make our particulars both accurate and reliable. However, they are not guaranteed; nor do they form part of an offer or contract. If you require clarification on any points then please contact us, especially if you're traveling some distance to view. Please note that appliances and heating systems have not been tested and therefore no warranties can be given as to their good working order

**MARSH &  
PARSONS**