



Iris Crescent, Lincoln



£280,000

- Three Storey Semi Detached House
- Four Bedrooms
- Bathroom & En-Suite
- Open Plan Living Kitchen
- Well Presented Throughout
- Driveway & Garage
- Freehold
- EPC rating TBC



Well presented four bedroom semi-detached home arranged over three storeys, offering spacious and modern accommodation in a popular residential location.

The accommodation comprises an open-plan living, dining and kitchen area, together with a separate utility room and downstairs WC. The four bedrooms are arranged over the first and second floors, including a master bedroom with en-suite, with a further family bathroom. Externally, the property benefits from driveway parking and a detached garage. The property is within walking distance of Lincoln city centre, University of Lincoln and West Common, and is conveniently located close to local amenities, schools and transport links.

Entrance Hall

With entrance door to the front aspect and access to the WC

Living Kitchen Diner 22'1" x 12'9" (6.7m x 3.9m)

With french doors leading to the rear garden, a range of wall and base units with worktops, integrated oven and hob with extractor over, sink with drainer unit, understairs cupboard and a radiator.



Utility Room 6'0" x 5'9" (1.8m x 1.8m)

With a window to the front aspect, base units with worktops, sink with drainer unit, space for washing machine and tumble dryer.

WC

With a window to the front aspect, low level wc, wash hand basin and radiator.

First Floor Landing

With stairs to the ground and second floor.

Bedroom One 12'9" x 11'6" (3.9m x 3.5m)

With windows to the front aspect and radiator.

Bedroom Two 12'9" x 9'3" (3.9m x 2.8m)

With a window to the rear aspect, access to the en-suite and a radiator.

En-Suite

With an enclosed shower, low level wc, wash hand basin and radiator.

Second Floor Landing

With access to the first floor.

Bedroom Three 13'4" x 12'9" (4.1m x 3.9m)

With a window to the front aspect and radiator.

Bedroom Four 10'1" x 6'1" (3.1m x 1.9m)

With a window to the rear aspect and radiator.

Bathroom

With a window to the rear aspect, low level wc, wash hand basin, panelled bath with shower over and radiator.

Garage 17'6" x 9'0" (5.3m x 2.7m)

With an up and over door, power and lighting.

Outside

To the front of the property is a driveway leading to the single garage and access to the entrance door. To the rear of the property is an enclosed lawned garden with patio.

Agents Note

These particulars are issued in good faith but do not constitute representations of fact or form part of any offer or contract. The matters referred to in these particulars should be independently verified by prospective buyers or tenants. Neither Newton Fallowell nor any of its employees or agents has any authority to make or give any representation or warranty whatever in relation to this property.



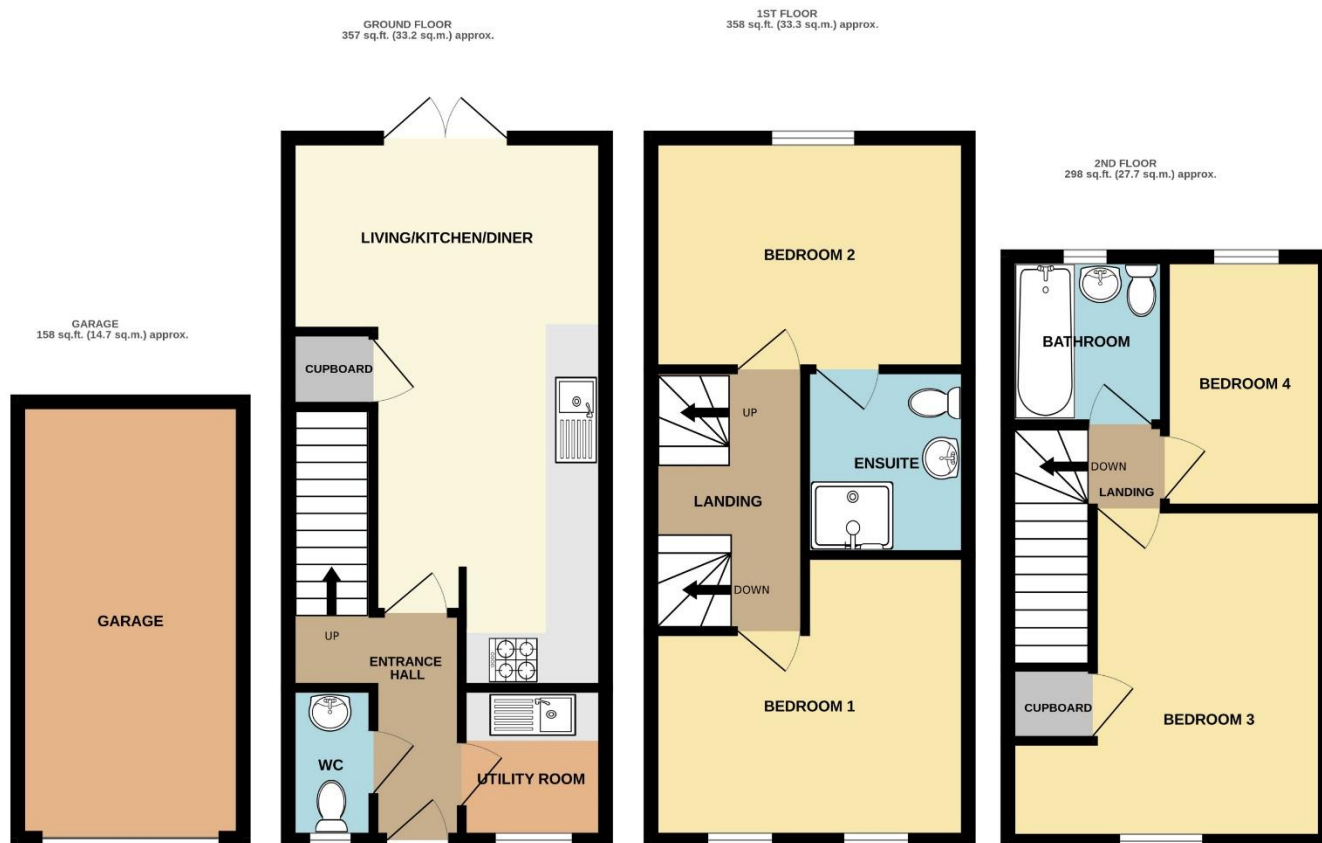

IRIS CRESCENT, LINCOLN, LN1 1AZ

TOTAL FLOOR AREA : 1172 sq.ft. (108.8 sq.m.) approx.

Whilst every attempt has been made to ensure the accuracy of the floorplan contained here, measurements of doors, windows, rooms and any other items are approximate and no responsibility is taken for any error, omission or mis-statement. This plan is for illustrative purposes only and should be used as such by any prospective purchaser. The services, systems and appliances shown have not been tested and no guarantee as to their operability or efficiency can be given.

Made with Metropix ©2026

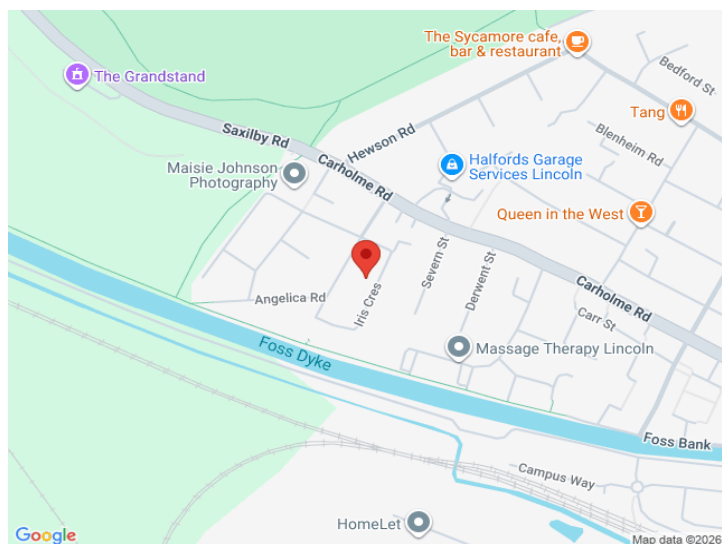

 **NEWTONFALLOWELL**

Newton Fallowell Lincoln

01522 516590

lincoln@newtonfallowell.co.uk