



Park Street, W1K

£6,933 Per calendar month

Dexters



Park Street, W1K

A spacious three double bedroom, three bathroom lateral apartment located on the sixth floor of this highly sought after portered building. The property is situated in an ideal location in Mayfair.

This spacious apartment comprises of a large open double reception room ideal for hosting and entertaining guests with a separate kitchen area.

The principal bedroom comes complete with a en suite bathroom and the property offers two extra double bedrooms with built in storage, a family bathroom and a WC perfect for guests.

The property further benefits from a 24 hour porter service and lift access just moments from Oxford Street and Park Lane.

New Hereford House is situated just south of Oxford Street and close to Park Lane. There is access to all the amenities of Mayfair as well as the West End.

Features

- Three Double Bedrooms
- Three Bathrooms
- Double Reception Room
- 24-Hour Porterage
- Lift Access
- Excellent Location



Park Street,
London, W1K

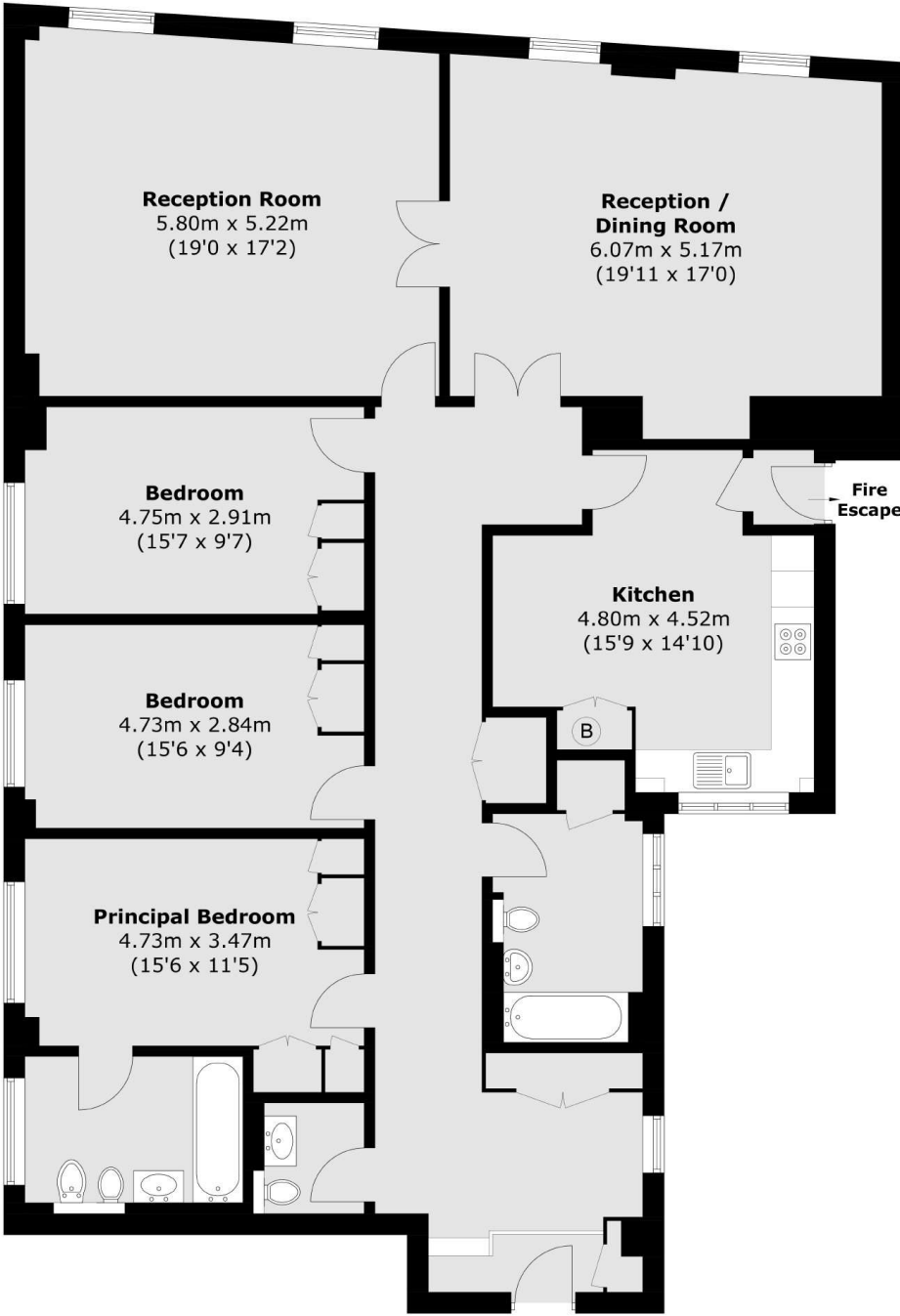

Total area (approx.): 174.1 sq. m (1,874.0 sq. ft)



Wetherell
102 Mount Street
London
W1K 2TH
Lettings
020 7529 5588

Energy Rating: C. We aim to make our particulars both accurate and reliable. However they are not guaranteed; nor do they form part of an offer or contract. If you require clarification on any points then please contact us, especially if you're traveling some distance to view. Please note that appliances and heating systems have not been tested and therefore no warranties can be given as to their good working order.



dexters.co.uk