

## London Road, Rake, West Sussex

Offers In Region Of £1,000,000

4 2 1



A beautifully positioned four bedroom village home offering glorious, sweeping vistas across Rake Hangar, Milland Valley and the rolling countryside beyond. Situated in the highly sought-after village of Rake, close to the South Downs National Park, this impressive home combines spacious living with an exceptional outlook. The expansive open plan living and dining area is a true highlight, enjoying panoramic countryside views and creating a spectacular space for both family life and entertaining. The principal bedroom suite features a stylish tiled en-suite shower room and dressing room, while three further bedrooms are served by a superb family bathroom with corner bath and walk-in shower. The well-appointed kitchen also benefits from lovely hill views and is complemented by a practical boot room, utility room and store. Outside, there is generous parking for multiple vehicles, making this an ideal rural retreat within easy reach of London connections and village amenities.

- Open Plan Living/Dining Room with slide/bi-fold doors to garden
- High Specification Throughout
- Excellent Village Location within the South Downs
- Large Garden Plot
- Close to Mainline Stations to London
- Driveway for multiple cars
- Elevated and Expansive Countryside Views
- Primary Bedroom with Dressing Room and luxurious En-Suite
- Luxurious Main Bathroom with Corner Bath & Walk in Shower
- Excellent Schools

**London Road**  
Approx. Gross Internal Floor Area  
2437 sq. ft / 226.40 sq. m

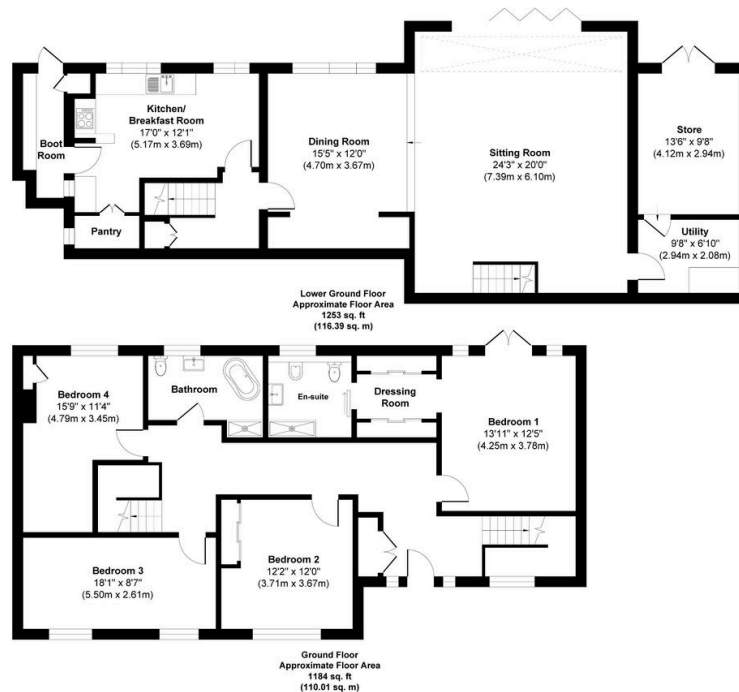

Whilst every attempt has been made to ensure the accuracy of the floor plan shown, all measurements, positioning, fixtures, fittings and any other data shown are an approximate interpretation for illustrative purposes only and are not to scale. No responsibility is taken for any errors, omission, miss-statement or use of data shown.  
Produced by Home Focus Studio Ltd.