



19 Fraser Road

, Havant, PO9 3EJ

Offers in excess of £260,000



19 Fraser Road

, Havant, PO9 3EJ

Offers in excess of £260,000



This well-presented two-bedroom end-terrace house in the sought-after area of Bedhampton offers a perfect blend of modern living and practical space, making it an ideal home for families, first-time buyers, or those looking to downsize.

Upon entering the property, you are welcomed into a bright and functional ground floor layout. The kitchen is conveniently located at the front of the property, offering ample storage and workspace for everyday cooking and entertaining, there is space under counter for a range of appliances.

The heart of the home is the spacious open-plan living and dining area, extended by previous owners, designed to create a light and airy environment. This versatile space is perfect for relaxing with family or hosting gatherings, with plenty of room for both comfortable seating and a dining setup. Large double doors to the garden and an open layout enhance the sense of space, making it a warm and inviting area to spend time in.

Upstairs, the property boasts two well-proportioned bedrooms, each offering flexibility for a growing family, home office, or guest accommodation. The rooms are thoughtfully laid out to maximise space and natural light, ensuring a comfortable living environment throughout. The family bathroom is also located on this floor, fitted with modern fixtures and designed to serve the needs of a busy household.

Externally, the property continues to impress with a generously sized and landscaped rear garden, providing plenty of outdoor space for relaxation, play, or entertaining during the warmer months. A standout

feature of the garden is the outhouse, which is equipped with electricity, making it ideal for use as a home office, workshop, gym, or additional storage space. It is largely laid with artificial turf for low-maintenance and a green look all year round!

To the front of the property, there is off-road parking available for one car, offering both convenience and peace of mind. This feature is particularly valuable in a residential area, ensuring easy access and secure parking for homeowners and visitors alike.

Overall, this property combines comfortable living spaces, practical features, and excellent outdoor amenities in a desirable location. With its well-balanced layout and added benefits such as the powered outhouse and ample parking, this home presents a fantastic opportunity for a wide range of buyers looking to settle in Bedhampton.



Road Map



Hybrid Map



Terrain Map

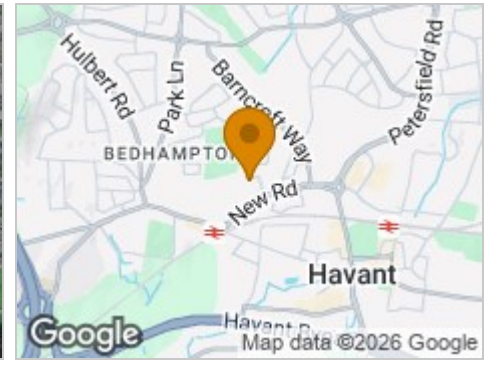

Floor Plan

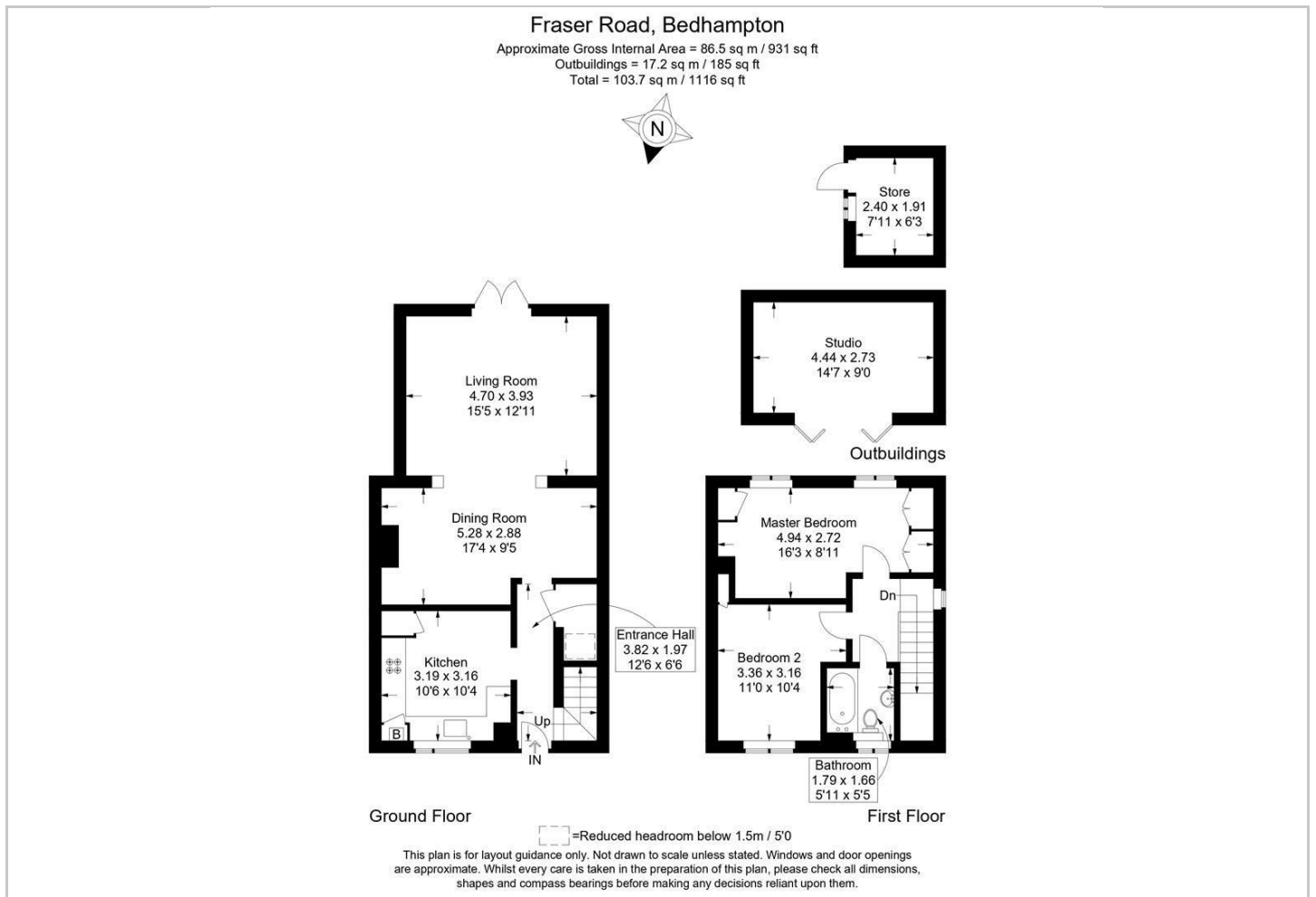

Viewing

Please contact our Central Office on 02394 217317 if you wish to arrange a viewing appointment for this property or require further information.

Energy Efficiency Graph



These particulars, whilst believed to be accurate are set out as a general outline only for guidance and do not constitute any part of an offer or contract. Intending purchasers should not rely on them as statements of representation of fact, but must satisfy themselves by inspection or otherwise as to their accuracy. No person in this firm's employment has the authority to make or give any representation or warranty in respect of the property.