



46 Southbourne Avenue, Holbury
£327,500



ANTHONY JAMES
PROPERTIES



46 Southbourne Avenue

Holbury, Southampton

Presenting a fantastic opportunity, this three-bedroom detached bungalow boasts a charming character and superb potential for refurbishment. This property features two wood burners, a convenient wet room, and has been thoughtfully extended to both the front and rear. Modern comforts are provided through double glazing and central heating systems. Additionally, the inclusion of a car port, garage with an attached workshop/shed, and driveway parking for multiple vehicles add practicality to this home. The absence of an onward chain further streamlines the purchasing process. Low maintenance rear garden and a mature front garden. Available with no onward chain.

Council Tax band: D

Tenure: Freehold



1 Southward House
Dibden Purlieu SO45 4PT



T: 02380 844405
info@anthonyjamesproperties.co.uk



GROUND FLOOR
1044 sq.ft. (97.0 sq.m.) approx.

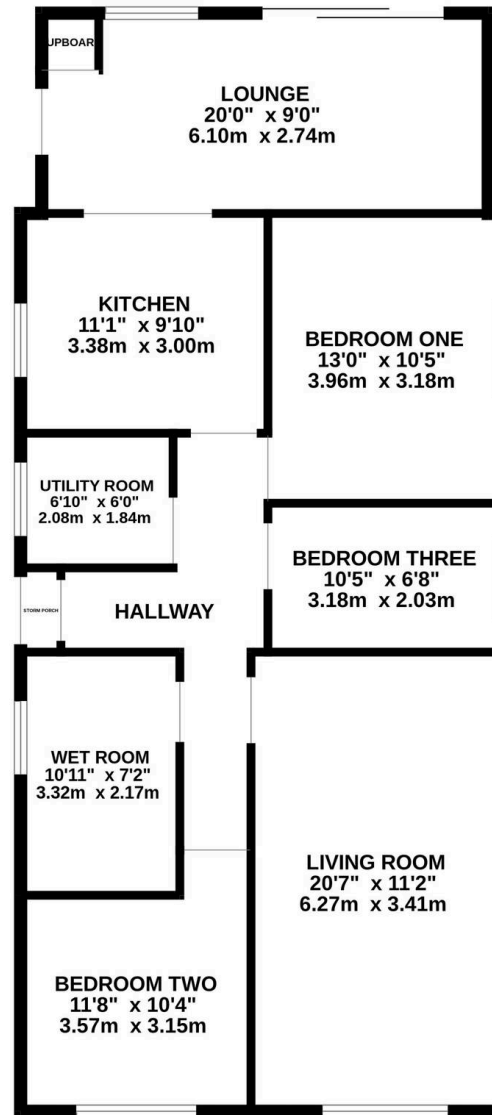

TOTAL FLOOR AREA : 1044 sq.ft. (97.0 sq.m.) approx.

Whilst every attempt has been made to ensure the accuracy of the floorplan contained here, measurements of doors, windows, rooms and any other items are approximate and no responsibility is taken for any error, omission or mis-statement. This plan is for illustrative purposes only and should be used as such by any prospective purchaser. The services, systems and appliances shown have not been tested and no guarantee as to their operability or efficiency can be given.
Made with Metropix ©2025