

fowlers
properties



Waverley

15 The Square, Chagford, Devon TQ13 8AA

£297,500 Freehold



The Property

Waverley is a stone built terraced cottage situated in the conservation area of Chagford on The Square. It has charm and character and features a large granite fireplace in the kitchen/breakfast room. It is a bright cottage with large windows allowing in plenty of natural light and the rooms are quite generous by cottage standards. The accommodation is flexible with a ground floor lounge/bedroom with an ensuite washroom and there are two first floor bedrooms. On the first floor there is a bathroom with both a bath and shower cubicle. The attic is reached by an integral staircase from bedroom 2, and has considerable potential. The cottage has superb access to amenities and does not have a garden, but there is very easy close-by access to walking and the countryside from all over the town. Fowlers strongly recommend viewing.

Situation

Waverley is located on the north side of The Square in the centre of Chagford with easy access to local amenities and day to day and specialist shops, cafes and four pubs all within a moments walk. Within 300 metres there is access to superb walks to the commons and on up to the moor.

Services

Mains gas, water, electricity and drainage.

Council Tax Band

Band C

Directions

From Fowlers front doors walk across The Square to the far side and turn right. Walk down past the bakery and gift shop and you will find Waverley on your right.

Entrance/utility room

A panelled and part obscure glazed multi paned front door with a matching side window leads into the entrance/utility room. There is a slate floor and space to hang coats just inside the door. It has a fitted Belfast sink with a brass mixer tap, pine cupboard and drawer fronts, an oak worktop and space for an automatic washing machine and an upright fridge/freezer. Two slate tiled steps lead up to the living room.

Kitchen/Breakfast Room

A bright room with three multi paned windows, a window seat, exposed ceiling timbers and a large solid granite fireplace with a granite hearth and a fitted oak mantel shelf. There is a wall light point, a single and a double panel radiator, an open sided staircase to the first floor and a latched panelled pine door to the lounge/third bedroom. The room has ample space for a six seater dining table and it is fitted with a range of base and wall cabinets with oak worktops, a fitted Belfast style sink with a mixer tap, a dish washer and a twin element induction hob.

- Set in Chagford's conservation area
- Brilliant access to amenities
- A stone built terraced home
- Three bedrooms
- Large granite fireplace in living room
- Downstairs cloakroom
- First floor bathroom with a shower
- Mains gas fired central heating
- Large accessible attic
- A charming cottage with flexible accommodation



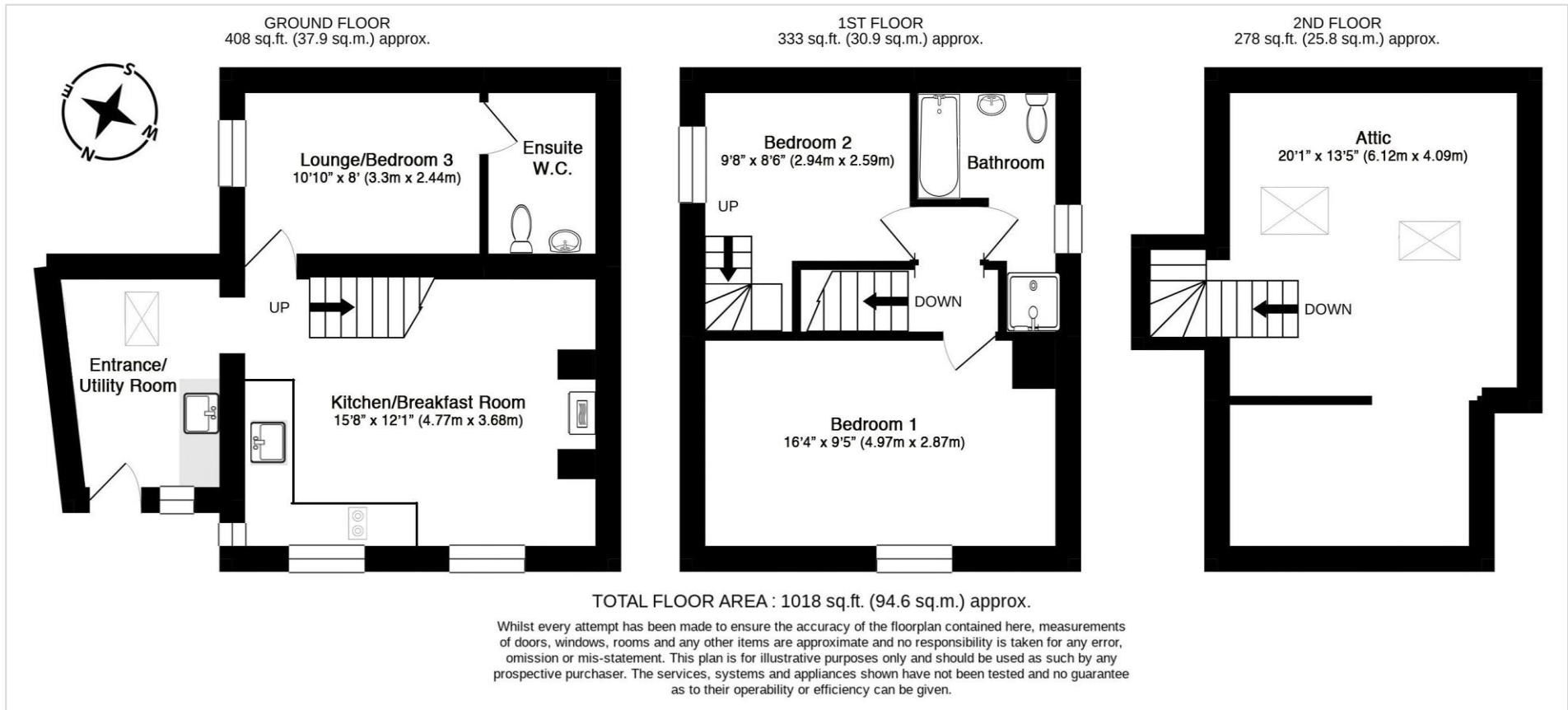

Lounge/bedroom 3

This is a bright room with a large double casement window, a ceramic tiled floor, a painted granite wall with feature stones exposed, a single panel radiator, a pendant light point and a panelled door to the downstairs cloakroom.

Cloakroom

This is fitted with a low level w.c., a vanity unit with a fitted basin and a light unit above, space for an electric drier, some exposed granite and painted stone walls and a ceramic tiled floor.

First floor

The open sided staircase has a wall mounted handrail and leads to a small landing with antique pine panelled doors to all rooms.

Bedroom 1

This is a generous front facing double bedroom with a large double casement window to the front with a window seat, original wooden floorboards, a pendant light point, a large single panel radiator and a recess for a wardrobe.

Bathroom

This is fitted with a fully tiled shower with a Triton T80si electric shower unit and a glazed shower screen door. It also has a white panelled bath with tiled splashbacks and an adjacent vanity unit with a basin and a low level w.c. with a concealed cistern. The flooring is vinyl on top of floorboards, there is a ceiling light, a double panel radiator and an obscure glazed window.

Bedroom 2

This room has a large double casement window and a window seat and it is a bright space. There is a pendant light point, a plinth/shelf above the enclosed main staircase and a double panel radiator and pendant light point. An opening leads to the integral fixed ladder staircase to the attic area.

Attic

A great space with two original roof trusses still present. It has enormous potential and has two skylights, power and light and a small double panel radiator.

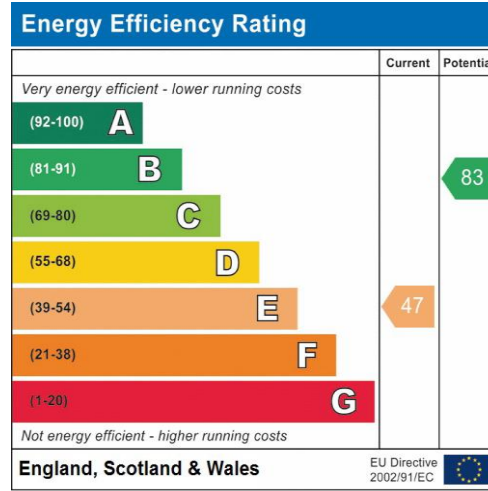

VIEWING BY APPOINTMENT ONLY

The particulars are produced in good faith and are set out as a general guide only. The agents cannot accept liability for any inaccuracy or misdescription, and these particulars do not constitute any part of a contract and the purchasers should satisfy themselves as to each and every particular. No person in the employment of Fowlers Properties Ltd has the authority to make or give any representation or warranty whatsoever in relation to any property.

