

EVANS BROS.

QUALIFIED ESTATE AGENTS, VALUERS & AUCTIONEERS

Established in 1895

39 HIGH STREET, LAMPETER, CEREDIGION SA48 7BB

Tel: (01570) 422395 Fax: (01570) 423548 Website: www.evansbros.co.uk



Land part of Tynrheol Ffarmers, Ffarmers, Llanwrda, Carmarthenshire, SA19 8JW

Offers Over £150,000

***** Best and final offers to be received by 12 noon on Friday 26th June *****

A well located parcel of Approx. 19.5 acres of productive pasture land together with a useful building.
A renowned parcel of land divided into good sized enclosures, all dry, healthy pasture paddocks being well fenced together with a range of barns. and with river frontage.

Location



Attractively located in rural surroundings on the outskirts of the rural community of Ffarmers with basic amenities, some 6 miles from Lampeter, being the main service centre in the locality. The area is renowned as a productive agricultural locality and this parcel of land would suit those looking to purchase extra land for crop growing and to add to an existing farm as well as those looking for a starter unit having the benefit of the outbuilding in situ.

Land



The land is divided into good sized enclosures and is renowned as a dry parcel of inherently productive land. The land is well fenced with stream frontage to part.

Water

There is a private water supply to the land and the barns

Barns



Useful former Dutch hay barn range with central former silage pit 15' x 13'5". Side Lean-to 50' x 21'6" and further raised side lean-to 50' x 11'7" providing loose boxes.

Directions



From Lampeter take the A482 out passing Checkpoint Garage taking the next second left hand turning signposted Ffarmers, continue into the village and in the village take the 1st right hand turning onto a no-through road, follow this road past three properties and the land is opposite Tynrheol and be found on the left hand side of the road as identified by the agents for sale board.

PLEASE NOTE:

Interested parties are invited to submit their best and final offer for the purchase of the property in writing to the selling agents by 12 noon Friday the 26th June 2026.

These should be in a sealed envelope marked 'Land part of Tynrheol' or alternatively via email lampeter@evansbros.co.uk By entering this process the vendors or their representatives are not obliged to accept the highest or indeed any offer for the purchase of the property and reserve the right not to disclose any offers submitted.

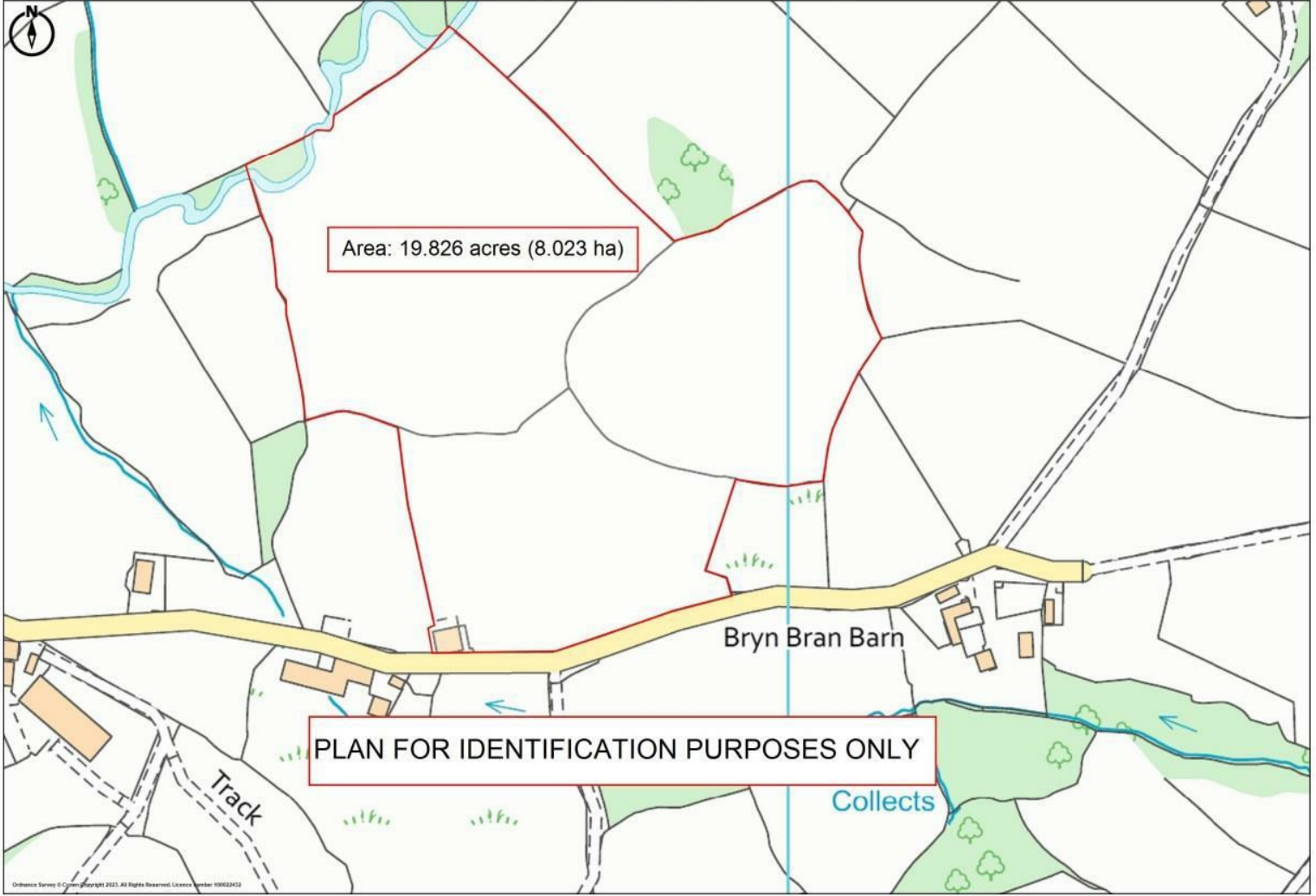

Energy Efficiency Rating

	Current	Potential
Very energy efficient - lower running costs		
(92 plus) A		
(81-91) B		
(69-80) C		
(55-68) D		
(39-54) E		
(21-38) F		
(1-20) G		
Not energy efficient - higher running costs		

England & Wales EU Directive 2002/91/EC

Environmental Impact (CO₂) Rating

	Current	Potential
Very environmentally friendly - lower CO ₂ emissions		
(92 plus) A		
(81-91) B		
(69-80) C		
(55-68) D		
(39-54) E		
(21-38) F		
(1-20) G		
Not environmentally friendly - higher CO ₂ emissions		

England & Wales EU Directive 2002/91/EC



5 NOTT SQUARE, **CARMARTHEN**,
CARMARTHENSHIRE, SA31 1PG
Tel: (01267) 236611



MART OFFICE, **LLANYBYDDER**,
CEREDIGION, SA40 9UE
Tel: (01570) 480444



1 MARKET STREET, **ABERAERON**,
CEREDIGION, SA46 0AS
Tel: (01545) 570462