



# JONES POTTS TAYLOR



## 13 Church Street

Atherton, Manchester, M46 9DE

£700 PCM

JonesPottsTaylor are pleased to present TO LET this self-contained COMMERCIAL ground floor premises. Situated on a prominent main road position in Atherton town centre, close to major network and transport links. This unit comprises of; entrance into a large open space/office with steps rising to an additional off centre area, two separate side rooms/offices, a split section kitchen and one W.C facility. Externally to the rear is an enclosed shared yard and both the front and rear entrances are secured by an electric roller shutter door. The office space has most recently been used as an administration office and previously a hairdressers.

Viewings are highly recommended and will be required under a viewing schedule.

### Viewing

Please contact our Jones Potts Taylor Office on 01942 368600 if you wish to arrange a viewing appointment for this property or require further information.

- Office Space
- Within Atherton Town Centre
- Internally Multiple Versatile Rooms
- Close Proximity Of Major Network And Transport Links - Security Electric Roller Shutter Doors
- Access From Both Front & Rear
- Security Electric Roller Shutter Doors

null 1 3 C



Floor Plan

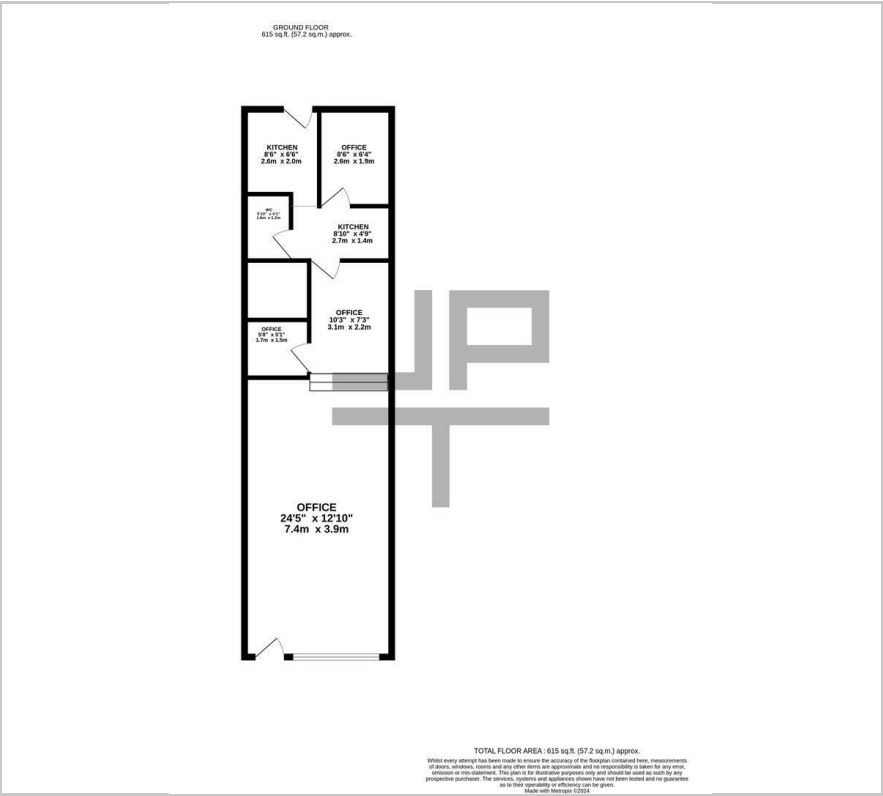

Area Map



Energy Efficiency Graph

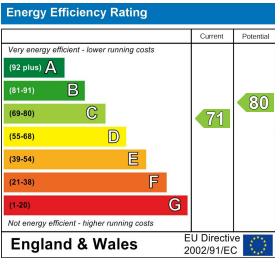

These particulars, whilst believed to be accurate are set out as a general outline only for guidance and do not constitute any part of an offer or contract. Intending purchasers should not rely on them as statements of representation of fact, but must satisfy themselves by inspection or otherwise as to their accuracy. No person in this firms employment has the authority to make or give any representation or warranty in respect of the property.