

A bungalow on a small development at Downham Crescent, Wymondham, NR18 0SF

Offers In Region Of £435,000

3 2 2



Moneyproperties proudly present this three bedroom detached bungalow for sale with no forward chain. The bungalow occupies a , the accommodation comprises three double bedrooms, including main bedroom with fitted wardrobes and a modernised en-suite shower room. There is also a family bathroom, a kitchen with adjoining utility room, an 18ft living room, and a separate dining room, providing flexible and comfortable living space.

Tenure: Freehold EPC: TBC Council Tax: E

Key Features

- Well presented three bedroom detached bungalow in popular location
- Kitchen with adjoining utility room
- Within walking distance of highly regarded local schools
- Easy access to town centre and its wealth of amenities
- Fully enclosed rear garden (approximately 25ft x 45ft) lawn and patio areas, a small wildlife pond, and an 8ft x 8ft storage shed
- Occupying a generous plot measuring approximately 100ft x 45ft
- Main bedroom with fitted wardrobes and a modernised en-suite shower room
- Regular bus and rail services offer convenient links to Norwich and Cambridge
- No forward chain
- See our full online listing for further details including flood risk, broadband speed and other material information.

GROUND FLOOR

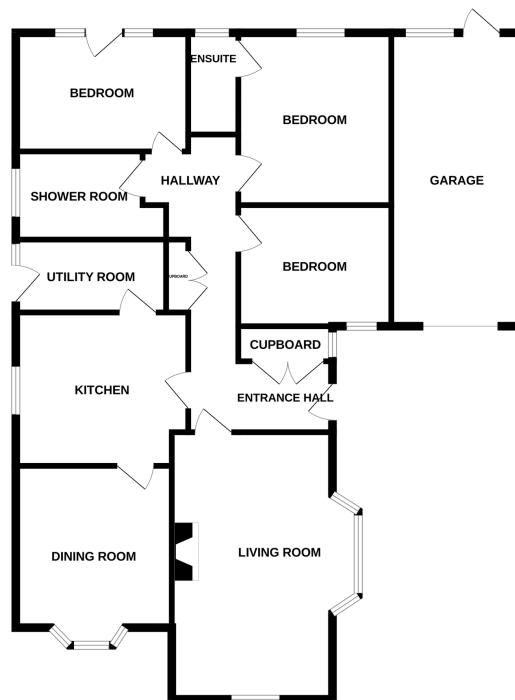

Whilst every attempt has been made to ensure the accuracy of the floorplan contained here, measurements of doors, windows, rooms and any other items are approximate and no responsibility is taken for any error, omission or mis-statement. The plan is for illustrative purposes only and should be used as such by any prospective purchaser. The services, systems and appliances shown have not been tested and no guarantee as to their quality or efficiency can be given.
Made with Metropix ©2025