



178 HIGH STREET

Bildeston | Suffolk



Chapman Sticks

178 HIGH STREET, BILDESTON, SUFFOLK, IP7 7EF

Hadleigh – 5.5 miles
Ipswich – 14 miles
Bury St Edmunds – 15 miles

- Entrance porch • Sitting room • Dining room • Snug • Kitchen • Utility • Cloakroom • Study • Three double bedrooms • Family bathroom • Garage • Potting shed / store • Gardens • Off road parking •

The Property

Originally two cottages, 178 High Street is located towards the edge of the picturesque Suffolk village of Bildeston. On entering the porch, a door leads through to the dining room with double doors opening into the snug giving the flexibility of using the space as a whole, or two separate rooms. Beyond lies a comfortable sitting room with exposed ceiling timbers, open fire with inset log burner and attractive stone hearth, and carved wooden surround. The well-equipped kitchen benefits from various base and eye level units combined with wood effect worktops and a double stainless steel sink. Plumbing for a dishwasher is provided, and the Rangemaster cooker is supplied by Calor gas. Adjacent is a useful Utility room providing plumbing for washing machine and tumble dryer and leads to the cloakroom and study.

On the first floor there is a spacious landing offering useful built-in floor to ceiling storage cupboards, and provides access to a partly boarded loft with ladder. Set around the landing are three double bedrooms. Bedroom 1 benefits from built in wardrobes, dressing table and drawers by Orwell Pine, and Bedroom 2 offers a built-in wardrobe and airing cupboard.

Outside immediately to the rear of the house lies a paved terrace which leads to a magnificent garden boasting an abundance of impressive plants/trees and shrubs and an enclosure for growing your own vegetables and fruits. The garden is set on a gentle incline offering far reaching countryside views. The layout of this beautiful garden has been cleverly designed providing different areas to enjoy different times of the day, with a summer house and decking area towards the very end of the garden making the most of the views, an Al Fresco dining area with gazebo, and a bar with BBQ. There are several outbuildings available to include a potting shed, store, two heated greenhouses and a single garage with driveway for two vehicles.

A CHARMING DETACHED PERIOD HOUSE WITH BEAUTIFUL GARDENS AND FAR REACHING COUNTRYSIDE VIEWS CLOSE TO THE HEART OF BILDESTON



Location

Located a short walk from the village centre, Bildeston is a popular mid-Suffolk village approximately 5 miles from the market town of Hadleigh. The village is well served by a thriving Post Office / General Stores, Doctor's Surgery, Primary School, the acclaimed Bildeston Crown, pubs, and the nearby Hollow Trees Farm Shop.

Services

Mains water, electricity and drainage are connected. Solar panels have been installed on the roof of the house to give maximum energy efficiency.

Local Authority and Council Tax

Babergh with Mid Suffolk District Council
Band D (2026)

EPC Rating

Current F (35). Potential B (87).



178 High St, Bildeston, IP7 7EF

Approximate Floor Area
Main House - 1287 sq. ft / 119.60 sq. m
Garage - 157 sq. ft / 14.59 sq. m
Outbuilding - 119 sq. ft / 11.09 sq. m

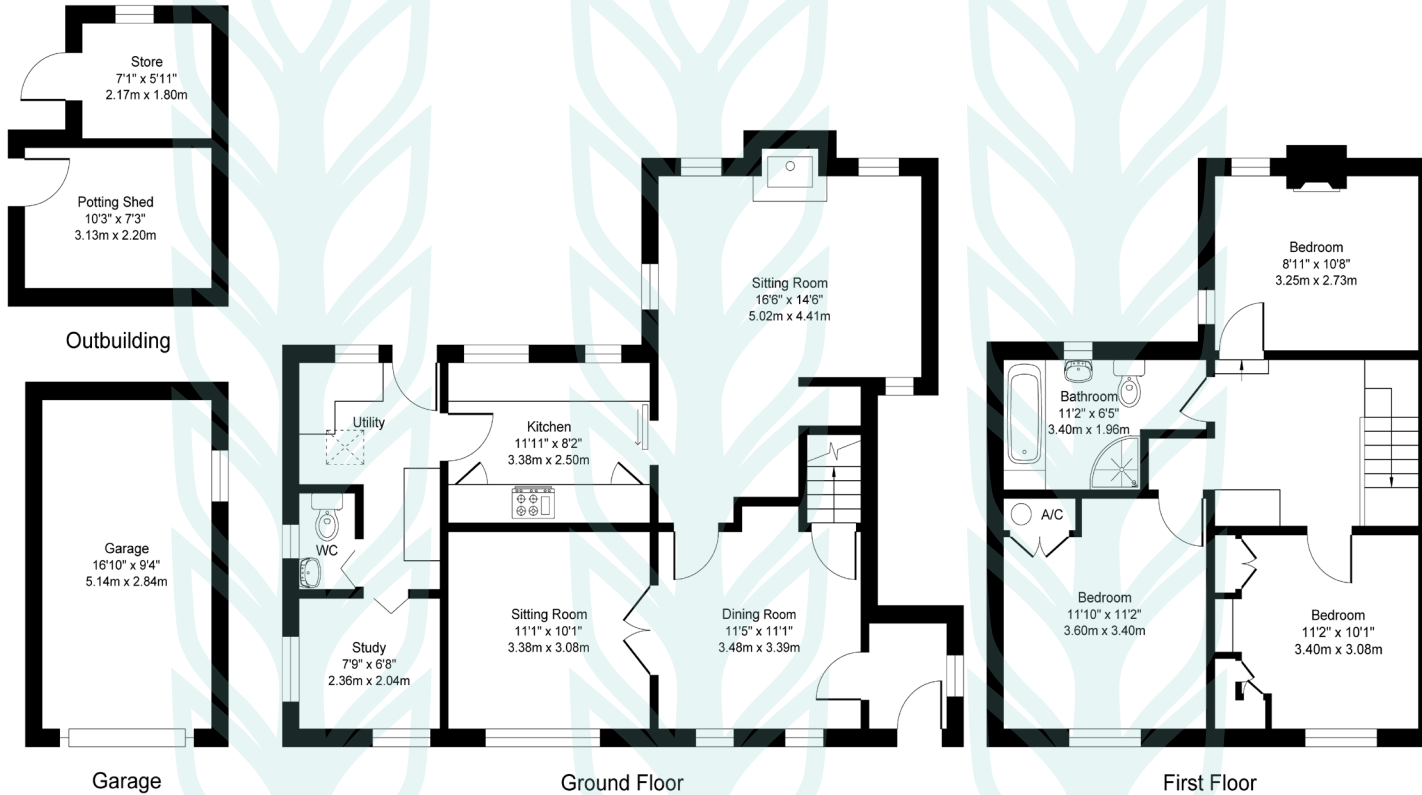

Illustration for identification purposes only, measurements approximate, not to scale. Copyright



Chapman Sticks

The Corn Exchange,
Market Place,
Hadleigh,
Suffolk,
IP7 5DN

info@chapmansticks.co.uk
www.chapmansticks.co.uk

01473 372 372

All enquiries:

Benedict Sticks
ben@chapmansticks.co.uk

Cleo Shiel
cleo@chapmansticks.co.uk

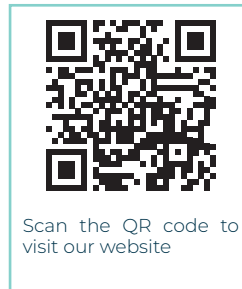

Scan the QR code to
visit our website

rightmove

OnTheMarket.com

Zoopla

PrimeLocation.com



IMPORTANT NOTICE
Chapman Sticks states these particulars are for general information only and do not constitute an offer or contract or part thereof. All descriptions, photographs and plans are for guidance only and should not be relied upon as statements or representations of fact. All measurements are approximate where stated. Any prospective purchaser must satisfy themselves of the accuracy of the information within these particulars by inspection or otherwise. Chapman Sticks does not have any authority to give any representations or warranties whatsoever in relation to this property (including but not limited to planning/building restrictions), nor can it enter into any contract on behalf of the client. We do not accept responsibility for any expenses incurred by prospective purchasers in inspecting properties which have been sold, let or withdrawn. If there is anything of particular importance to you, please contact us where we will endeavour to have any information or queries checked.