

HENDERSON CONNELLAN

ESTATE AGENTS

HENDERSON
CONNELLAN
WILSON & CO. ESTATE AGENTS
for sale
01536 417888

Harrington Road, Loddington NN14

"Planes, Trains and Automobiles"

"Planes, Trains and Automobiles"

If you are planning to refurbish a plane, train or automobile then you won't be short of space in the double width, double length garage which adjoins this lovely red brick end of mews cottage. The interior has a lovely feel with an entrance vestibule, living room enjoying the warmth of a wood burner and fitted kitchen/breakfast room. Upstairs there is a stylish bathroom and two bedrooms, the second bedroom with stunning countryside views as well as looking over Cransley Reservoir. Oil fired central heating and UPVC double glazing complete the inside. Outside there is an established fore garden set behind railings and a block paved courtyard and driveway leads to the huge garage. A Timber decked area is the perfect vantage point which to admire the view. Loddington enjoys a Church, primary school and lovely rural walks, yet Kettering and its mainline railway is a short drive away connecting with London St Pancras in under an hour. An exceptional home and setting.

Living Room - 4.44m x 3.63m (14'7" x 11'11")

Kitchen/Dining Room - 4.67m x 2.29m (15'4" x 7'6")

Bedroom One - 3.76m x 3.3m (12'4" x 10'10")

Bedroom Two - 3.73m x 2.29m (12'3" x 7'6")

Bathroom - 2.79m x 1.68m (9'2" x 5'6")

- Village location
- Off road parking
- Huge Garage
- Gorgeous countryside views
- Oil fired central heating
- Two double bedrooms
- COUNCIL TAX: B
- EPC RATING: E

Tenure: Freehold





Ground Floor
Approx. 77.5 sq. metres (834.7 sq. feet)

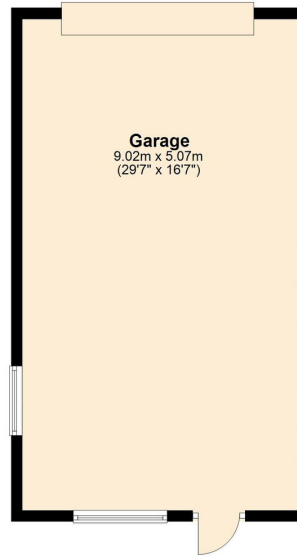

First Floor
Approx. 32.3 sq. metres (348.2 sq. feet)

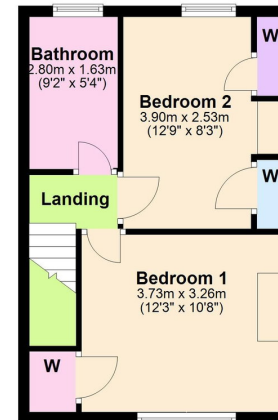
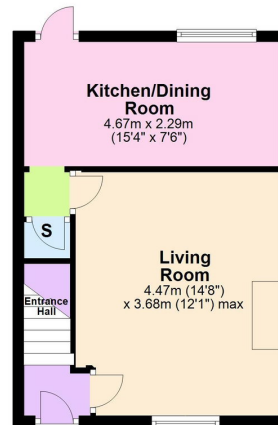

Total area: approx. 109.9 sq. metres (1182.9 sq. feet)