





Borderside
Yateley, GU46 6LJ

£625,000 Guide Price

Property Details

 4 bedrooms

 2 baths

 EPC Rating TBC

 1253 sqft

 Station Name (0.0 miles)

- Four double bedrooms
- Large living room
- Modern dining room
- Recently refitted kitchen
- Newly fitted kitchen, cloakroom and bathroom
- Modern en suite shower room
- Driveway leading to single garage
- Landscaped rear garden
- Near to Yateley village, shops and amenities

A beautifully presented home located in this popular road in Yateley and offering a modern refitted kitchen as well as very newly fitted cloakroom and bathroom and a modern en suite shower room. The house is very smartly presented and nicely decorated throughout and offers a spacious living room and dining modern dining room. Upstairs benefits from four double bedrooms. To the front of the house is driveway parking leading to a single garage and to the rear of the house is a low maintenance landscaped rear garden. It is conveniently located for Yateley village where there good local shops and amenities as well as a number of pubs. There are good local schools nearby and attractive countryside close by.



Property Details

Borderside

Approximate Gross Internal Area = 116.4 sq m / 1253 sq ft (excludes garage)

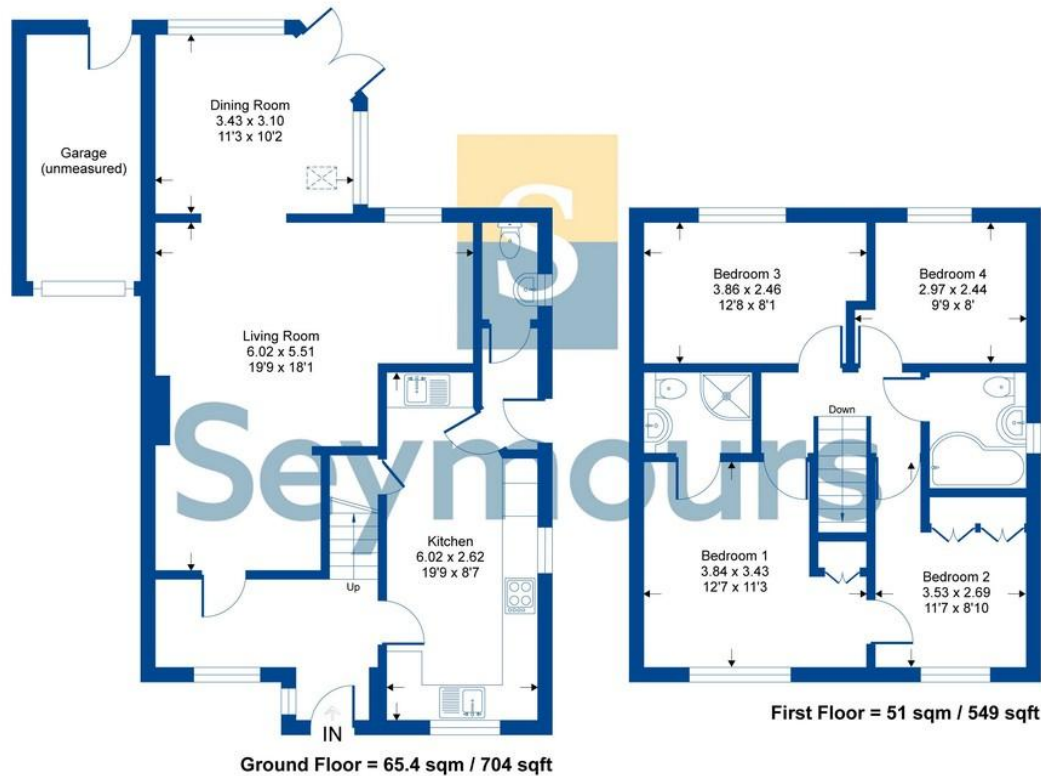

Whilst every attempt has been made to ensure the accuracy of the floor plan contained here, measurements of doors, windows, rooms and any other items are approximate and no responsibility is taken for any error, omission or mis-statement. This plan is for illustrative purposes only and should be used as such by any prospective purchaser.



Seymours Blackwater Office 6 Kings Parade, 34 London Road, Blackwater, Camberley, Surrey, GU17 9AA
01276 534100 / james@seymours-blackwater.co.uk / seymours-estates.co.uk

The information contained in these Sales Particulars does not form part of any contract neither is any warranty given or implied by Seymours or their clients as to the accuracy of measurements of details stated. Every effort is made to ensure that our Sales Particulars are correct and reliable. We do not test service, systems and appliances and we are unable to verify they are in working order.