

109, Heath Way, Erith DA8 3LZ  
£900 PCM



First floor studio conversion flat close to local shops and transport links in Northumberland Heath, comprising a lounge / bedroom, kitchen and separate bathroom. The property is available August 2026.

## Heath Way, Erith, Kent, DA8

Approximate Gross Internal Area = 39.7 sq m / 428 sq ft

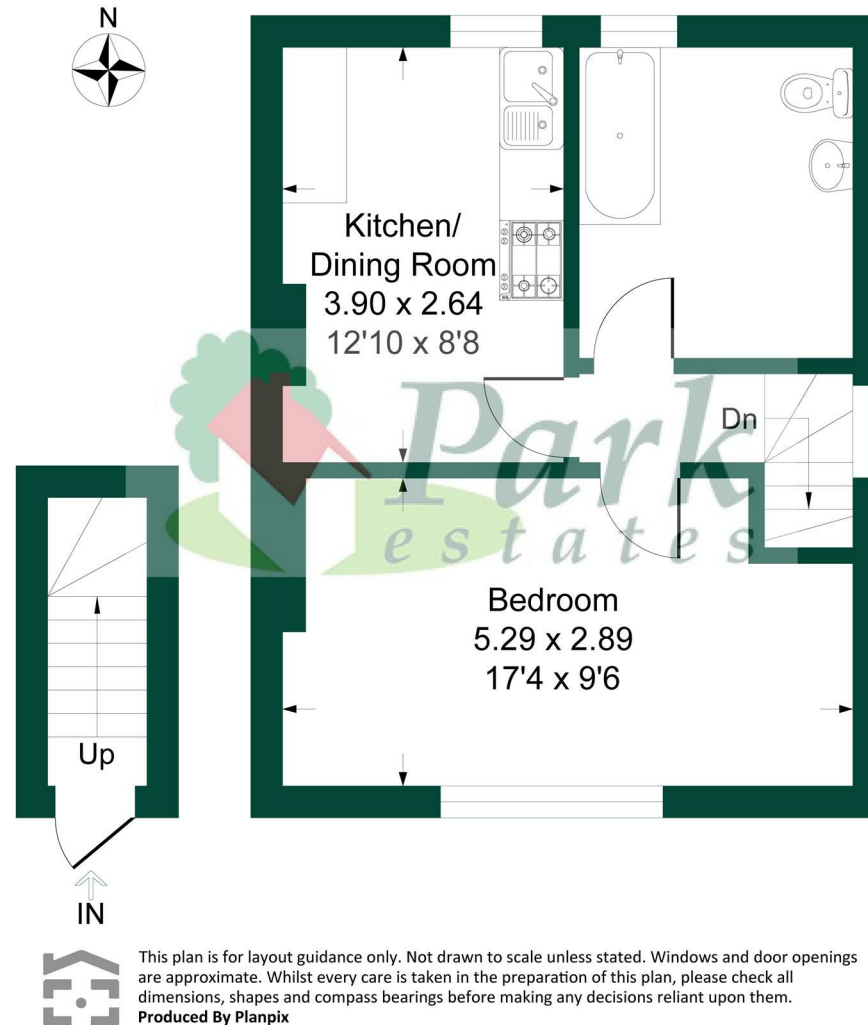

Local Authority:  
Council Tax Band:



# 01322 553322

60-62 High Street, Bexley, Kent DA5 1AH

bexley@parkestates.co.uk  
www.parkestates.co.uk

Every care has been taken with the preparation of details, but accuracy is in no way guaranteed. These particulars do not constitute a contract and are issued and accepted on the express understanding that all negotiations will be conducted through Park Estates. The seller does not make or give, nor do we or our employees have any authority to give a representation or warranty in relation to the property. Please contact this office before viewing the property. If there is any point which is of particular importance to you, we will be pleased to check the information for you and confirm that the property remains available. This is particularly important if you are contemplating travelling some distance to view the property. We would strongly recommend that all the information that we provide about the property is verified by yourself on inspection and also by your conveyancer, especially where statements have been made by us to the effect that the information provided by us has not been verified.