



Wallace Drive

, Wickford, SS12 9LZ

Asking Price £325,000

Cowling & Payne are delighted to market this 2 bedroom semi-detached house conveniently situated on the popular Wick Meadows Estate.

The home features a welcoming reception room, perfect for relaxing or entertaining guests, alongside an additional reception room which could be utilised as a dining room/home office or playroom. Both reception rooms offer direct access out to the rear garden. There is also a convenient wc situated on the ground floor.

On the first floor, there is two double bedrooms and a 3 piece bathroom.

Off-street parking is available, providing a secure and convenient solution for your vehicle.

Another feature of this home is its low-maintenance garden, offering outdoor space without the burden of extensive upkeep.

Situated conveniently near Silva Island Way, residents will find a variety of shops and a local doctor's surgery within easy reach, making daily errands and healthcare access straightforward.

In summary, this semi-detached house on Wallace Drive presents an excellent opportunity for those looking for a comfortable and practical home in Wickford. With its spacious interiors, low-maintenance garden, and proximity to local conveniences, it is a property not to be missed.

- TWO BEDROOM SEMI DETACHED HOUSE
- GROUND FLOOR WC
- CHAIN FREE
- 2 RECEPTION ROOMS
- LOW MAINTENANCE REAR GARDEN
- OFF STREET PARKING
- NEARBY TO LOCAL AMENITIES
- NEARBY TO LOCAL SCHOOLS
- COUNCIL TAX BAND - D
- EPC - D

Viewing

Please contact our Sales Office on 01268 730707 if you wish to arrange a viewing appointment for this property or require further information.

 2
  1
  2
  D

Floor Plan

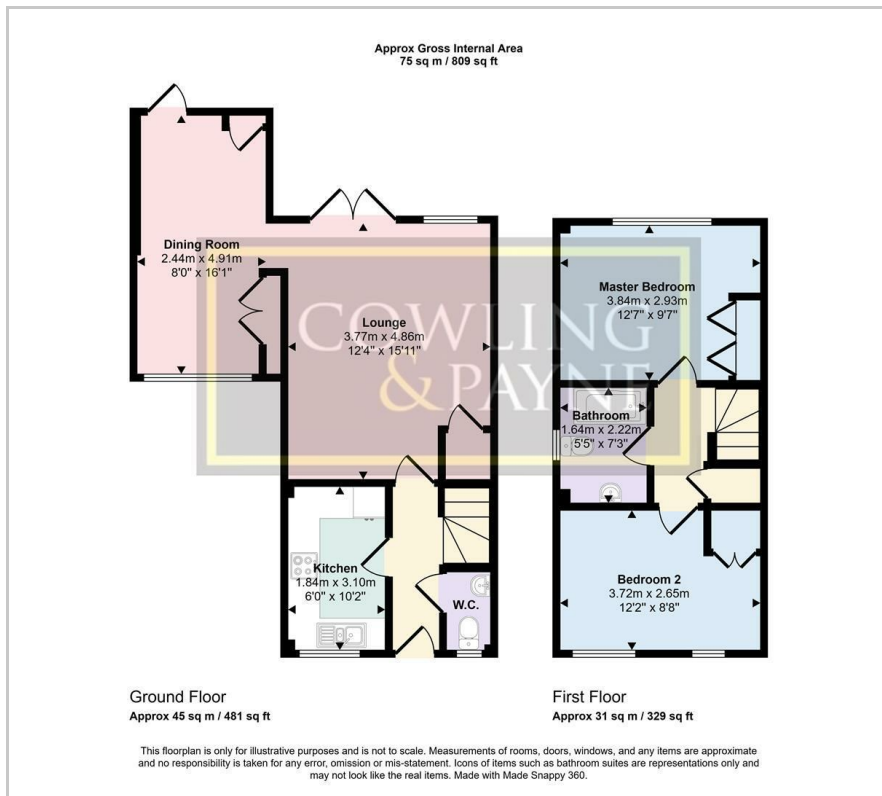

Area Map



Energy Efficiency Graph

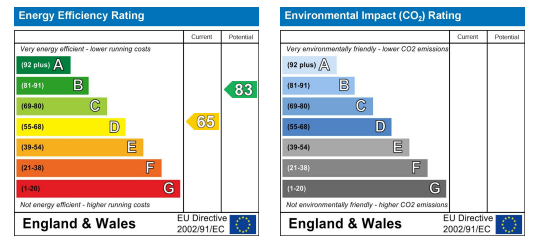

These particulars, whilst believed to be accurate are set out as a general outline only for guidance and do not constitute any part of an offer or contract. Intending purchasers should not rely on them as statements of representation of fact, but must satisfy themselves by inspection or otherwise as to their accuracy. No person in this firm's employment has the authority to make or give any representation or warranty in respect of the property.