



Old Dairy Way, Lydney, GL15 6NN

£315,000



£315,000

The Bewdley Old Dairy Way

Lydney, GL15 6NN

- 3 Bedroom Home
- Separate Living Room
- Family Bathroom
- Off-Road Parking
- Open Plan Kitchen / Dining
- Downstairs Cloakroom
- En-suite to Bedroom 1
- Energy Efficient Materials Throughout

The Bewdley is a three bedroom, two bathroom family home with parking for two cars that has everything a modern family could need. With an open plan kitchen/dining room, a spacious living room which opens out to the garden and master bedroom with en-suite.



House Specification:

Kitchen:

Appliances:

Bedrooms:

Bathrooms:

Heating & Energy Efficiency:

Electrical:

Internal Finishes:

External Finishes:

Please note:

Agents Note:

GDPR:

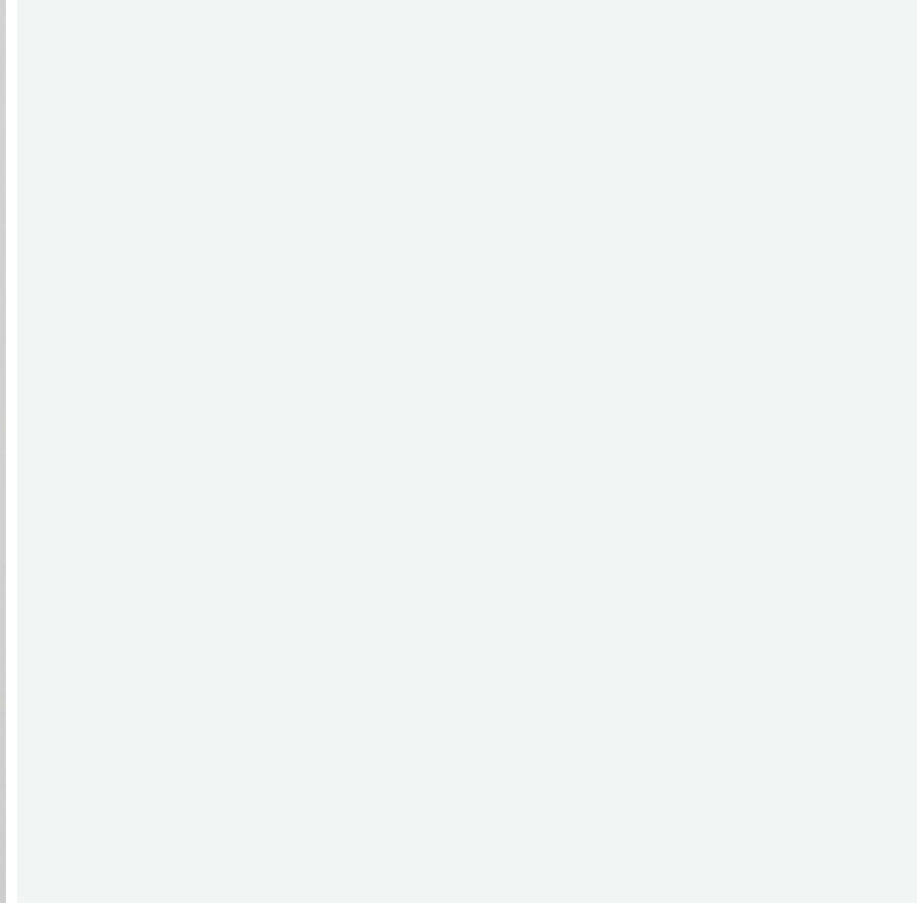

Directions





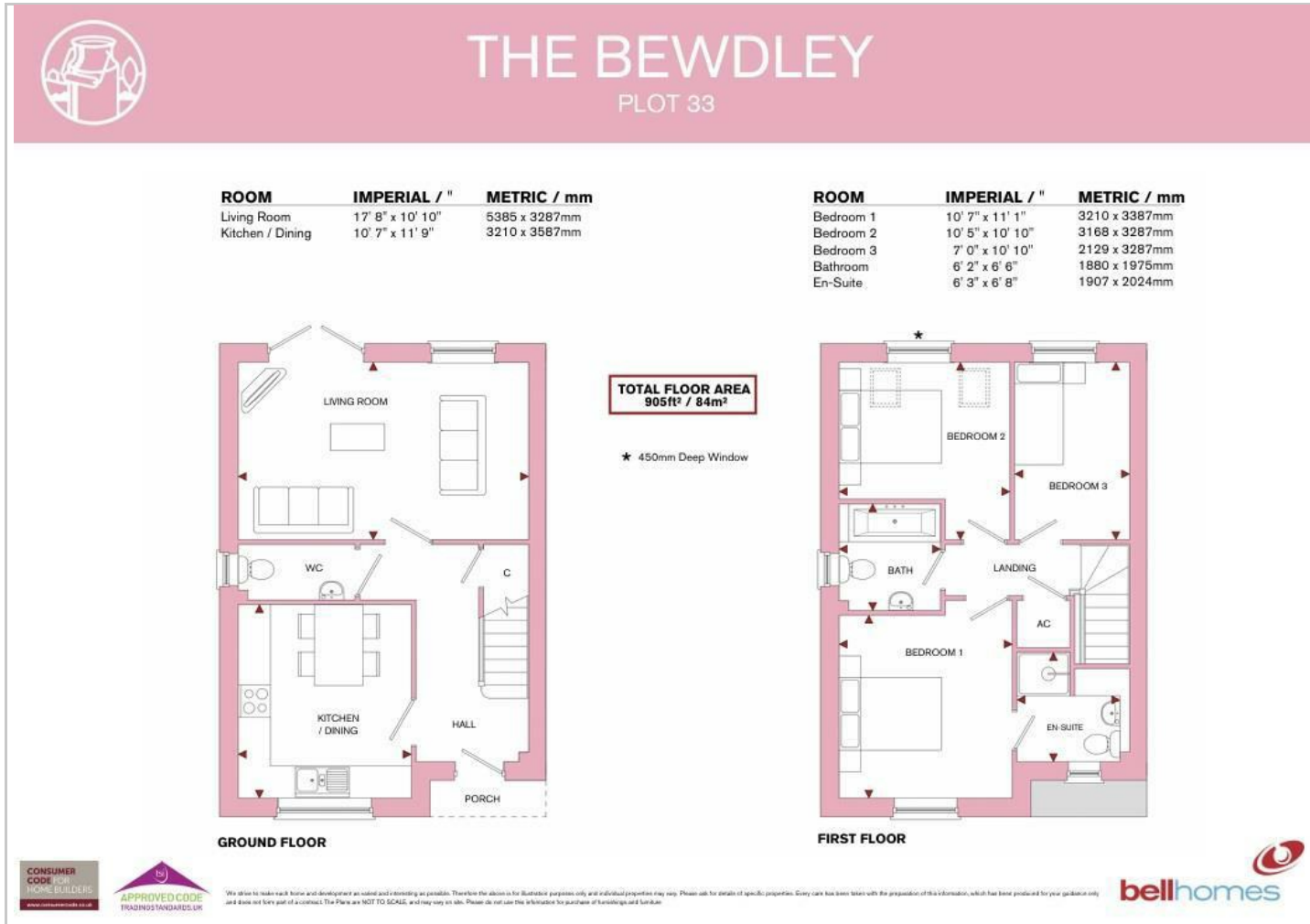

Floor Plans

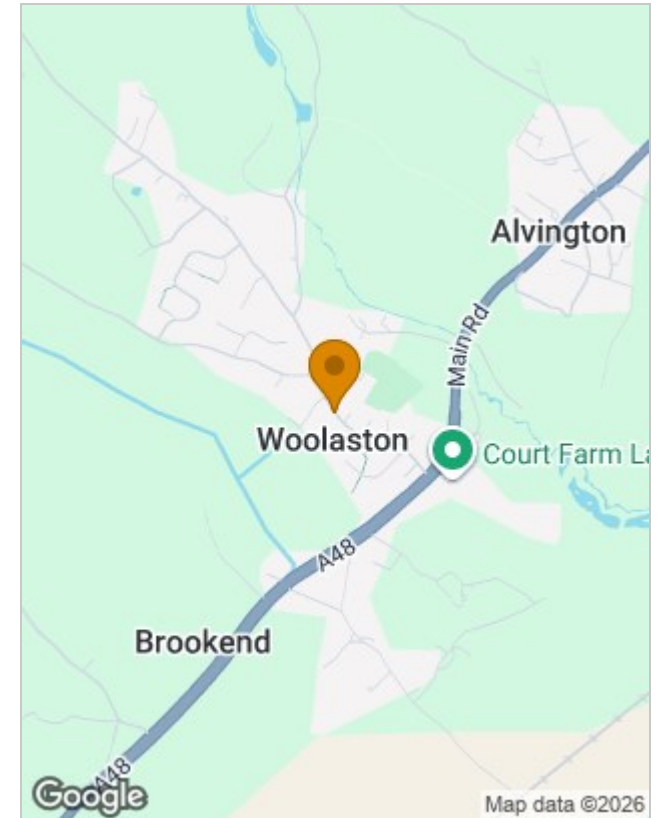

Location Map



Energy Performance Graph

Energy Efficiency Rating		
	Current	Potential
Very energy efficient - lower running costs		
(92 plus) A		
(81-91) B		
(69-80) C		
(55-68) D		
(39-54) E		
(21-38) F		
(1-20) G		
Not energy efficient - higher running costs		
England & Wales	EU Directive 2002/91/EC	

Viewing

Please contact our Coleford Office on 01594 835751 if you wish to arrange a viewing appointment for this property or require further information.

The particulars are set out as a general outline only for the guidance of intended purchasers or lessees, and do not constitute, any part of a contract. Nothing in these particulars shall be deemed to be a statement that the property is in good structural condition or otherwise nor that any of the services, appliances, equipment or facilities are in good working order. Purchasers should satisfy themselves of this prior to purchasing.

14 St John Street, Coleford, Gloucestershire, GL16 8AR
Tel: 01594 835751 Email: coleford@deanestateagents.co.uk www.deanestateagents.co.uk

