



Beaumont Street, W1G

£750,000

A two double bedroom apartment located in central location behind Maylebone High Street. Overlooks a private residents garden and has a long lease.

Located just moments from the amenities of Marylebone High Street and Regents Park. Local stations are Baker Street, Regents Park and Bond Street.

Features

Two Double Bedrooms
Bright Reception - Dining Room
Separate Modern Kitchen
Passenger Lift
Long Lease To 2144
Residents Gardens

Beaumont Street, London, W1G

Lower Ground Floor

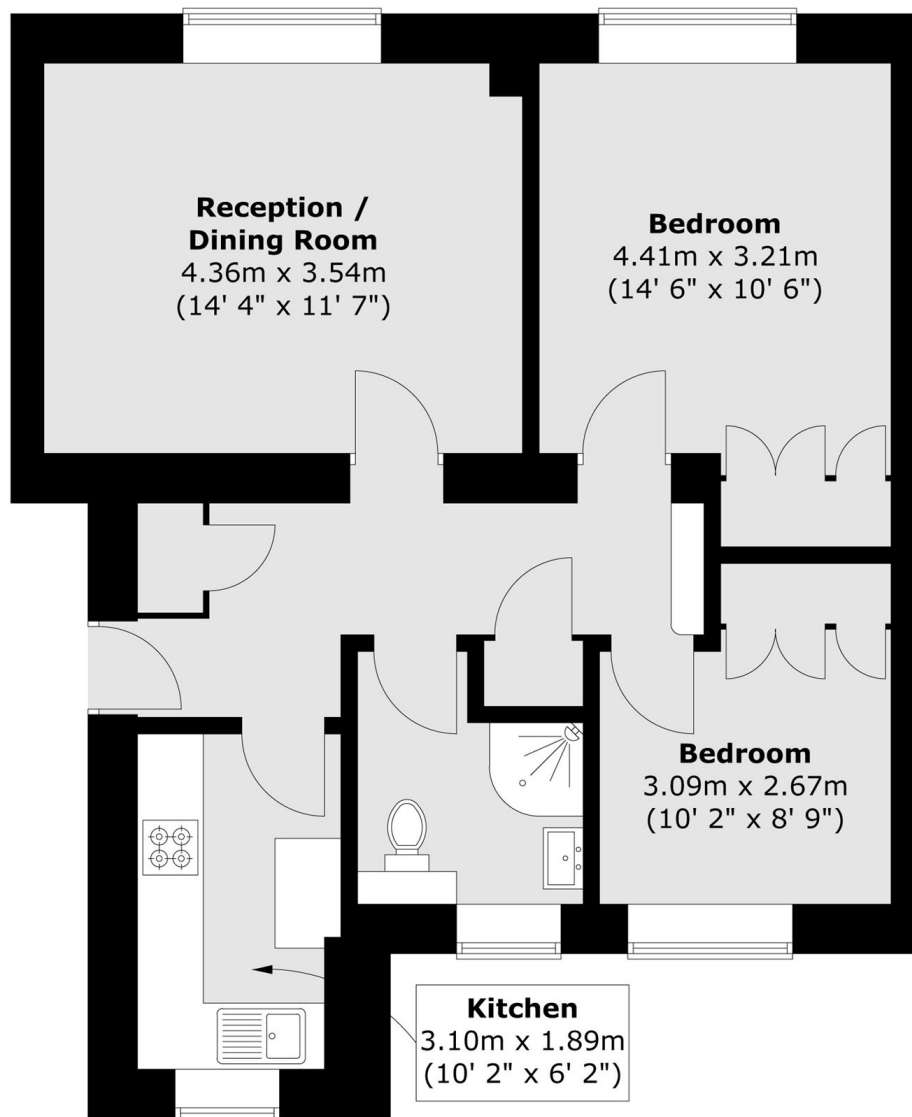

Total area (approx.) : 58.1 sq. m (625 sq. ft)