



## Orchid Gardens, TW3

£260,000

A spacious two bedroom second floor apartment set within the popular Orchid Gardens development in Hounslow. The property offers a generous reception room with a Juliette balcony, a separate fitted kitchen, and two well-proportioned bedrooms. Further benefits include ample storage throughout, a long lease and excellent transport links in and out of Central London.

This property enjoys a superb location just a short walk from Hounslow High Street, offering an array of shops, cafes, and restaurants. Excellent transport links are within easy reach, with Hounslow Central station nearby, providing direct routes into Central London and Heathrow Airport.

### Features

- Two Bedrooms
- Lift Access
- Long Lease Remaining
- Close To Amenities
- No Onward Chain
- Second Floor Apartment

# Orchid Gardens, Hounslow, TW3

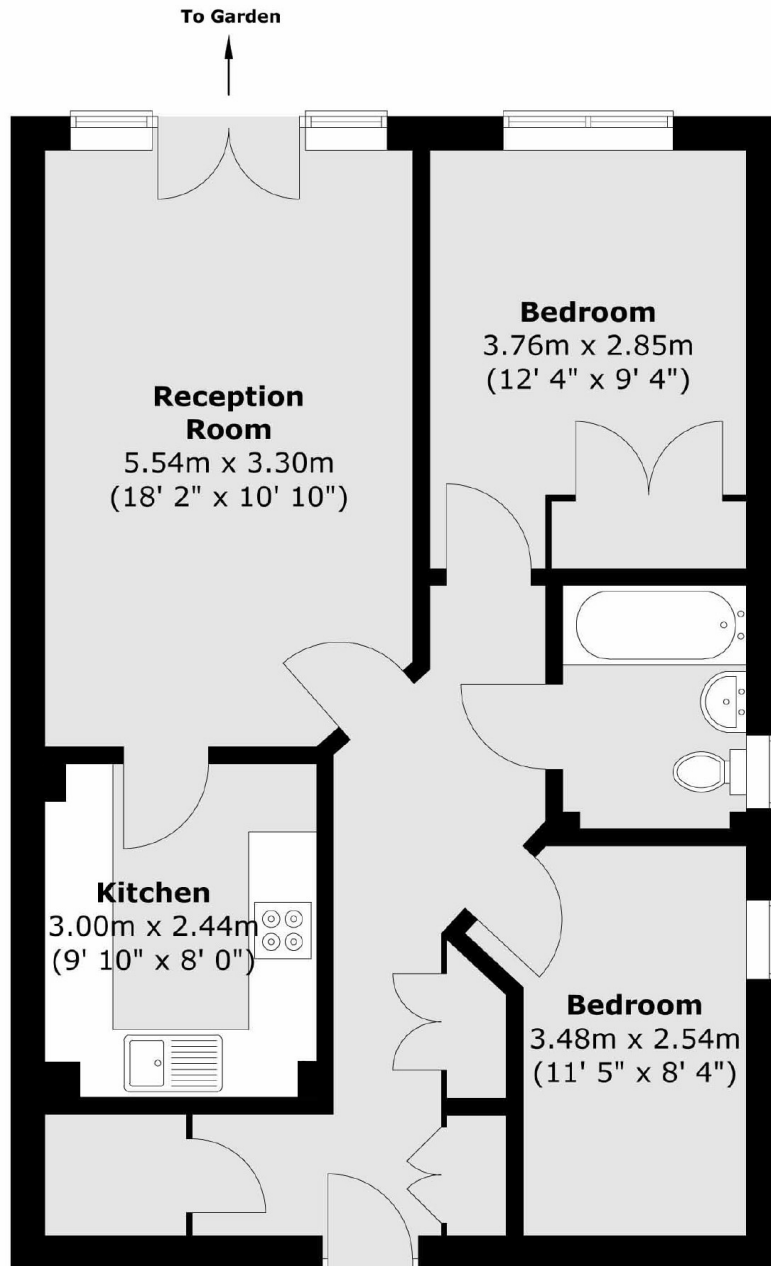

Total area (approx.) : 61.9 sq. m (666 sq. ft)

## Dexters

Isleworth  
568 London Road  
Isleworth  
TW7 4EP  
Sales  
020 8560 1177

Energy Rating: C. We aim to make our particulars both accurate and reliable. However they are not guaranteed; nor do they form part of an offer or contract. If you require clarification on any points then please contact us, especially if you're traveling some distance to view. Please note that appliances and heating systems have not been tested and therefore no warranties can be given as to their good working order.

 **RICS** Regulated  
Estate Agent  
and Letting Agent

[dexters.co.uk](http://dexters.co.uk)