

Hampermill Lane

Watford • Middlesex • WD19 4NX
PCM: £4,500 PCM



coop
est 1986

This spacious and attractive detached residence has been newly refurbished and is set behind a sweeping carriage driveway, offering ample off-street parking. Upon entering, you are welcomed by a bright hallway with wooden flooring and a guest cloakroom.

The ground floor features a generous open-plan living and dining area with French doors opening onto the rear garden, ideal for entertaining. There is also a second reception/dining room and a beautifully fitted, stylish kitchen/breakfast room, complete with high-gloss units, a central island, Miele appliances, and luxurious marble worktops. A separate TV room completes the ground floor accommodation.

Upstairs, the principal bedroom benefits from fitted wardrobes and a contemporary en suite shower room. Three further bedrooms are served by a

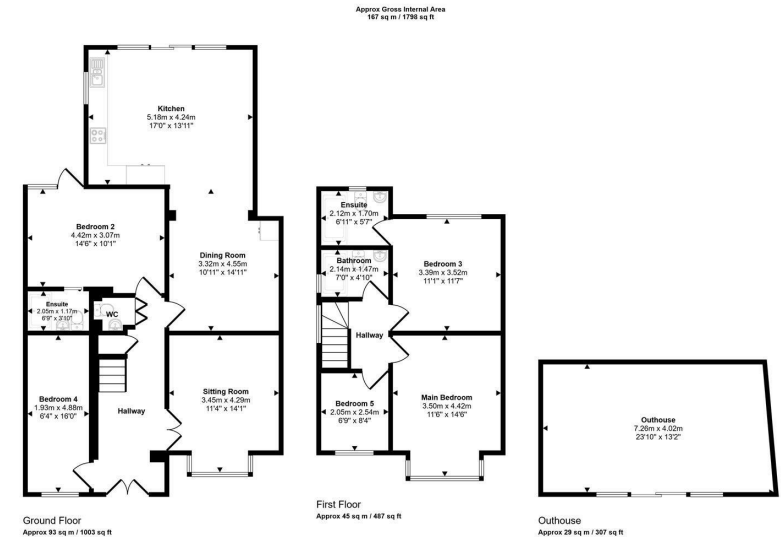

This floorplan is only for illustrative purposes and is not to scale. Measurements of rooms, doors, windows, and any items are approximate and no responsibility is taken for any errors, omissions or mis-statements. Icons of items such as bathroom suites are representations only and may not look like the real items. Made with Made Spraggy 360.



NEWLY REFURBISHED

Detached

Off street parking

Close to Northwood HQ

Four spacious bedrooms

Modern bathrooms

Close to Bushey Station

Outhouse

Unfurnished

Available Immediately

Available Date

1st August 2026

0208 017 6000

18 Bridge Street, Pinner,
Middlesex, HA5 3JF

pinner@coopersresidential.co.uk

CoopersResidential.co.uk

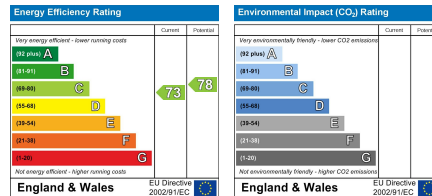

Important Notice: These particulars, whilst believed to be accurate are set out as a general outline only for guidance and do not constitute any part of an offer or contract. Intending purchasers should not rely on them as statements or representation of fact, but must satisfy themselves by inspection or otherwise has the authority to make or give any representation or warranty in respect of the property.

coopers
est 1986