



Velthouse Lane

Longhope, GL17 0AD

£365,000



*** VIRTUAL TOUR AVAILABLE *** *** NO ONWARD CHAIN ***

Dean Estate Agents are pleased to offer "For Sale" this individual detached bungalow sitting in grounds of approximately 1/3rd of an acre and enjoying a rural aspect and countryside views. The property is in need of considerable up-dating but offers great potential. Planning permission was granted in 2020 (now lapsed) to demolish the existing bungalow and replace with a new build. To the front of the property is ample off road parking with additional driveway to the rear providing space for plant machinery/caravan etc. together with a large block built outbuilding, ideal for someone working from home or wanting space for a hobby, there is also a detached garage.



Entrance Hall :

4'1" x 12'9" (1.25 x 3.90)

Glazed door to front, loft access.

Living Room :

12'1" x 21'9" (3.70 x 6.64)

Window to front, wood burning stove, door to hall and kitchen.

Kitchen / Diner :

19'9" x 10'0" (6.03 x 3.06)

Needs re-fitting, base units, sink unit, plumbing for washing machine and dishwasher, pantry, door and window to front.

Conservatory :

12'4" x 11'3" (3.77 x 3.43)

Overlooking the gardens and open fields beyond, door to outside.

Bathroom :

9'3" x 5'9" (2.83 x 1.76)

Accessed from the kitchen. In need of re-fitting, currently having a 3 piece suite.

Bedroom 1 :

9'9" x 9'6" (2.98 x 2.92)

Window to front aspect.

Bedroom 2 :

11'9" x 9'4" (3.59 x 2.85)

Window to rear aspect.

Inner Hall :

6'9" x 8'6" (2.07 x 2.61)

Window to conservatory.

Underneath the bungalow :

Two Rooms one measuring approximately 3.2 x 2.5 (10'6 x 8'2) and the other measuring 3.23 x 2.47 (10'7 x 8'1)

Outside :

The property stands in a generous plot with the gardens to the rear, laid to lawn with a number of shrubs and trees. Large outbuilding/workshop/storage/carport with the addition of a detached garage and a separate steel frame. Large vehicular twin gates gives access to the driveway.

To the front there is space to park up to 4 cars.



Dean Estate Agents Ltd have prepared the information within this website/brochure with infinite care and without a guarantee of accuracy. Before you act upon any information provided, we request that you satisfy yourself about the completeness, accuracy, reliability, suitability, or availability with respect to the website or the information, products, services, or related graphics contained on our website for any purpose.

These details do not constitute any part of any Offer, Contract or Tenancy Agreement. Photographs used for advertising purposes may not necessarily be the most recent photographs. All photographic images are under the ownership of Dean Estate Agents Ltd and therefore Dean Estate Agents retain the copyright.
 Tenanted Property – we are not always able to show the most recent condition of a property due to tenants' privacy and may choose to show the photographs of the property when it was last vacant to at least allow clients some idea of the internal condition at that time.

Energy Performance Certificates are supplied to us via a third party and we do not accept responsibility for the content within such reports.
 As with leasehold property or new build development sites, you are likely to be responsible for a contribution to management charges and/or ground rent or a contribution to the development service charge. Please enquire at the time of viewing. You may also incur fees for items such as leasehold packs and, in addition, you will also need to check the remaining length of any lease before you complete a mortgage application form. You must therefore consult with your legal representatives on these matters at the earliest opportunity before making a decision to purchase or incurring costs.

Measurements: Great care is taken when measuring, but measurements should not be relied upon for ordering carpets, equipment etc.
 The Laws of copyright protect this material. Dean Estate Agents is the owner of the copyright. This property sheet forms part of our database and is protected by the database right and copyright laws.

Equipment: Dean Estate Agents have not tested the equipment or any central heating system mentioned in these particulars and the purchaser is advised to satisfy themselves as to the

Road Map



Hybrid Map



Terrain Map



Floor Plan

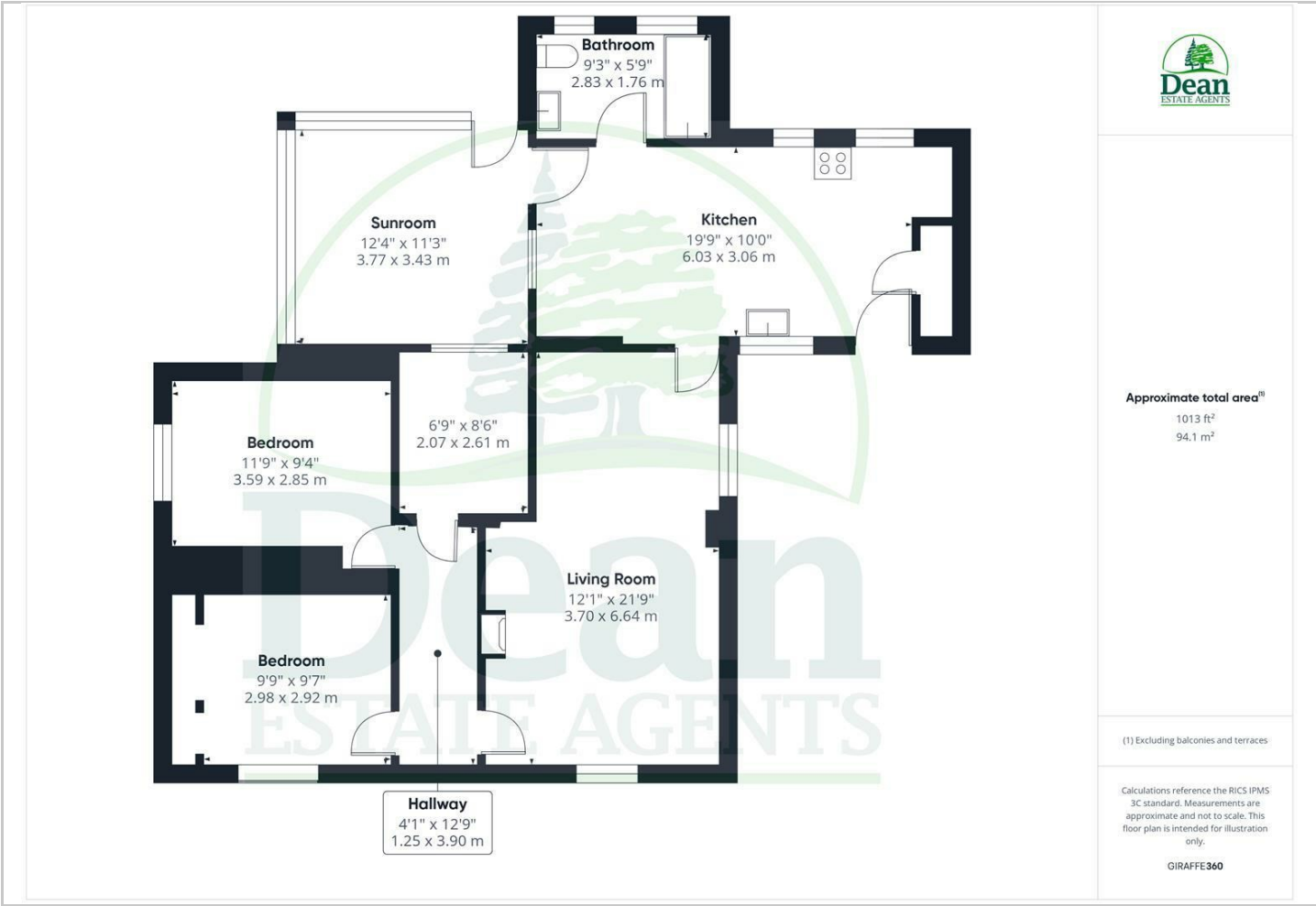

Viewing

Please contact our Cinderford Office on 01594 825574 if you wish to arrange a viewing appointment for this property or require further information.

Energy Efficiency Graph

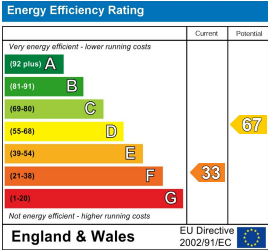

These particulars, whilst believed to be accurate are set out as a general outline only for guidance and do not constitute any part of an offer or contract. Intending purchasers should not rely on them as statements of representation of fact, but must satisfy themselves by inspection or otherwise as to their accuracy. No person in this firms employment has the authority to make or give any representation or warranty in respect of the property.

