



10 Richmond Court, Farmhill, Douglas, Isle of Man, IM2 2NU
Asking Price £249,500

- Ground Floor Apartment Within Quiet Purpose-Built Residential Development
- Two Generous Double Bedrooms With Rear Facing Quiet Aspect
- Recently Refurbished With Modern Kitchen Bathroom And Flooring
- Gas Combi Boiler And uPVC Double Glazing Throughout
- Spacious Open Plan Living Area With Feature Bay Window
- Two Allocated Parking Spaces Providing Convenience And Security



Located within easy reach of a wide range of local amenities, 10 Richmond Court presents an excellent opportunity for comfortable and convenient living.

This immaculately presented two-bedroom apartment occupies a ground-floor position within a well-maintained purpose-built development and enjoys a peaceful setting with pleasant outlooks. The property has been extensively refurbished within the last five years, including the installation of a modern kitchen, new windows an updated bathroom, and new flooring throughout, creating a stylish and move-in-ready home.

At the centre of the home is the spacious open-plan living and dining area, a bright and inviting space designed for both relaxation and entertaining. Large windows allow natural light to fill the room, while a striking feature bay window creates additional floor space and enhances the overall sense of openness.

The contemporary kitchen has been thoughtfully updated and fitted with a range of modern appliances, including an induction hob, offering both style and functionality. The kitchen is complemented by a gas combi boiler, ensuring efficient heating and reliable hot water throughout.

Both bedrooms are generously sized doubles and are positioned to the rear of the property, providing quiet and comfortable spaces for rest. Each room benefits from ample storage space, making them practical as well as inviting. The apartment is served by a bright, modern family bathroom featuring updated flooring and contemporary finishes that match the overall quality of the refurbishment.

Externally, the property benefits from renewed uPVC double glazing throughout and includes two allocated parking spaces, providing additional convenience and security for residents.

Ideal for first-time buyers, downsizers, or investors, 10 Richmond Court represents a rare opportunity to acquire a well-presented home that offers a balanced combination of style, comfort, and practicality in a popular residential location











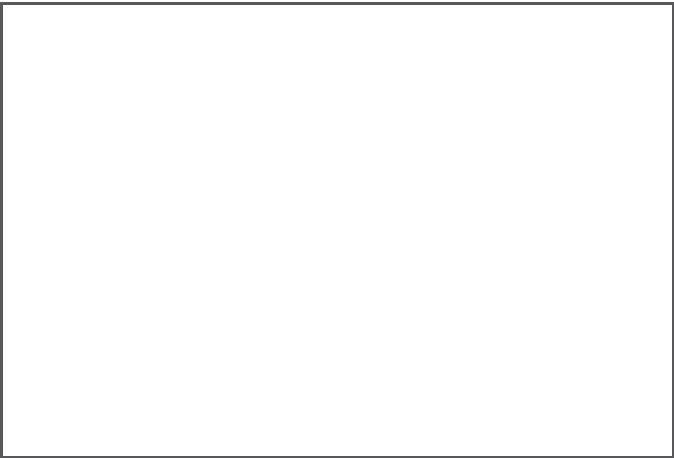

10 Richmond Court, Farmhill, Douglas, Isle of Man, IM2 2NU



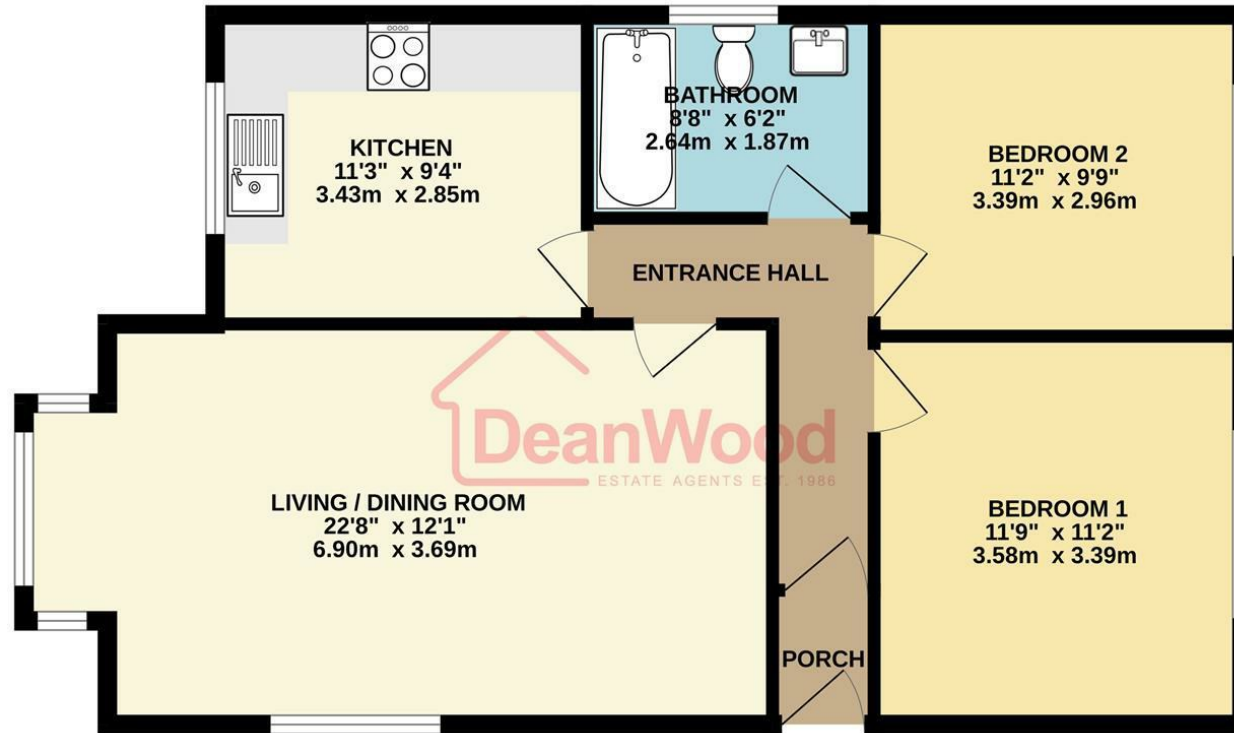

GROUND FLOOR
723 sq.ft. (67.2 sq.m.) approx.

TOTAL FLOOR AREA : 723 sq.ft. (67.2 sq.m.) approx.

Not to scale-for identification purposes only
Made with Metropix ©2026

DOUGLAS

37 VICTORIA STREET
DOUGLAS
ISLE OF MAN IM1 2LF

T 01624 620606

F 01624 677363

E info@deanwood.co.im

CASTLETOWN

COMPTON HOUSE
9 CASTLE STREET CASTLETOWN
ISLE OF MAN IM9 1LF

T 01624 825995

F 01624 825996

E castletown@deanwood.co.im

RAMSEY

LEZAYRE HOUSE
87 PARLIAMENT STREET
RAMSEY ISLE OF MAN IM8 1AQ

T 01624 816111

F 01624 816588

E ramsey@deanwood.co.im

These particulars are for information purposes only. They do not constitute or form any contract nor should any statement contained herein be relied upon as a representation of fact. Neither the vendor nor DeanWood Agencies Limited ('the firm'), nor any officer or employee of the firm accept liability or responsibility for any statement contained herein. The vendor does not by these particulars, nor does the firm, nor does any officer or any employee of the firm have any authority to make or give any representation or warranty whatsoever as regards the property or otherwise. It is the sole responsibility of any person interested in the property described in these particulars to make all proper enquiries and searches to verify the description of the property and all other particulars herein.

FOR MORE PROPERTIES VISIT OUR WEBSITE @ deanwood.im