



LAMB & CO

Call us on 01255 422 240

Inspired by property, driven by passion.



IPSWICH ROAD, HOLLAND-ON-SEA, CO15 5DT

GUIDE PRICE £400,000

**** GUIDE PRICE £400,000 - £425,000 **** An exceptionally well presented, three/four bedroom detached house located in the sought after area of Holland-on-Sea. In recent years the property has been completely renovated to a high standard and offers generous living space and a landscaped, West facing garden.

- Three/Four Bedrooms
- Completely Refurbished
- Holland-on-Sea
- Ground Floor WC & Utility Room
- Low Maintenance, West Facing Garden
- EPC E*
- Off-Road Parking
- Bedroom 4/Playroom



Sales | Lettings | Commercial | Land & New Homes
sales@lambandcoproperty.co.uk | www.lambandcoproperty.co.uk

Accommodation comprises with approximate room sizes as follows:

Entrance door to:

ENTRANCE HALL



LOUNGE

13'4 x 11'4 (4.06m x 3.45m)



BEDROOM FOUR/PLAY ROOM

15'5 x 7' (4.70m x 2.13m)



UTILITY ROOM

9'6 x 7' (2.90m x 2.13m)



WC



KITCHEN/DINER

20' x 13'4 (6.10m x 4.06m)



BEDROOM TWO

15'8 x 9' (4.78m x 2.74m)



FIRST FLOOR

LANDING

BEDROOM ONE

15'9 x 13' (4.80m x 3.96m)



BEDROOM THREE

15'8 x 9' (4.78m x 2.74m)



BATHROOM

6'5 x 6'2 (1.96m x 1.88m)



OUTSIDE

FRONT

REAR



ANTI-MONEY LAUNDERING REGULATIONS 2017
- In order to comply with regulations, prospective purchasers will be asked to produce photographic identification and proof of residence documentation once entering into negotiations for a property.

Material Information

Council Tax Band: C

Heating: Gas central heating

Services: Mains electricity, gas, water & drainage

Broadband: Ultrafast fibre available (up to 2,000mbps)

Mobile Coverage: EE: Good outdoor, variable in home | O2: Good outdoor | Three: Good outdoor and in home | Vodafone: Good outdoor

Construction: Cavity wall

Restrictions: None known

Rights & Easements: None known

Flood Risk: Surface Water - Very Low | Rivers & Sea - Very Low

Additional Charges: None

Seller's Position: Purchasing onward

Garden Facing: South West

Agents Note Sales

PLEASE NOTE - Although we have not tested any of the Gas/Electrical Fixtures & Fittings, we understand them to be in good working order, however it is up to any interested party to satisfy themselves of their condition before entering into any Legal Contract.

AML

Map



EPC Graphs

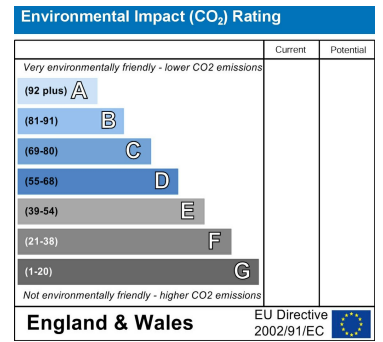
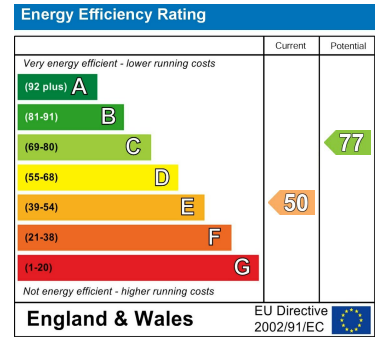

Floorplan

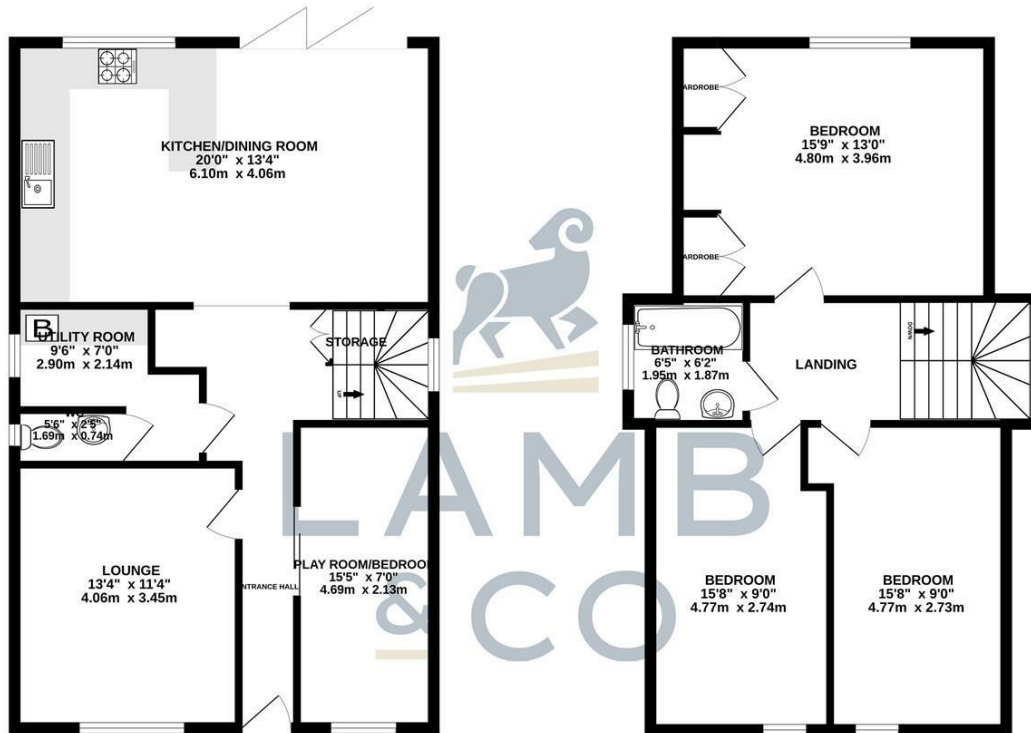

TOTAL FLOOR AREA: 1348 sq.ft. (125.3 sq.m.) approx.

Whilst every attempt has been made to ensure the accuracy of the floorplan contained here, measurements of doors, windows, rooms and any other items are approximate and no responsibility is taken for any error, omission or mis-statement. This plan is for illustrative purposes only and should be used as such by any prospective purchaser. The services, systems and appliances shown have not been tested and no guarantee as to their operability or efficiency can be given.
Made with Metropix ©2026

These particulars, whilst believed to be accurate are set out as a general outline only for guidance and do not constitute any part of an offer or contract. Intending purchasers should not rely on them as statements of representation of fact, but must satisfy themselves by inspection or otherwise as to their accuracy. No person in this firm's employment has the authority to make or give any representation or warranty in respect of the property.