



## RIVERLIGHT QUAY, SW11

£2,500 per month

One bedroom  
One bathroom  
Concierge  
Winter garden  
Open-plan  
Zone 1

@marshandparsons  
marshandparsons.co.uk

MARSH &  
PARSONS



# ABOUT THE PROPERTY

This luxurious one-bedroom, one-bathroom apartment in the highly sought-after Riverlight Quay development on Nine Elms Lane, SW11, offers an exceptional standard of contemporary riverside living in one of London's most prestigious schemes designed by Rogers Stirk Harbour + Partners. The bright and generously proportioned open-plan reception room benefits from floor-to-ceiling glazing, flooding the space with natural light and providing stunning views across the River Thames or the London skyline, with doors leading out to a private winter garden perfect for al fresco dining or simply enjoying the panorama. The sleek integrated kitchen features high-end appliances, with the spacious double bedroom, complemented by a stylish bathroom.



# STEP INSIDE RIVERLIGHT QUAY

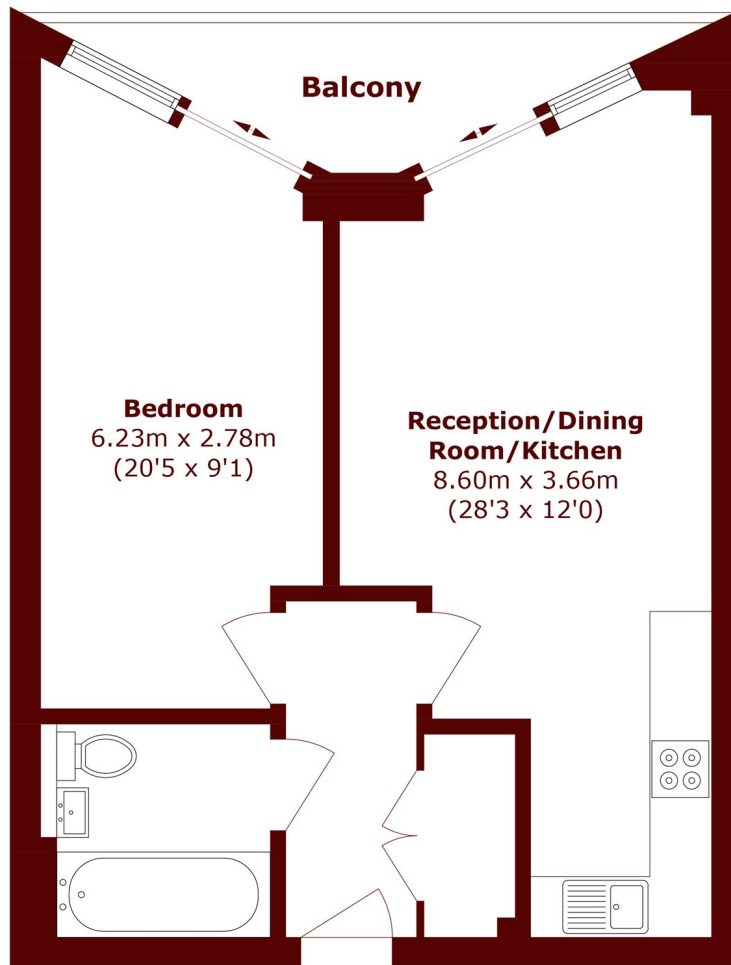

Total area (approx.): 52.0 sq. m (559.7 sq. ft)  
Balcony area (approx.): 5.8 sq. m (62.4 sq. ft)

**Kennington**  
020 7932 2920

Energy Rating: B We aim to make our particulars both accurate and reliable. However, they are not guaranteed; nor do they form part of an offer or contract. If you require clarification on any points then please contact us, especially if you're traveling some distance to view. Please note that appliances and heating systems have not been tested and therefore no warranties can be given as to their good working order

**MARSH &  
PARSONS**